

Gemstone Cabinetry, LLC

Policy and Specifications Manual 2025

Welcome to Gemstone Cabinetry. Gemstone is an aggressive brand of cabinetry that embodies the latest tastes and trends in contemporary and transitional American cabinetry designs. Gemstone Cabinetry consumers value a modern or transitional styling, highest quality finishes with broad selections, and an exceptional European, full overlay, all wood cabinet construction. Gemstone Cabinetry is truly custom tailored and manufactured to order for their unique needs and decor.

About us

Gemstone Cabinetry is a provider of custom European cabinetry for home and commercial use based in Southwest Florida. We have a heritage of nearly 40 years of continuous manufacturing of production frameless cabinetry and have supplied some of the largest names in the home building industry. Our factory is modern and automated to bring cabinetry to the market that is not only beautiful, but well made, affordable, and sustainable.

Contact Information

Administrative Office and Showroom:

(For sales, payments, general mailing and information, pickup and delivery)

Chris Buffington, Managing Partner

352.514.3543 cell

sales@gemstonecabinetry.com

1171 Sarasota Center Blvd.

Sarasota, FL 34240

Section 1 Policies and Specifications - Table of Contents

New Customers

Information Form	1
Start-up Kit	1
Display Program	1
Payment Terms	2
Sales Tax	2

Shipping

Charges and Zones	3
Packaging	4
Policies	4

Orders

Order Form	5
Item Code Tree	8
Order Procedure	10
Payment	10

Specification

Box	Construction	11
	Finished Sides	12
	Materials	12
	Drawers & Slides	13
	Hinges	14
	Metro 3D/ Volante	15
	Sizing	17
	Toe Kicks	18
Doors	Wood Doors	18
	MDF Doors	18
	Wood Veneered Doors	18
	Thermal Laminate Doors	19
	DLV Laminate Doors	19
	High Gloss Laminate Doors	19
	Door/Drawer Reveals	20
	Standard Availability of Colors	20
	Door Style Images and Details	Color Inserts
	Finish Effects	21

Modifications	23
----------------------	-----------

Samples	25
----------------	-----------

Warranty	26
-----------------	-----------

Blank Forms	27
--------------------	-----------

Section 2 Catalog Reference - Table of Contents

Base	1
Sink Base	6
Wall	8
Wall 1 Lite	12
Tall	15
Vanity Base	17
Vanity Sink Base	20
Furniture Sink Base	23
Filler	24
Panels	25
Base	25
Wall	25
Tall	26
Plywood	27
Deco Panels	28
Valances	30
Moulding	31
DLV Allure	33
Capri /Enzo Trim	33
Hood Enclosures	34
Corbels	35
Posts and Legs	35
Feet	35
Columns	36
Functional	37
Rollouts	37
Wine Racks	37
Dividers	37
Appliance Garage	37
Hood Vent Pipe Chases	37
Stemware Holders	38
Docking Drawer	38
Aventos Add	38
Floating Shelves	38
Mirror Frames	38
Options	39
Drawer Front	39
Glass Lites	39
Profiles	39

1 Gemstone Cabinetry, LLC

Policy and Specification Manual 2025

Purchasing from Gemstone Cabinetry

Gemstone Cabinetry is sold through authorized dealers as well as to qualified national accounts. Any purchasing customer is required to complete the new customer information form and purchase a sample starter kit that will aid in effectively demonstrating our product to end users and customers.

NEW CUSTOMERS

Information Form

The information form must be completed in its entirety and submitted for approval of the sales manager in order to gain “authorized dealer” status. The form is available on the website in our “dealer portal” tab on the Home Page. No dealer login or online profile is required but a password is required to access downloads. The password is provided only to dealers (or potential dealers). Dealers are notified by email of periodic updates to any downloads available on the site. The New Customer Information Form may be filled out online and submitted electronically by email, or the PDF version may be downloaded, printed and completed by hand to be emailed, presented in person, or mailed in to our office.

Sample Startup Kit

The required sample starter kit contains a Gemstone compact base cabinet sample, 15 cabinet sample doors in assorted finishes and door styles, specification manuals, and a finish chip set. The chip set represents roughly 150 of our most popular color and finish selections. The dealer cost of the sample starter kit is \$699. Literature and other printed sales aids will also be included and replenished at no cost. Additional sample doors may be obtained as needed at \$45/each. Please use *Literature/Sample Order Form* to request any samples needed. (6 additional sample doors may be substituted for compact sample base cabinet if desired). Additionally, 6 free sample doors may be provided on demand at no cost each year to help dealers build their sample library. Finishes that are not included in the sample set may be requested at a cost of \$4 each. Between wood selections, stain or paint selections, glazing choices, and effects, there are thousands of finish combinations available, so it is impractical to have available every finish in the sample set. We believe that the sample chip set well represents the latest in what cabinet buying customers are currently looking for, making Gemstone an easy choice among consumers.

Display Policy

Dealers are encouraged to place full working displays in their showrooms that will best convey the essence of the latest in European kitchens from Gemstone Cabinetry. Discounted display cabinets are available for this purpose. Submit your design for approval to receive a 40% discount. Final costs are based exclusive of shipping and taxes.

Display program is only available for showrooms. Builder models will not qualify as showrooms, but considerations or proportional concessions may be made on a case-by-case basis.

2 Gemstone Cabinetry, LLC

Policy and Specification Manual 2025

Payment Terms

Payment terms for all dealers are assumed to be 50% payment accompanying any order when placed, followed by the balance due upon delivery of the product. Orders may not be scheduled for production until accompanying initial payment has been arranged. Payments may be made by ACH by following the link and prompts in invoice emails and this method of payment is preferred. However, company check, credit card, or Paypal payments are accepted. Credit card payments carry a 3% convenience fee. Contact will be made by our customer service team on the day prior to delivery for confirmation of payment availability for the following day's scheduled delivery. If confirmation cannot be obtained for the delivery, shipment may be delayed until the next scheduled truck for your area.

Under certain circumstances, we may send a "Notice to Owner of Intent to Lien" as extra security for payment terms for large projects or non-standard payment terms. A NTO form will be provided and completed in advance by customers so all pertinent information is on file for the project. Dealer cooperation is expected to enable products to flow smoothly to the job without delays.

Gemstone Cabinetry reserves the right to alter these standard terms for any dealer on a case-by-case basis to determine the best fit for each customer. It is our goal to have a workable arrangement with all of our dealers that will be best suited for successful problem-free transactions.

Sales Tax

Please indicate on the Customer Information Form your sales tax exemption status. If tax exempt, a sales tax exemption certificate must be provided. Without exception, we are required to collect Florida sales tax when delivering within Florida unless the certificate is provided. Tax rates are determined by delivery destination county local rates. Out of state sales taxes are governed by the local tax laws and it is the responsibility of the customer to comply with their state tax laws.

3 Gemstone Cabinetry, LLC

Policy and Specification Manual 2025

SHIPPING

Shipping Charges and Zones

Delivery of Gemstone Cabinetry products is made with our own truck, common carrier, or may be picked up by customers at the factory. RTA orders and shipments outside of Florida will be shipped by common carrier and will be billed freight collect. Pallet shipments incur an additional packaging charge of \$65 per pallet. Please note a preferred common carrier on your order if desired and we will accommodate your needs.

Shipments made using Gemstone Cabinetry trucks will be scheduled on a “when cabinets are completed” basis. Shipping charges are assessed on a “per cabinet” basis. Please consult the diagram or the Excel Estimating and Ordering Form for shipping charges. Minimum shipment values are calculated by our delivery policy to each zone, but common carrier may be utilized in some instances for the most timely, cost effective and reliable delivery.



4 Gemstone Cabinetry, LLC

Policy and Specification Manual 2025

Packaging for Shipment

Cabinets are packaged using stretch wrap with foam sheet protective barriers where needed to protect finished surfaces. All products are labelled for easy identification and placement of cabinets at the job. Receivers outside our delivery area will be charged shipping by custom quote and may opt for RTA shipment.

RTA shipments are palletized where parts are nested for the most efficient use of space to ensure safe transport without damage. Parts are not necessarily nested together by cabinet but are labelled for identification. When receiving an RTA shipment, it is best to unpack the entire pallet before beginning the assembly process. Please notify us of any missing or damaged parts discovered and we will expedite replacement parts within 1-3 days. Replacement parts will be shipped UPS without shipping charges.

Delivery Policies

All deliveries are made to warehouse locations unless arrangements are made with our shipping department. Additional cost of \$250 is assessed for special shipping arrangements such as residential or jobsite deliveries (Please choose "YES" from the drop down next to "Jobsite Delivery" in the shipping information of the Order Form for this option and provide a valid delivery address).

Note: Due to insurance restrictions, under no circumstances are our drivers permitted to carry products onto job sites or into buildings. They are limited to handing product off at the tailgate of the delivery truck. Adequate unloading and product placement personnel are the responsibility of the customer. If no one is present to receive delivery, we may return to the factory and reschedule delivery on another date mutually agreed upon. Additional delivery charges will be assessed.

ORDERS

Excel Order Form

Gemstone Cabinetry provides dealers with a job estimate generating worksheet (**Order Form**) that calculates pricing automatically. The worksheet is available by download on the website or can be emailed to the customer. The estimate generating worksheet is a Microsoft Excel worksheet that can be used by anyone with Excel 2007 or newer version (or Office 2007 which includes Excel 2007).

The estimate generator is designed to create easy and timely estimates for customers by dealers. The form utilizes drop down lists to populate from available selections and makes its calculations in a dynamic form that can be altered by revising selections at any point.

Begin your estimate by filling in the upper **header** section of the form with your customer and job identifying information. The pricing displayed is net, after multipliers and adjustments. Sales tax is automatically calculated based on the sales tax county selected from a dropdown list in the heading section. Likewise, shipping charges are automatically calculated by selecting the delivery county from the dropdown list in the shipping area in the heading section. A sales tax county and delivery county must be selected to provide job totals at the bottom. We recommend filling in your customer information and then saving as a template for future estimates to save time without having to fill in the same information each time.

The first cell on the left below the Gemstone Logo is labeled “Total # Sheets”. The drop down allows a selection of up to 9 separate forms for use in the same job. When activated by selecting the number of forms, additional forms are generated automatically and reveal page tabs along the

bottom margin of the form. This feature provides for differences in selection of material, door style and finish color, or room designations to be isolated on each form for organization or ordering purposes.

6 Gemstone Cabinetry, LLC

Policy and Specification Manual 2025

11/19/18	JOB NAME		ROOM
3543	CABINET SERIES	Metro Armadi White	
binetry.com	DRAWER TYPE	Wood Dovetail	
	SLIDE TYPE	FX Soft Close	
	DOOR DESIGN	WShaker_SC	DR FRONT Matching
	FRAME WIDTH	STD	
	FRAME DETAIL	STD	
	PANEL DETAIL	STD	
	EDGE DETAIL	STD	
	MATERIAL	WHybrid_SC	
	FINISH	WHITE_SC	
	COLOR	White	
	EFFECT 1	None	
Custom Dimensions		Custom Add	
Width	Height	Depth	%List \$List QTY Net Cost

The grey and white areas of the top header section is used to designate the job/room specifications for “Job Name”, “Room Name”, “Cabinet Box Material”, “Drawer Box”, “Drawer Slide”, “Door Style”, “Door Details”, “Material”, Etc. Please make sure selections are made in each box to ensure the form properly calculates the pricing. Please begin at the top and make selections moving down. By working in order, the available selections are set by selection made in the previous cell, so it is important to go in order from top to bottom. Door style reference images are available to the right of the comment area by resting the mouse pointer on a door style name.

The list of required cabinets and items are then populated by use of dropdown lists that sort and make selection easy and reliable. Some items are not available depending on a door style or finish selected in the heading section. For example, if a melamine laminate finished door has been selected, corbels and millwork items or mullion glass door cabinets would not be available as they would have been if a solid wood finished door was selected. Please keep this in mind if you find that the item you need does not appear for selection.

Please refer to the following item tree on pages 8-9 which diagrams the categories and lists to familiarize yourself with where to find certain items. Make selections in order working left to right through the lists for Cabinet Type, Door and Drawer configuration, and Cabinet Size. A price will then be displayed to the right.

Jobsite Delivery Yes		PO#	
Cabinet Type	Doors & Drawers	Cabinet Size	Finish Ends
1 Base	2D/1Dr	30W 34.5H 24D	662 Left
2			
3			
4			

Matching finished ends (and wall bottoms) may be designated in the next cell moving right and the cost is again recalculated. Cabinets are catalogued in 3” incremented sizes from 9”-48” in width, and 3” or 6” increments in height. Sizes may be customized by simply specifying the next largest catalog size of the size needed and then editing the custom dimensions downward to the required dimension. If no edits are made, the size manufactured will be the size listed in the “Cabinet Size” column, so if no customization is needed, you don’t have to fill in any sizes.

Finish Ends		Custom Dimensions		Custom	
		Width	Height	Depth	%List
Left		29			

Gemstone is a custom manufactured-to-order product line, and we pride ourselves on our ability to meet unique and special requirements of our customers. Our automatic pricing takes most customizations into account and charges are self-generating and user friendly. However, certain customizations require additional charges that are to be listed as items in the quote. These items are detailed in the “Modifications” section. On some occasions, special consideration is given to customizations required that have no previously formulated customization charge (due to the unique nature of the request.) Contact customer service in these unique situations where we can determine the appropriate cost of a customization charge by either an additional percentage or flat rate charge or even a combination of both. The percentage or flat rate charge can be manually applied in the two “custom add” columns following custom dimensions columns.

7 Gemstone Cabinetry, LLC

Policy and Specification Manual 2025

Any additional non- catalog parts that are needed should be entered in the “Special Parts” area designated. Finally, any notations of special handling or other customizations should be provided in the “Line Item Instructions” areas in the right column next to each item.

42									
43									
44	Special Parts	Description:	Pt.#:	Vendor:	Qty	Del. Cost @:			
45		Custom Paint Option Formulation Charge		PRISM	1	200			N/A
46		Special Notes (refer to line item # for special instructions):							
		Total Sheet(excludes tax & shipping)							\$302.95

If you have additional rooms or items of

different specifications, they may be filled in and priced on the additional forms where tabs are visible across the bottom of the screen based on your selection in the “# of sheets” cell previously described. On the first page, the

Special instructions:		Total kitchen Sheet(excludes tax & shipping)		\$302.95
Zone 1	1	Subtotal (for 5 Sheets)		\$ 302.95
	7.00	Sales Tax	7.00%	\$ 29.61
	7.00	Shipping		\$ 120.00
		Total Cost		\$452.56
HARDWARE TOTALS DOORS 2 DRAWERS 1				

first subtotal line is for the current form only, followed by the subtotals for all sheets combined in the next cell below. Each of the additional pages are subtotaled individually without tax and shipping. Tax and shipping are calculated on the total

value and total cabinet quantity from all forms and appear on the first page only.

Although Gemstone does not provide decorative hardware, a “Hardware Counter” appears at the bottom of each sheet for your convenience. Additional pieces must be considered for tilt sink fronts, or fronts with more than one handle, etc.

8 Gemstone Cabinetry, LLC

Policy and Specification Manual 2025

Base	Sink Base	Wall	Wall 1/L	Tail	Vanity Base	Vanity Sink	Fillers	Base Panels	Tail Panels	Wall Panels	Plywood	Deco Panels	Valances	Crown	Trim
1DR	1DR	1060R	1060R	2013R	1DR	1DR	F3	BEP3/4 IS	REP3/4 IS	WEP3/4 IS	3/4 TOE	DGP	Classic	1524	Base M
1DL	1DL	1060L	1060L	2013L	1DL	1DL	F6	BEP3/4 ZS	REP3/4 ZS	WEP3/4 ZS	1/4 TOE	DBPMT	Elegant	2224	Base 10
2D	2D	1048R	1048R	2016R	2D	2D	F8	BEP3/4 UNF	REP3/4 ZS	WEP3/4 ZS	3/4 Ply Finish IS	DWP	Roman	2225	Base 381
10S8PO	10/1FR	1048L	1048L	2016L	10/1DR	20/1Dr Rev	OF3	BEP	REP	WEP	3/4 Ply Finish 2S	DTP	Trad	1128H	LR 280
10/1DR	10/1FL	1042R	1042R	2021R	10/1DL	10/1FL	OF6				1/4PLY	DWGP	Straight	2578 Rzer	LR B11
10/1DL	20/1F	1042L	1042L	2021L	10/1DR	10/1FL	OF8				1/4PLY Beaded	Appliance	Ro-A	33	LR 361
20/1DR	20/Apron	1036R	1036R	2024R	20/2Dr	10/2DrIFR					Veneer			6	Cove 11
20/2Dr	2Dr	1036L	1036L	2024L	3Dr	10/2DrIFL								24	OC 12
1Drawer	2DrIF	1036R	1036R	4013	File 2Dr	20/2DrIF								619	Bar 13
2Dr		1036L	1036L	4016	File 3Dr	20/2DrIF								801H	Scr 14
3Dr		1036R	1036R	4021	Knee Dr	20/2DrIF								1238	Scr 1809
CT3		1036L	1036L	4024	Wall Hung 1DR	20/2DrIF								1550	Scr 2316
CT4		1036R	1036R	SOC	Wall Hung 1DL	2Dr								1621	Scr 2317
BC-10BLR		1016R	1016R	DOC	Wall Hung 1DL	Wall Hung 1DR								1622	Shoe 583
BC-10BL		1016L	1016L	DOC	Wall Hung 2D	Wall Hung 1DL								1623	Cap 860
BC-10/10BLR		1018L	1018L	40MW	Wall Hung 10/1DR	Wall Hung 1DL								342	
BC-10/10BL		2060	2060	OPEN	Wall Hung 10/1DL	Wall Hung 2D								343	
C48LZR		1015L	2048		Wall Hung 2D1Dr	Wall Hung 10/1FR								344	
C48L		1012R	2042		Wall Hung 2D2Dr	Wall Hung 10/1FL								810H	
C48LZL		1012L	2039		Wall Hung 2D2Dr	Wall Hung 20/1F								470 Plate	
C90LZR		2060	2036		Wall Hung 2Dr	Wall Hung 2Dr								384 Plate	
C48SR		2048	2030		Wall Hung 3Dr	Wall Hung 10/2DrIFR									
C48SL		2042	2027			Wall Hung 10/2DrIFL									
C48SR		2038	2024			Wall Hung 20/2DrIF									
C90SR		2036	2021			Fum 1Dr									
10/1DR-ROR		2030	2018			Fum 2Dr									
10/1DR-ROL		2027	2015												
20/1DR-RO		2024	2012												
20/2DR-RO		2021	C4SR												
1D-TRO		2018	C4SL												
1D-TRO		2015	C90R												
MC-2D		2012	C90L												
MC-1Dr		C4SR	BC-10BLR												
Aend		C4SLR	BC-10BL												
AE/2D		C4SL	BC-20BLR												
AE/1DR		C4SL	BC-20BL												
AE/1DL		C90R	10/1DR												
Knee Dr		C90L	10/1DL												
OPEN		BC-10BLR	10/2DR												
		BC-10BL	10/2DL												
		BC-20BLR	20/1Dr												
		BC-20BL	20/2Dr												
		10/1DR	AEend1DR												
		10/1DL	AEend1DL												
		10/2DR	MWS-2D												
		10/2DL	MWS-2D												
		20/1DR	TT-2D												
		20/2Dr	10HK												
		AEend	10HKS												
		AEend1DR	1DHL												
		AEend1DL	10HF												
		MWS-2D													
		MWS-2D													
		TT-2D													
		MED													
		10HK													
		10HKS													
		1DHL													
		20HF													
		2D TowerR													
		2D TowerL													
		2D PO TowerR													
		2D PO TowerL													
		OPEN													

9 Gemstone Cabinetry, LLC

Policy and Specification Manual 2025

Hoods	Corbels	Posts&Legs	Feet	Dr/Dwr Opt.	Functional	Mir/Frames	Floating Shelves	Allure Trim	Capri/Enzo Trim	Finishes	Modifications	12" Mouldings	Accessories	Samples
Artisan	Chandler	2 Solid Taper	Corbelt	Arched Top	Rollout	Mir FrameC30H	24	Base	Base	Stain	Angled Rear Clip Mod	Crown6	Revealshelf Pullouts	Sample Door
Euro	Cameron	Berley	Hobart Square	Special Lite	Tray Div	Mir FrameC36H	30	Cove Crown w/ Heel	Light Rail	Gaze	Pipe Chase Drawer Mod	Crown24	Revealshelf Drawers	Color Chip
BX	Concord	Dunkirk		Split Panel	Vertical Aluminum	Mir FrameC42H	36	Light Rail w/ Heel	Top Trim	Paint	Partial Fin Interior Mod	Crown33	Revealshelf Corners	Sample Cabinet
BUB		Mission Plain		4 Lite Mullion	Vertical Partition	Mir FrameC48H	42	Scribe	Scribe	Touch up kit	Recessed TK End	Crown342	Revealshelf Base	
CHW				6 Lite Mullion	Horizontal Partition	Mir FrameC60H	48	Shaker Crown w/ Heel			Double Entry	Crown343	Revealshelf Wall	
CHWB				8 Lite Mullion	Additional Shelf	Mir FrameC72H	60	Traditional Crown				Crown344	Hardware Resources	
Marble S				10 Lite Mullion	Wine Rack	Mir FrameF30H		SM Light Rail				Crown619		
					App Gar CAS	Mir FrameF36H		SM Scribe				Crown801H		
					Semaphore	Mir FrameF42H						CrownB10H		
					Hood chase IN	Mir FrameF48H						Crown1238		
					Hood chase FIN	Mir FrameF60H						Crown2205		
					Docking Outlet	Mir FrameF72H						Crown1524		
					Insert DrawerDF							LR B11		
					Add AVENTOS LIT							LR 361		
					Add TIPON							Base 10		
					Leg Levelers							Base 381		
												Scr 14		
												Base M		

10 Gemstone Cabinetry, LLC

Policy and Specification Manual 2025

Order Procedure

Although products are manufactured using the data provided on the order form, drawings of special modifications and room layouts are welcome as accompanying documentation. Please remember though that contents of a confirmed and signed order is what will be produced, so be sure that your confirmation is correct and clear before signing and releasing to production. Once your job is finalized, submit your order. All orders must be placed in writing and verbal orders (and texts) will not be accepted. Gemstone has no capability to receive orders by fax. The preferred method for placing orders will be by email. Liability for errors in order placement will ultimately be the customer's responsibility. We confirm receipt of the order and final audit of pricing and accuracy will take place before confirming to the customer. This ensures accuracy and corrects errors that can occur. Confirmations will be sent by email. Please acknowledge the confirmation by signing off and returning by response to email. Any changes made to a confirmed order beyond 3 working days past sign off may incur charges. It is imperative that orders be submitted on the most current Excel Order Form. Use of outdated order form versions should be avoided and will not be accepted for orders. Gemstone does not provide quotes from drawings provided. It is the responsibility of the dealer to do their own take-off from their drawings.

Payment

Payment for 50% of the confirmed amount should be received within 3 business days to avoid a shipping date delay. Orders will be confirmed within 24 hours, so if your confirmation has not come back to you as expected, please notify us to prevent communication errors or resulting delays.

Payments may be made by check, ACH, or credit card. Invoicing is transmitted by email. A link is provided in the email that allows for payment by Credit Card or ACH bank transfer. All email job invoices default to ACH payment method. If a credit card is desired for payment, please let us know. A 3% convenience fee will be added for credit card transactions.

Product Specifications

Box Construction

Gemstone Cabinetry is manufactured in Florida in a modern factory utilizing CNC equipment and other digital production enhancements. Cabinets are full overlay, frameless, full access design. By not using face frames on the front of our cabinets, the openings are larger and unrestricted.

This allows for maximization of storage space and easier access.

Frameless style construction also demands precision in the manufacturing process and more robust materials. Tight fitting precision machined parts and thicker, heavier materials means high quality, longevity, and durability are engineered into every Gemstone Cabinet.

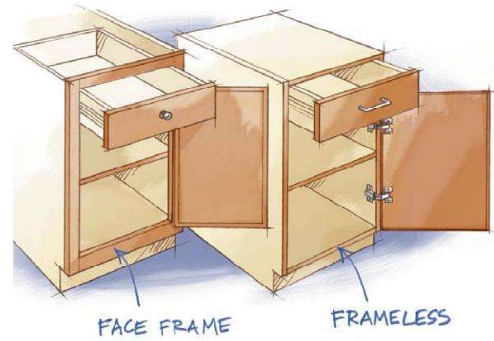

Case Design

Gemstone Cabinetry features full overlay fronts on a frameless, European style cabinet box, with traditional American stretchers, hanging rails, and notched toe kicks. Cabinets may be produced without toe kicks by request for use with leg levelers or ladder type toe kick platforms. Gemstone offers adjustable leg levelers but does not supply ladder toe kicks.

Components

Frameless design cabinetry is largely panel based, rather than solid hardwood. The use of plywood and other panel or sheet products is efficient, cost effective and strong. Surfaces are smooth, easy to keep clean and stand up to rigorous use for many years. All cabinet joinery features compression dowel construction. Backs are captured in a dado with hanging rails located behind the recessed back offering clean, uncluttered interiors. All hardware is mounted into predrilled holes providing precise, efficient placement onto components prior to case assembly. Proper placement and alignment of hardware components assures smooth operation of drawers and doors with less wear and tear, extending their life for generations.

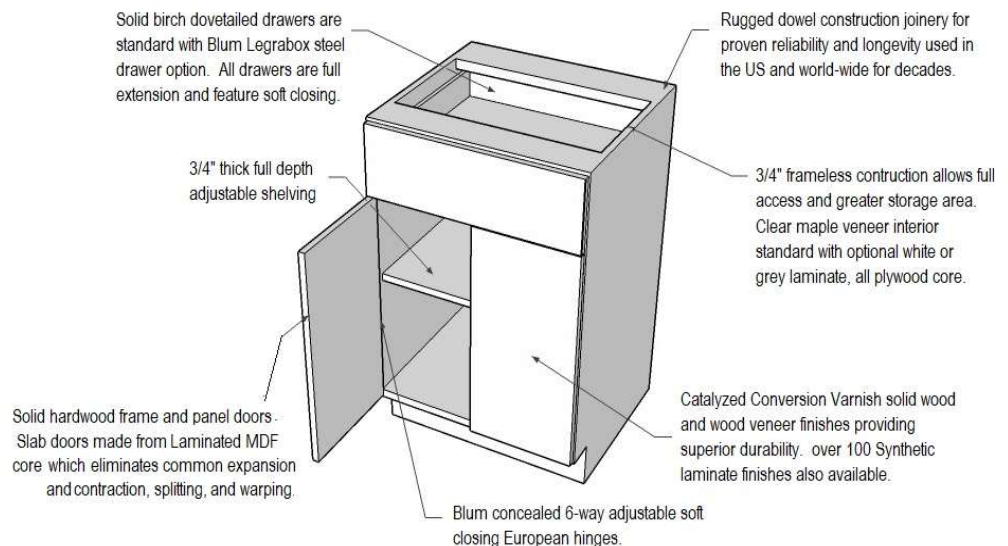

12 Gemstone Cabinetry, LLC

Policy and Specification Manual 2025

Front edges of cabinet boxes are finished with durable PVC to match the outside finish of the cabinet. Edgebanding is machine applied and is flush trimmed and buffed to smooth finish.

Finished sides and wall bottoms

Bottoms of wall cabinets, while finished, are not considered “finished wall bottoms”. The finish is that of the cabinet interior. Matching finished wall bottoms can be obtained by selecting this option when selecting finished sides on each applicable item in the estimate generator. Outside faces of cabinet sides are finished to match the interior of the cabinet. Where an exposed matching finished side is required, make the appropriate selection on the estimate generator. Finished sides and wall bottoms are matching type, specie and finish to the door finish selected.

Open cabinets automatically receive an interior finish to match the specified exterior finish as do all glass door cabinets.

Materials

All cabinet sides, tops, bottoms, shelves, and rails are made from $\frac{3}{4}$ ” plywood while backs are $\frac{1}{4}$ ” plywood.

Plywood panels have been used in cabinet construction for many years. Plywood is made by stacking thin wood veneers and pressing together with adhesives and high pressure to form a rigid panel. The direction of the veneer layers alternates at right angles to each other and when bonded all together they form an exceptionally strong and stable panel. Plywood is generally considered superior to particle board. There is no inferior



Chinese plywood in our cabinetry that can compromise the indoor air quality of your home. Interiors are light and bright and uniform in appearance making stored items easier to see and locate



grain

Chinese plywood in our cabinetry that can compromise the indoor air quality of your home. Interiors are light and bright and uniform in appearance making stored items easier to see and locate

Gemstone cabinetry is manufactured with a choice of 2 interior materials, all $\frac{3}{4}$ ” plywood core construction:

Gemstone Maple – UV cured natural finished, US produced maple veneered plywood

Gemstone White – White cabinet liner High Pressure Laminate on plywood

Shelves

All shelves are $\frac{3}{4}$ ” thick, full depth, and are fully adjustable for versatile and effective storage. Shelf support pins are steel and are placed into predrilled holes for precise location. Shelves are wrapped separately for delivery so please keep track of them until installation is completed and shelves are placed inside cabinets. Gemstone is not responsible for lost shelves after delivery unless noted on the packing list when received.

13 Gemstone Cabinetry, LLC

Policy and Specification Manual 2025

Drawers

Gemstone Cabinetry is on the cutting edge of cabinet hardware technology and features. Drawers and roll out trays feature full extension travel with soft closing system as standard. All drawer runners are concealed from view under the drawer box. Full extension travel means no more lost items in the rear of the drawer. Soft closing mechanisms eliminate unnecessary noise and shifting contents. We offer two different systems for drawers:

Solid wood drawers are manufactured using 5/8" solid birch hardwood sides, fronts, and backs with 1/4" plywood bottoms and feature dovetailed construction. Dovetails are commonly associated with traditional wood joinery that dates back hundreds of years. Our use of dovetails pays homage to the longevity and superiority of this method of joining solid wood pieces. Dovetail joints provide strength and durability while allowing the wood to expand and contract when necessary, keeping the joint tight and solid. Dovetailed drawer boxes feature Genuine BLUM Tandem full extension slides - the gold standard in soft closing runner systems with a lifetime guarantee.



Double-wall metal is state-of-the-art European drawer box system that features double-wall metal drawer box sides with matching 5/8" melamine laminated bottom and back. The look is clean and very modern while the motion is smooth, silent and soft-closing. There are matching storage accessories available to complete the system.



Optional Tipon™ features motion technology for drawers and doors. Tipon is a press and release action that allows cabinets to be installed and used without handles or knobs. Tipon uses a spring action tipping the fronts open so the edge can be gripped and pulled open manually.

JOB NAME	NEW OFFICE	ROOM
CABINET SERIES	Gemstone Pine	
DRAWER TYPE	Legrabox_Gray	
SLIDE TYPE	Legrabox_Tipon	
DOOR DESIGN	Mera	DR FRONT Slab
FRAME WIDTH	STD	
FRAME DETAIL	STD	
PANEL DETAIL	STD	
EDGE DETAIL	STD	
MATERIAL	Studio	
FINISH	Studio_Horiz	

Tipon touch release drawers are specified in the "drawer slide" selector. Option pricing for these occurs automatically when selected. Tipon customers can now enjoy both spring tension opening and soft closing features in one slide mechanism.

14 Gemstone Cabinetry, LLC

Policy and Specification Manual 2025

10	VanityBase	3Dr	21W 30.75H 21D	725	19.5	29.25	17			482.37	FLUSH TOE KICK; 2 - 6" DRAWERS; 1 12-1/4" FILE BELOW
11	VanitySink	1DR	24W 30.75H 21D	259		29.25	17			93.24	FLUSH TOE KICK; TIPON DOOR RELEASE
12	Functional	Add TIPON	Door	40					1	14.40	LINE 11

Tipon for doors must be added to the order as an item

like any other accessory utilizing the item library drop downs, then quantifying the number of doors affected. Similarly, Tipon for Aventos lift doors must be added the same way. Tipon spring tension touch latches require actively pushing doors closed to “reload” the spring mechanism for the next activation. Therefore, soft closing doors along with Tipon is not an option.

Hinges

Hinges provide a 110d opening featuring soft close action. Naturally, hinges are concealed and have 6-way adjustment built in so uniform spacing and alignment of doors is easily achieved and maintained for a true full-overlay look. Gaps between our front panels are just 1/8” requiring precision adjustments of the hinges to bring doors and drawers into perfect alignment.

15 Gemstone Cabinetry, LLC

Policy and Specification Manual 2025

Volante Series cabinet boxes

Gemstone Volante Series features the integration of horizontal and vertical recessed aluminum profiles that allow for finger pull fronts without handles that are usually necessary with frameless style cabinets.



Cabinet sides are pre-milled at the factory to accept Volante extruded aluminum profile mouldings. Volante aluminum is ordered separately in lengths of up to 173", and is installed the same way toe kick covers or other mouldings are ordered for field fitment and placement during cabinet installation. Moulding profiles and application of Volante concept is detailed in the following illustrations:

16 Gemstone Cabinetry, LLC

Policy and Specification Manual 2025

Volante Aluminum Design Concept

Bases

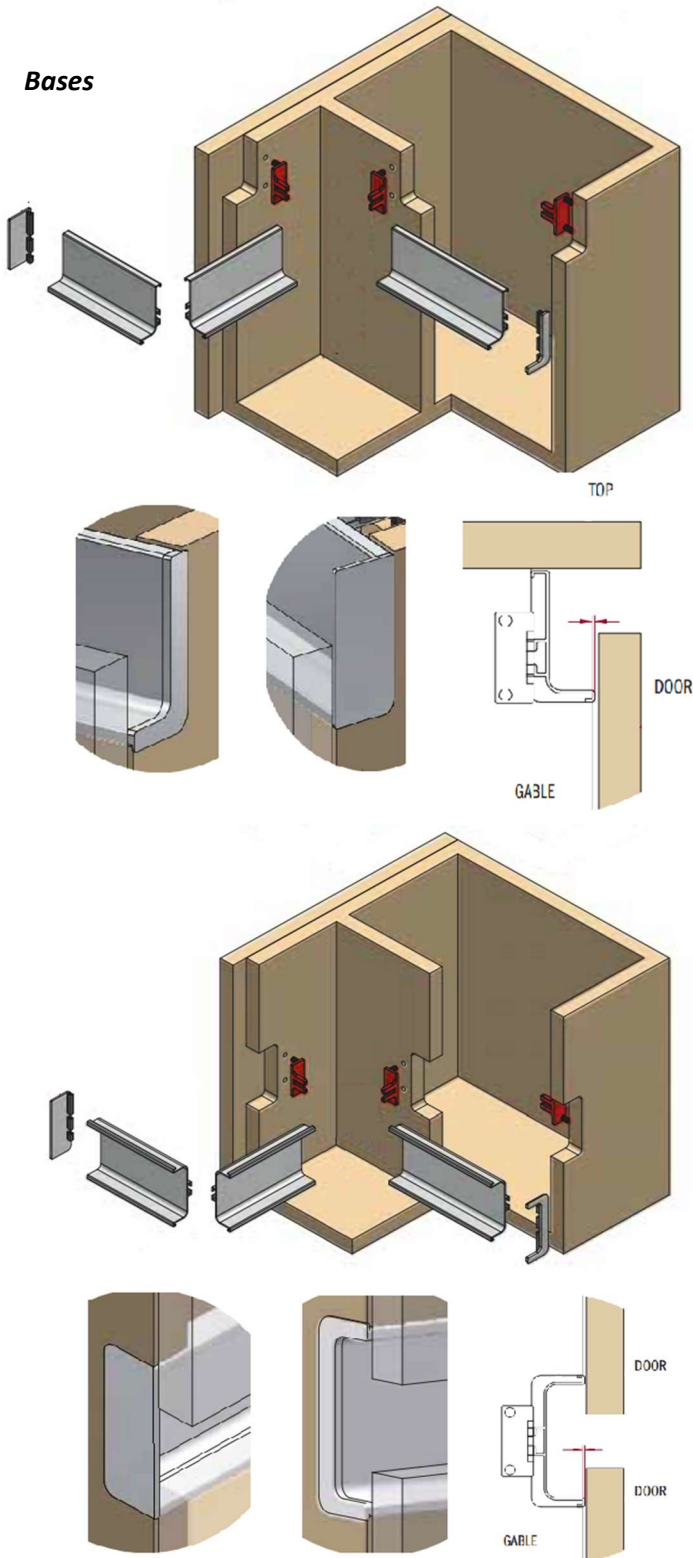

Walls

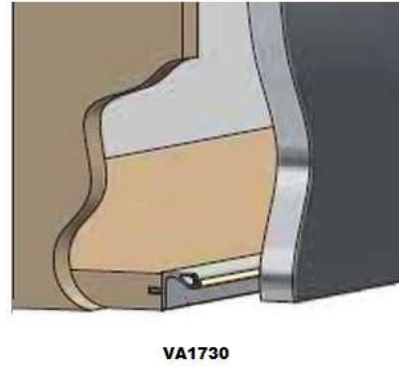

VA1730

Talls

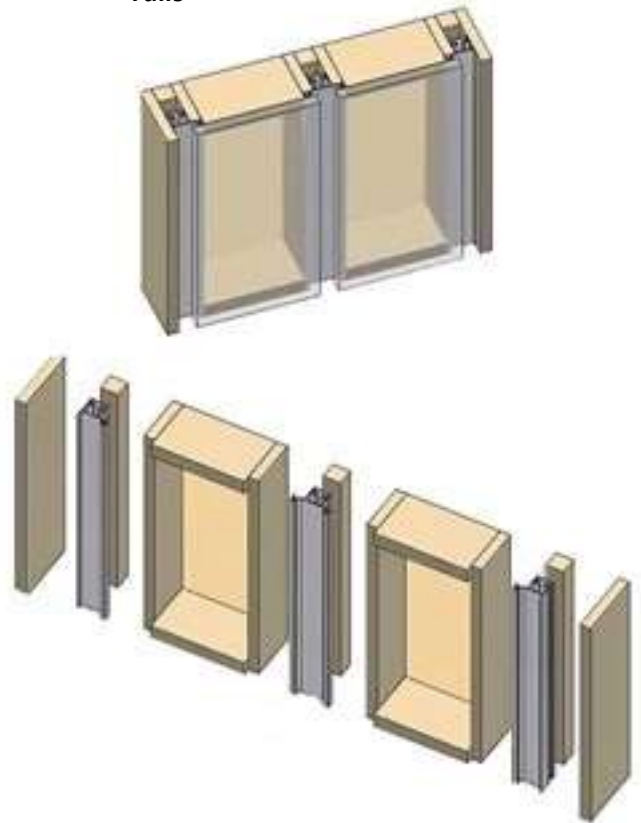

17 Gemstone Cabinetry, LLC

Policy and Specification Manual 2025

Sizing

Gemstone Cabinetry is manufactured to order and can be custom sized to fit specific needs. Standard sizing is as follows, but if you don't find the size you need in the library please consult with us. Typically, when a custom dimension is required, please select the cabinet with the next larger dimension, then fill in the custom size in the appropriate field on the order form. Widths cannot be increased beyond their catalog dimension; however, heights and depths are able to be increased beyond standard. A corresponding charge is calculated by the form and will automatically be applied when these instances occur.

<i>Type</i>	<i>Width</i>	<i>Height</i>	<i>Depth</i>
<i>Bases</i>	<i>3" increment; 9-48" typical</i>	<i>34.5"</i>	<i>24"</i>
<i>Walls</i>	<i>3" increment; 9-48" typical</i>	<i>3" increment; 12-60"</i>	<i>13",24"</i>
<i>Aventos Walls</i>	<i>3" increment; 24-48" typical</i>	<i>3" increment; 12-42"</i>	<i>13"</i>
<i>Talls</i>	<i>3" increment; 12-36" typical</i>	<i>6" increment; 84-120"</i>	<i>13",16",21",24"</i>
<i>Vanities</i>	<i>3" increment; 9-48" typical</i>	<i>30.75", 34.5"</i>	<i>21"</i>
<i>Wall Hung Vanities</i>	<i>3" increment; 9-48" typical</i>	<i>24"</i>	<i>21"</i>

Note: Cabinets with single width drawers are limited to 39" in width.

Note: Due to panel size limitations, Gemstone White tall cabinets and panels may be slightly shorter in height (95.75").

Toe Kicks

Toe kick dimensions are 4.5" high x 3" deep. "No toe kick recess" may be specified by noting "FLUSH TOE KICK" in the special instruction. No toe kick (toe kicks removed) may also be requested. There is no charge for these options but please keep in mind that Gemstone has available leveling legs but does not provide separate toe kicks (ladder toe kicks).

Recessed toe kick ends can also be requested. To do so, please note in the line notes to recess left, right, or both and provide the recess dimension. In addition, please add a charge line item from the Modifications category and enter the quantity of recessed toe kick ends required (this can just be a total number).

18 Gemstone Cabinetry, LLC

Policy and Specification Manual 2025

Doors

Gemstone Cabinetry doors, drawer fronts, millwork and accessory items are made from high grade domestic hardwoods and a variety of laminated products to suit a wide variety of tastes and budgets.



Solid Hardwood Doors

Wood frame and panel doors are offered in unique door styles to match the needs and tastes of a wide variety of customers. In addition, we may be able to replicate a special door request when competing with other cabinet lines. Many wood door styles can be specified with modified shapes and attributes creating a fully customizable product. Wood doors are available in Maple, Cherry, Alder, rift White Oak, and Walnut. Framing width can also be specified from 2-1/4 – 4” on many solid wood doors. Modified framing width carries

a small charge that is automatically applied when a non-standard width for a particular door style is selected on the header of the order form. Please refer to the door style illustrations and details for specific availability of options.

MDF Doors

Painted doors (Paint Grade) will feature a hard maple frame with a 1-piece MDF center panel for superior finish, longevity and stability, eliminating finish checking that can occur with painted solid wood panels. Some door styles are also available in popular all MDF framing and panel when using painted finishes. Our double-refined, high grade MDF represents superior quality as a material naturally suited for painted finishes in our coastal climate. Please refer to the door style illustrations for specific information about each door and corresponding available materials.

In addition, Gemstone offers 1-piece painted MDF doors in shaker style (Palmetto) and slab styles (Verona).

Hardwood Veneer Doors

Gemstone continues to respond to market demands for simple, modern, slab wood veneer door styles with our new Milano Pura Vita veneer door line. Our Milano slab door features hardwood veneer wood faces that are factory finished in a curated selection of on trend colors and grains. Outstanding color and grain consistency are achieved by utilizing factory pre-finished full panels that are processed into doors and parts.

Thermal Laminated Doors

As a response to ever increasing costs and questionable sustainability of solid hardwood cabinet doors, Gemstone has featured a full line of wood grained and patterned textured thermal laminate doors. Advances in manufacturing technology have enabled us to create alternative finish laminate doors that are so realistic that it is difficult to distinguish them from real wood doors, while keeping the cost lower and reducing the environmental impact of our industry. Textured thermal laminate doors have met with great success as contemporary European styling and rustic reclaimed wood finishes have demonstrated their popularity in the market. Building on that success, Gemstone has revised our finish selection of thermal laminate doors in our new Impression Series, designed to usher in the next generation of thermal laminated doors that look better than the real thing. Available in slab (Impression), shaker Impression Nova) and slim shaker (Impression Terrace) door styles, these high-end laminate finishes achieve consistent color and grain throughout all parts in a cabinet, which has become increasingly challenging when using real wood doors.

Decorative Laminate Veneer (DLV) Doors

Innovations in the development of alternative material for cabinet doors has led to growing public interest in laminated MDF doors. These doors begin as MDF strips that are shaped to form framing stock, then wrapped with a flexible, durable, decorative laminate surfacing material (DLV). Doors are then constructed combining this framing material with matching ¼" center panel material. The result is an astonishingly handsome collection of door selections that are very durable, color and grain consistent, and economically priced. Once the doors are assembled, there is no further finishing required which also speeds lead times along. Finished ends are provided using matching laminate material saving time and money when compared with traditionally finished stained or painted cabinets. DLV doors are a cost-effective alternative to finished wood doors and can easily be substituted where durability and easy maintenance are key factors.

High Gloss and Supermatte Laminate Doors

Gemstone Cabinetry was originally conceived as Metro 3D Cabinetry, to offer modern styled European cabinetry to our dealer base. Polished high gloss finishes are very widely used within this styling genre but formerly were limited to hand polished, multi-step, labor intensive polyester-based finishes. High gloss laminates and coatings as well as edge banding technology have been developed that now provide the same mirror-like surface without the high cost of hand finishing. A new and emerging design trend in Europe and now in North America is Supermatte laminate. These finishes offer silky smooth-to-the-touch surfaces with virtually no reflection at all. Gemstone has launched Reflex - our new offering of high gloss and supermatte laminate selections to include the latest solid colors, woodgrains and patterns.

Note: Matching high gloss and supermatte laminates for finished ends and wall bottoms, finished interiors, etc. are limited in their availability. Selection of these finishes may require the incorporation of deco panels to be applied at installation to cover exposed surfaces, or alternate coordinating materials to be used in manufacturing where required.

20 Gemstone Cabinetry, LLC

Policy and Specification Manual 2025

Standard Door and Drawer Front Reveals

Base and vanity –3/16” top, 1/16” bottom and both sides

Wall and tall – 1/16” top, bottom and sides

All front panel spacing between doors and drawer fronts is 1/8”

Standard Availability of Colors

CWS Paints	CWS Stains	Reflex High Gloss	Mera Studio High Gloss	Allure DLV
Antique White	Charcoal	Antracita 611	Polar White 240	White Dove
Artic White	Colonial	Black 610	Grey Skies 421	Bright White
Cadet Grey	Dark Roast	Bianco 619	Lily White 547	Light Grey Matte
Crystal White	Desert Sand	Cashmere 655		Anthracite Matte
Designer White	Driftwood	Pale Grey 650	Impressions	Black Matte
Ebony	Espresso	Bronze 662	Carbon LM08	Canadian Grey
Fern	Mesa	Cobalt 663	Cypress Point SO13	Monaco
Frosty White	Natural	Platinum 660	Dust SO15	White Chocolate
Gunsmoke	Nickel	Titanium 661	Graphite LG18	Skye
Hearthstone Grey	Nitefall	Guayana 617	Nero U129	Clearwater Oak
Heron	Nutmeg	Olivo 618	Oregon Pine LK84	White Cypress
Marina	Portabello	Olmo 634	Frozen Ash H1292	Ocala Walnut
Metro Grey	Saddle		Vincent Oak H3158	Helena Walnut
Regent Blue	Shale	Reflex Supermatte	Carini Walnut H3710	Valley Forge elm
	Taupe	White	Stone Grey H1288	Sabine Walnut
Paint Glazes	Weathered Teak	Antracite	Joplin Oak 17N	
Pewter	Custom	Black	Azabache Oak 75V	Pura Vita Veneer
Coffee		Calm sea	Glacial Ash 16N	Grey Oak
	Stain Glazes	Eucalyptus	Aurora Oak 98V	Milan Oak
	Pewter	Light Grey	Colorado Oak 97V	Firenze Oak
	Sable	Midnight Sun		Natural Oak
		North Wind		Brushed Light Oak
		Sunflower		Dark Ash
				Natural Ash
				Bleached Walnut
				Natural Walnut

In addition, our Prism Paint option in painted finishes offers over 1600 color selections from our Sherwin-Williams fan deck allowing for a custom color match to almost any color required. There is a setup cost of \$250 for Prism custom colors or for a custom match stain. Prism also carries a finishing surcharge on all products (custom stains do not). Charges relating to these options are calculated automatically using the Gemstone Excel Order Form/Estimate Generator previously described. Prism finished parts are ineligible for any expedited production and shipment. Prism finish paints are created using formulas and advanced sampling for approval is not required. Slight variation from fan deck swatches can naturally occur and will not be considered a defect.

DOOR STYLES

ALBANY

2-5/16" solid mortise & tenon frame

G-COVE solid raised center panel

REG inside frame bead

C2 outside edge

Alder, Cherry, Maple, White Oak, Paint Grade, MDF
Slab or 5-piece matching DF



Profile options available

ARLINGTON

2-5/16" solid mitered frame

1/4" plywood center panel

DESIGN SPECIFIC beaded inside frame

Beaded outside edge

Cherry, Maple, Walnut, Paint Grade, Alder, White Oak
5-piece matching DF only



No profile options

ASPEN

3/4" thick slab with 1" thick beveled edge moulding applied

Cherry, Maple, Walnut, White Oak, MDF matching DF



No profile options

BRISTOL

2-3/4" solid mortise & tenon frame

REVG-COVE solid beaded center panel - 1-1/2" centers

REG inside frame
L149 outside edge
Cherry, Maple, Walnut, Paint Grade Maple, MDF, Alder,



Outside profile options available

BURBURY

2-5/16" solid mortise & tenon frame

1/4" plywood center panel

DESIGN SPECIFIC inside frame applied moulding

DESIGN SPECIFIC outside edge

Cherry, Maple, Paint Grade Maple, Slab or 5-piece matching DF



Outside profile options available

CABO

Decorative Laminated Veneer (DLV) beveled shaker frame with recessed panel

2-1/4" framing

Miter or Mortise & Tenon



No profile options



CAMBRIDGE 2

2-5/8" solid mortise & tenon frame

1/4" plywood center panel

ELITE inside frame

L149 outside edge

Cherry, Maple, Walnut, Paint Grade,
Alder, White Oak

Slab or 5-piece matching DF



Profile options available

CATALINA

Textured Thermal laminate slab
panel with matching 1mm
edgeband for use in our closet
program only

Vertical or horizontal grain



No profile options

CRAWFORD

22-3/4" solid mortise & tenon frame

1/4" plywood center panel

DESIGN SPECIFIC inside frame

L149 outside edge

Cherry, Maple, Walnut, Paint Grade,
Alder, White Oak, MDF

Slab or 5-piece matching DF

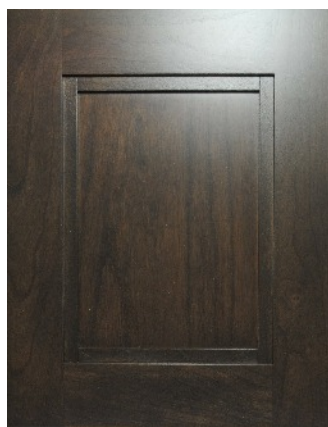

No profile options

CRAWFORD 2

2-3/4" solid mortise & tenon frame

1/4" plywood center panel

DESIGN SPECIFIC inside frame

L149 outside edge

Cherry, Maple, Walnut, Paint Grade,
Alder, White Oak, MDF

Slab or 5-piece matching DF



No profile options

DAYTONA

Decorative Laminate Veneer
(DLV) shaker frame with
recessed panel

Select framing width of 3" and
2-1/4" available

Miter or Mortise & Tenon

No profile options



2-1/4" frame

FAIRHAVENCh

2-5/16" solid mortise & tenon
square frame stiles; sloped profile
rails

1/4" plywood center panel

L149 outside edge

Cherry, Maple, Walnut, Paint Grade,
Alder, White Oak

Slab or 5-piece matching DF



No profile options

FAIRMONT

3" solid mortise and tenon frame

1/4" plywood center panel

OGEE inside frame

B2 outside edge

Cherry, Maple, Walnut, Paint Grade,
Alder, White Oak, MDF
Slab or 5-piece matching DF



Inside and outside profile options

FLORENCE

Decorative Laminated Veneer (DLV)
profiled mitre frame with recessed
panel

2-1/2" framing

5-piece matching DF only



No profile options

IMPRESSION

Textured Thermal laminate slab
panel with matching 1mm
edgeband

Vertical or horizontal grain



No profile options

IMPRESSION NOVA

Textured Thermal laminate

3" Shaker framing with 1/4"
center panel



No profile options

IMPRESSION TERRACE

Textured Thermal laminate slab
panel with matching Trim

Vertical or horizontal grain



No profile options

JUNO

3/4" Slim Shaker Mitre frame

1/4" recessed center panel

Vertical or horizontal grain

Cherry, Maple, Walnut, Paint Grade,
White Oak, MDF
Matching DF only



No profile options

LANCASTER

2-3/4" solid mortise & tenon frame

1/4" plywood center panel

F1223 inside frame

L149 outside edge

Cherry, Maple, Walnut, Paint Grade,
Alder, White Oak, MDF
Slab or 5-piece matching DF



Outside profile options only

MERA

High gloss slab laminate panel

Standard matching edgeband

3 colors



No profile options

MILANO

3/4" Pura Vita hardwood
veneered panel

Walnut, White Oak, Ash



No profile options

MONTCLAIR

2-3/4" solid mortise & tenon frame

Slant solid raised center panel

Design Specific inside frame

L149 outside edge

Cherry, Maple, Walnut, Paint Grade,
Alder, White Oak, MDF
Slab or 5-piece matching DF



Outside profile options only

PALMETTO

1-piece routed shaker MDF

2-3/4" square frame

L1160 edge

Painted finishes only; no effects



No profile options

REFLEX

High gloss or supermatte slab
laminate panel

Standard matching edgeband

Supermatte solid finishes
High Gloss solid finishes
High Gloss woodgrain finishes
High Gloss pattered finishes



No profile options

RIO

Decorative Laminate Veneer (DLV)
square frame with recessed panel
Select from mitre or mortise and
tenon joinery

Select framing width of 3" and 2-
1/4"

5-piece matching DF only



2-1/4" frame

No profile options

RUTLAND

2-11/16" DESIGN SPECIFIC
solid mitre frame

1/4" plywood center panel

Cherry, Maple, Walnut, Paint Grade,
Alder, White Oak
5-piece matching DF only



No profile options available

SEASIDE

2-5/16" solid mortise & tenon frame

DESIGN SPECIFIC false louver
center panel

DESIGN SPECIFIC inside frame

L149 outside edge

Cherry, Maple, Walnut, Paint Grade,
Alder, White Oak
Slab DF only



(bottom rail widths can vary 2" - 2-13/16")

No profile options

SINCLAIR

2-3/4" solid mortise & tenon frame

1/4" plywood center panel

DESIGN SPECIFIC inside frame

L149 outside edge

Cherry, Maple, Walnut, Paint Grade,
Alder, White Oak, MDF
Slab or 5-piece matching DF



Outside profile options available

VERONA

3/4" MDF slab panel

L149 Edge

Painted finishes only; no effects

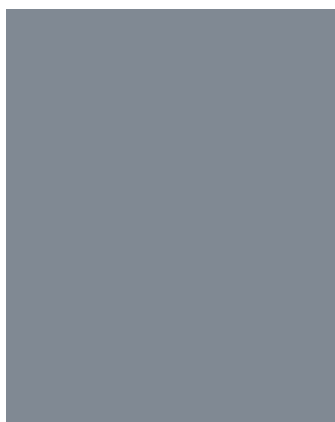

No profile options

WAKEFIELD

3-1/2" solid DESIGN DPECIFIC
mortise & tenon frame

9/16" plywood shallow center
panel

L149 outside edge

Cherry, Maple, Walnut, Paint Grade
Slab or 5-piece matching DF

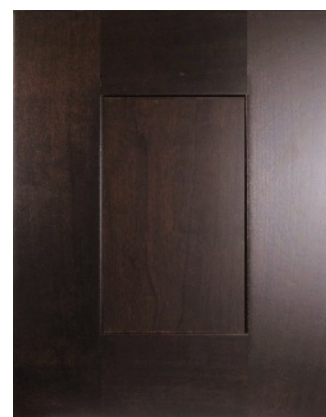

No profile options

WINDSOR

2-5/16" solid mortise & tenon
frame

1/4" plywood center panel

SQUARE inside frame

L149 outside edge

Cherry, Maple, Walnut, Paint Grade,
Alder, White Oak, MDF
Slab or 5-piece matching DF



Profile options available

Finishes

Conestoga stains, paints, and effects. Wood finishes are catalyzed conversion varnish providing the greatest wear resistance of modern wood finishes. Even the painted finishes receive a clear final topcoat for enhanced durability and color consistency. Stained and painted finishes all feature a 10° sheen. Stained finishes without glaze are available in 40° sheen finish by special request.

In addition, our Prism Paint option in painted finishes offers over 1600 color selections from our Sherwin-Williams fan deck allowing for a custom color match to almost any color required. There is a setup cost of \$250 for Prism custom colors or for a custom match stain. Prism also carries a finishing surcharge on all products (custom stains do not). Charges relating to these options are calculated automatically using the Gemstone Excel Order Form/Estimate Generator previously described.

Finish Effects

Brushed Glaze -

- Paints with a brushed glaze effect offer the classic look of a painted basecoat and glaze; this glaze treatment appears to have been applied with a paint brush. Simulated brush strokes in the glaze have been achieved using a precise sanding process prior to the glaze application.

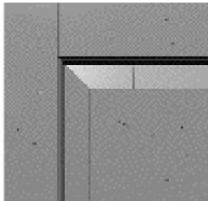

Distressing -

- Level 2 distressing – a random distribution of nicks and impressions, simulated wormholes, razor cuts and cut joints.
- Level 3 distressing – a random distribution of nicks and impressions, simulated wormholes, rasp marks and cracks.

Heirloom -

- The overall appearance of the Heirloom finish is achieved by combining three elements: one layer of Paint material, a glaze application and a combination of specific distressing techniques referred to as the Vintage Distressing Package. Although options exist as to which base color and glaze are chosen, each Heirloom finish must contain these three elements.
 - Vintage Distressing Package includes wear sanding, level 2 distressing, rasp marks and antiquing.
 - Veneers, endskins, plywood and front frames will not receive wear sanding or antiquing and will receive less distressing than doors.

**Antiquing
and Worn
Corner
Sanding –**

- The Wear Sanding option provides an aged appearance to unfinished doors and drawer fronts. On raised panel designs, sanding is applied to the corners of the panel and the outside corners of the framing. Recessed panels, mullions and frame only designs will receive sanding on the outside corners of the frame. Sanding will be random and each corner will vary in appearance.

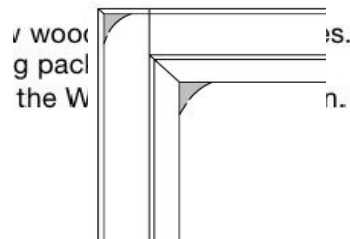

22 Gemstone Cabinetry, LLC

Policy and Specification Manual 2025

Weathered Grain



- The Weathered Grain option consists of random removal of surface material from panels, framing and edge profiles. Softer portions of the wood's surface are removed from the product's face, resulting in a highly textured look and feel
- Eligible framing beads: F-1223, Regular and Square only
- Eligible panel raises: P-057, Reverse G-Cove, and plywood center panels
- Eligible edge profiles: L-034, L-149, L-1160 and Machine Edge
- Edge profiles automatically receive the Weathered Grain option

Note: Multiple effects can be combined by selection on the order form. When the first effect is selected, another space appears where a second effect can be added.

23 Gemstone Cabinetry, LLC

Policy and Specification Manual 2025

Modifications

Gemstone is a custom manufactured-to-order product line, and we pride ourselves on our ability to meet unique and special requirements of our customers. Our automatic pricing takes most customizations into account and charges are self-generating and user friendly. However, certain customizations require additional charges that are to be listed as items in the quote. These items are detailed in the “Modifications” section. On some occasions, special consideration is given to customizations required that have no previously formulated customization charge (due to the unique nature of the request.) Contact customer service in these unique situations where we can determine the appropriate cost of a customization charge by either an additional percentage or flat rate charge or even a combination of both. The percentage or flat rate charge can be manually applied in the two “custom add” columns following custom dimensions columns on the order form.

Sizing - Our cabinets are generally manufactured using 3” increment widths. In the event a custom size is required, please specify by populating a line item with the desired configuration in the next standard size greater than the desired size, then entering the custom dimension in the appropriate custom dimension column for width, height, or depth. The width entered must be smaller than the width of the catalog item chosen. Height and depth can be specified greater than the catalog size and a charge for each is automatically added into the total. Fractional sizes can be entered to the nearest 1/8” on cabinet items, 1/16” on panels, loose parts and accessory doors, etc.

Separate Modification Charges

Corner Clips – Rear clipped corners can be specified by noting the desired dimensions in the special instructions area next to the affected line item. In addition, please add the line item for this charge found in the “Modifications” section of the library of items as in the illustration below. An accompanying diagram is welcome for clarification.

	Cabinet Type	Doors & Drawers	Cabinet Size	List	Finish Ends	Custom Dimensions			Custom Add		QTY	Net Cost	LINE ITEM INSTRUCTIONS
						Width	Height	Depth	%List	\$List			
1	Base	2D	30W 34.5H 24D	634								228.24	clip right rear corner 12 x 12
2	Modifications	Angled Rear Clip	Note Dim. at Right	340								122.40	12 x 12 clip line 1
3													

Pipe Chase cut-out – Drawers and rollouts installed below sinks have gained popularity among consumers. Drawers can be modified to accommodate plumbing service into these cabinets while preserving the desired form and function. A cut-out dimension must be noted and the corresponding item added to the order as with clipped corners above. Pipe chase drawers will not receive branding. If selecting a sink drawer based cabinet from the library, the charge for pipe chases are already factored in and no mod charge is necessary. However, please provide the cut-out size.

Partial Finished Interior – Open cabinets and glass door cabinets found in our library are assumed to have finished interior to match the exterior specified finish and the added cost of this is already calculated in. No callout is necessary for this option. If a finished interior surface needs to be specified that is not ordinarily so, a separate item charge should be listed and the total surface area (in square footage) should be entered as the quantity. Please detail the affected cabinets and provide diagrams if necessary.

24 Gemstone Cabinetry, LLC

Policy and Specification Manual 2025

Recessed Toe Kick End – Toe kicks can be modified as to height and depth, or removed altogether, without charge. Simply note in the comments on the order form. For certain designs, toe kicks can be recessed on the cabinet ends as well. When this option is needed, please note in the special instructions for the line item affected along with the measurement to recess, then add the “Recessed TK End” charge on a separate line with the appropriate quantity (if more than 1).

Door and Drawer Options – Arches and special lite options may be specified for specific cabinets. Please note in the special instructions for the line item affected, then add the charge on a separate line with the appropriate item and quantity (if more than 1).

Drawers can be added where needed if a standard configuration from our library does not align with the requirements of the job. Please note in the special instructions for the line item affected, then add the “Insert Drawer/DF” charge on a separate line with the appropriately sized item and quantity (if more than 1).

Blum Aventos lifts for doors are offered in a wide variety of wall cabinet sizes and types in our standard library. If a lift system needs to be added to any other configuration not normally found, please note in the special instructions for the line item affected, then add the “Add Aventos” charge on a separate line with the appropriate type and quantity (if more than 1). A detailed diagram may be submitted for clarification of design specifics.

Blum Tipon touch release hardware may be selected in two parts. First, by selecting Tipon for your drawer slide selection in the upper heading, all drawers will be converted to touch release Tipon. These are only available with genuine Blum Tandem or Legrabox drawer slides. The additional charge for Tipon is calculated automatically in the item pricing. To add the Tipon for doors charge, please select this item and total quantity of doors affected on a separate line.

Additional shelves or dividers beyond standard can be specified in the same way, by noting in the special instructions for the line item affected, then add the charge on a separate line with the appropriate item approximate size and quantity (if more than 1). We will assume the precise sizing will be the default size for the cabinet noted unless other instructions are given. Additional shelves ordered will be made from same interior material as all other shelving.

Peninsula or Double Entry cabinets can be provided. Please specify in the Line-Item Instructions column to the right of the item. The charge for Peninsula double entry is 50% and should be entered by typing “50” in the %List column, where the order form will then automatically calculate into the net price.

Finishes and touch-up kits can also be supplied.

Samples

A dealer sample kit is available for purchase to assist in presenting and closing jobs. The kit includes:

Gemstone mini-base cabinet showing the use of Maple interior, Dovetail drawer, Tandem slides and transitional wood door/drawer style with painted finish.

15 sample cabinet doors showing a variety of our most popular styles and colors.

Dovetail drawer box containing up to 200 color chips representing all finish categories.

Prism Paints fan deck

Specifications book and catalog

Literature and product sell sheets for distribution to customers.

Additional door samples and color chips not found in the sample kit can be ordered using the order form or by submitting the sample request form. Active dealers who have purchased the sample kit are given a sample allowance of 3 free doors per calendar year for updates and customer samples. Sample doors can be purchased beyond the kit and standard allowance for \$45 each and color chips for \$4 each. We encourage ordering a door sample along with each job ordered to help build your sample door library.

LIFETIME LIMITED WARRANTY

Gemstone Cabinetry (the manufacturer) warrants the original consumer purchaser for as long as they own their home that their Gemstone Cabinetry products will be free from defects in material and workmanship under normal use. This warranty is only applicable to products used in residential applications within the United States and is not transferable to subsequent owners. Should defects in material or workmanship exist during the applicable warranty period in any Gemstone Cabinetry product, the manufacturer will elect at its discretion to either repair or replace the defective material or component, free of charge. This warranty covers only parts and materials of the products supplied by the manufacturer. Not covered under this warranty are countertops, appliances, plumbing fixtures, etc. or the costs, including labor, to remove and reinstall materials and related components such as fittings, appliances, etc.

This warranty shall become void if the cabinets are in any way modified, improperly installed or damaged prior to or during the installation. Furthermore, this warranty will not apply to cabinets damaged by misuse, neglect, abuse, acts of God, or the effects of normal wear and tear.

The manufacturer reserves the right to alter design, specifications and material without obligation to make similar changes to products previously manufactured.

The repair(s) or replacement(s) are contingent upon the current product offerings of styles and construction options within the Gemstone Cabinetry product line at the time of the warranty claim. If a warranty claim is filed after a Gemstone product becomes obsolete, the manufacturer reserves the right to honor the warranty in the best way which may or may not include replacement of the affected component and any other component(s) in the residential application to achieve a uniform appearance with a similar and comparable product style of the originally purchased style.

If components are replaced, the manufacturer cannot guarantee that the finish of these replacements will exactly match the finish and appearance of the components in the residential application due to the natural “aging” of wood or subtle changes that may occur from production run to run over long periods of time. THE MANUFACTURER DISCLAIMS ALL OTHER WARRANTIES, EXPRESSED OR IMPLIED, INCLUDING THE IMPLIED WARRANTIES OF MERCHANTABILITY AND FITNESS FOR A PARTICULAR PURPOSE.

Wood and wood veneers may contain character and color variations that occur naturally and are not considered defects. The utmost care and consideration is given to grain, color, and grading procedures when selecting veneers and hardwoods so that the end result is blended and pleasing to the eye, letting the natural beauty of wood show at its best.

Graphic images on our website and in literature are representations of products we manufacture. While we do our best to accurately display products through various mediums, actual samples should be viewed before ordering to ensure that the true nature of the product will be fairly and accurately represented.

27 Gemstone Cabinetry, LLC

Policy and Specification Manual 2025

EXHIBIT A

NEW CUSTOMER INFORMATION FORM

Company Name _____

DBA? _____

Fed ID _____ sales tax ☐ taxable ☐ exempt

if exempt - must provide resale certificate

Company Structure corporation ☐ partnership ☐ sole proprietor ☐

Principle name 1 _____

Principle name 2 _____

Principle name 3 _____

Years in business _____

Mailing Address _____

city _____ state _____ zip _____

Shipping Address _____
(if different)

city _____ state _____ zip _____

Phone _____ fax _____ cell _____

email _____

Authorized Purchasers _____

Terms Prepay ☐

50/50 ☐

Paypal ☐

CC ☐

Credit card on file number _____

exp _____ CCV _____

name _____

address _____

Please fax or email completed form to Gemstone or present to your sales rep. New dealers are required to purchase a sample startup kit (\$399) in order to be recognized by Gemstone Cabinetry. Authorized dealers will be listed on the website as such. Leads generated will be passed on to dealers based on geographical proximity.

28 Gemstone Cabinetry, LLC

Policy and Specification Manual 2025

EXHIBIT B

LITERATURE/SAMPLE REQUEST FORM

Company Name _____

Account ID _____

Shipping Address _____
(if different than on file) _____

city _____ state _____ zip _____

Phone _____ fax _____ cell _____

email _____

Person making request _____

Please fax or email completed form to Gemstone or present to your sales rep. Sales tax and shipping charges will apply.

EXHIBIT C

ITEM	COLOR	STYLE	QUANTITY	NET COST	TOTAL COST
COLOR CHIP SET				\$1000.00	
MINI BASE SAMPLE CABINET				\$129.00	
DOOR SAMPLE				\$45.00	
DOOR SAMPLE				\$45.00	
DOOR SAMPLE				\$45.00	
COLOR SAMPLE				\$4.00	
COLOR SAMPLE				\$4.00	
COLOR SAMPLE				\$0.00	
BIFOLD BROCHURE					
				\$0.00	

BASE CABINETS

1 full height door - 1DR, 1DL

9 - 24" width

Single adjustable shelf

1DR - Right Hinge

1DL - Left Hinge

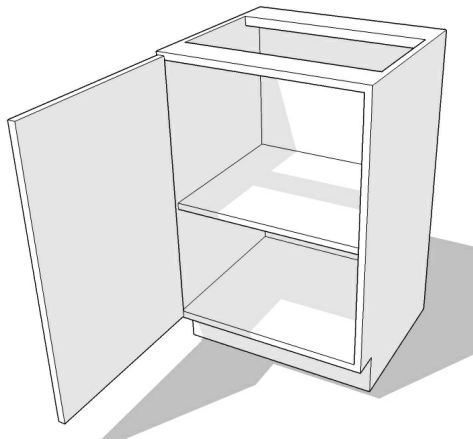

2 full height doors - 2D

24 - 48" width

Single adjustable shelf

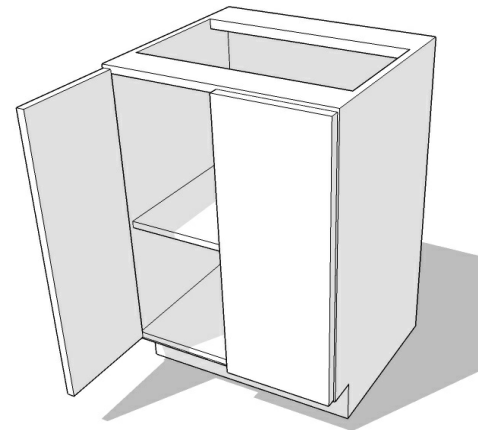

1 door/ Spice Rack Pull-out Organizer - 1DSRPO

7.5, 9, 10.5, 12" widths only

Hardware Resources door
mounted soft close BPO2 or
similar installed

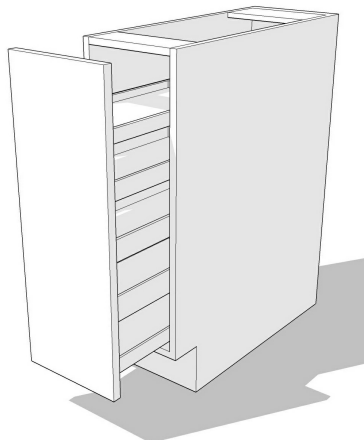

1 door/ 1 drawer - 1D/1DrR, 1D/1DrL

9 - 24" width

Single adjustable shelf

6"h top drawer

Single adjustable shelf

1D/1DrR - Right Hinge

1D/1DrL - Left Hinge

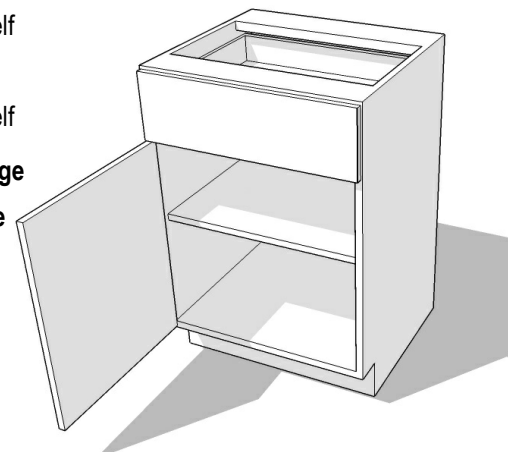

2 doors/ 1 drawer - 2D/1Dr

24 - 39" width

Single adjustable shelf

6"h top drawer

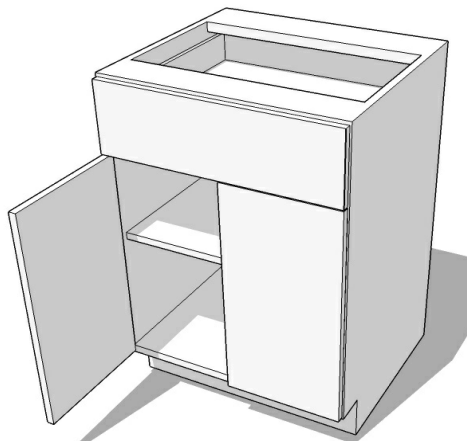

2 doors/ 2 drawers - 2D/2Dr

24 - 48" width

Single adjustable shelf

6"h top drawers

Full lower divider in cabinets

40" and wider

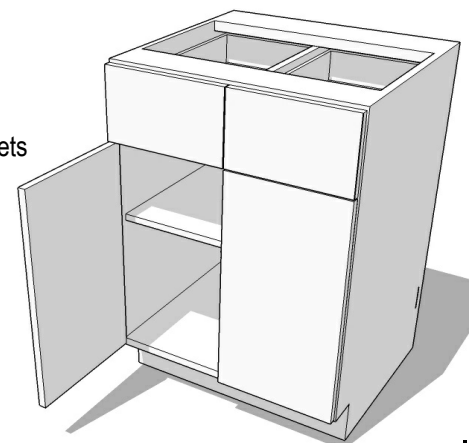

BASE CABINETS

1 drawer - DB1

9 - 39" width; 20" high
15-½" high single drawer

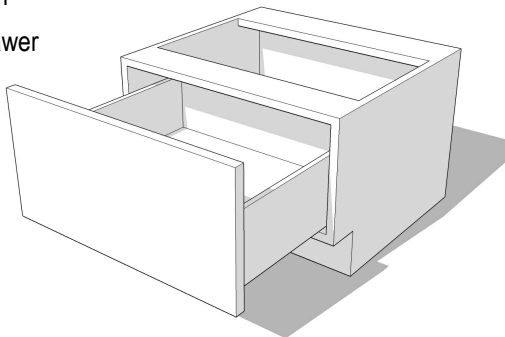
**2 drawers - 2Dr**

9 - 39" width
Equal height drawers

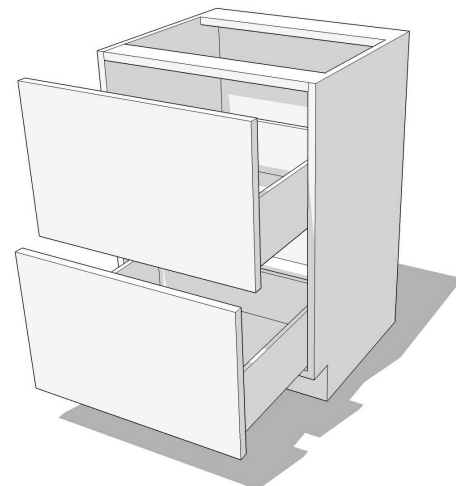
**3 drawers - 3Dr**

9 - 39" width
6" top drawer
Equal drawers below

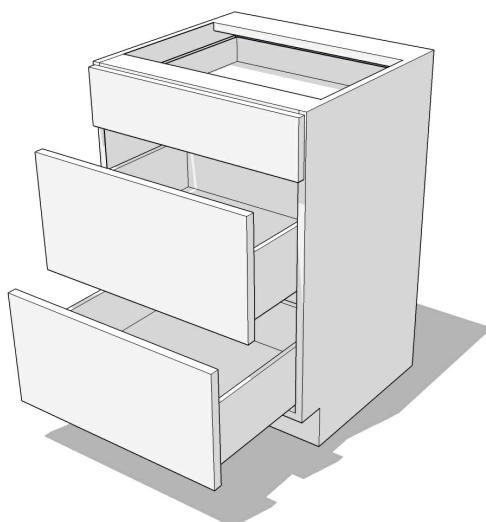
**4 drawers - 4Dr**

9 - 39" width
6"h top and 2 middle drawers
11-5/16" bottom drawer

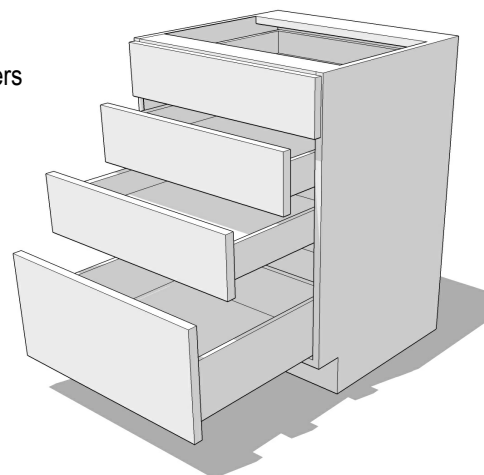
**Cooktop 2 deep drawers - CT3**

30 - 39" width
6"h top false front
Equal drawers below

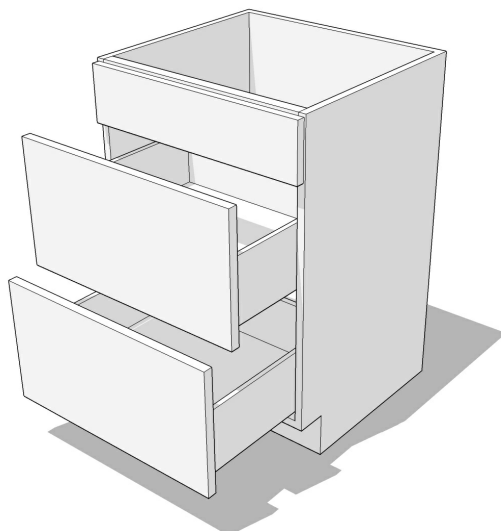
**Cooktop 3 drawers - CT4**

30 - 39" width
6"h top false front
6"h middle drawers
11-5/16"h bottom drawer

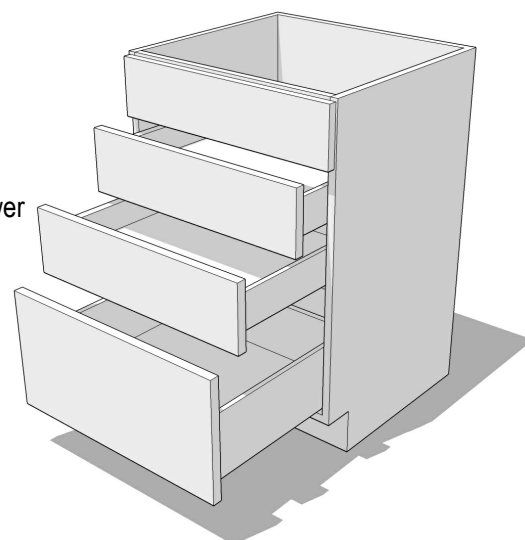

BASE CABINETS

Blind corner 1 door - BC-1DBLR, BC-1DBLL

30-48" width

Single adjustable shelf

24" panel (15" panel on 30
& 33" wide cabinet)

Door hinged from panel

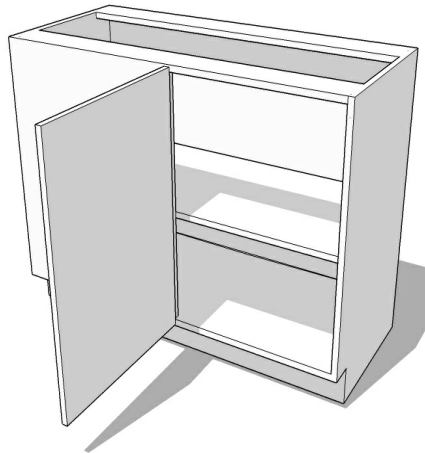
**BC-1DBLR - Panel on
right; right hinge****BC-1DBLL - Panel left;
left hinge****Blind corner 1 door/ 1 drawer - BC-1D/1DrBLR, BC-1D/1DrBLL**

30-48" width

6"h drawer

Single adjustable shelf

24" panel (15" panel on
30 & 33" wide cabinet)

Door hinged from panel

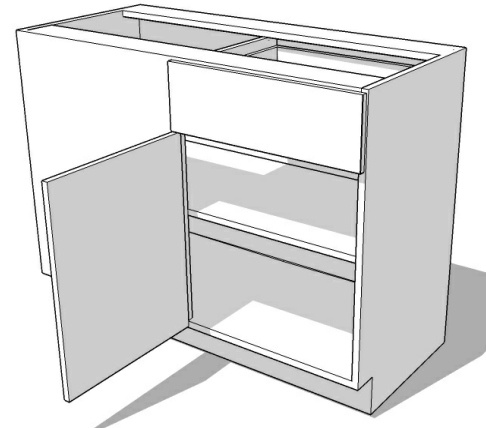
**BC-1D/1DrBLR - Panel
on right; right hinge****BC-1D/1DrBLL - Panel
left; left hinge****Corner 45 Lazy Susan - C45LZR, C45LZL**33, 36, 39, 42" width equal
depth on both sides only

Solid top

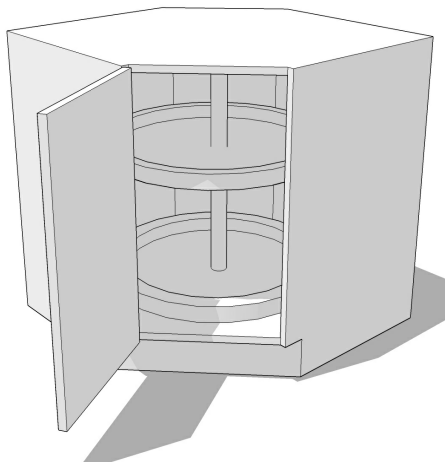
Banded maple round lazy
susan**C45LZR - Right Hinge****C45LZL - Left Hinge****Corner 45 Shelf - C45SR, C45SL**33, 36, 39, 42" width equal
depth on both sides only

Solid top

Full Depth adjustable shelf

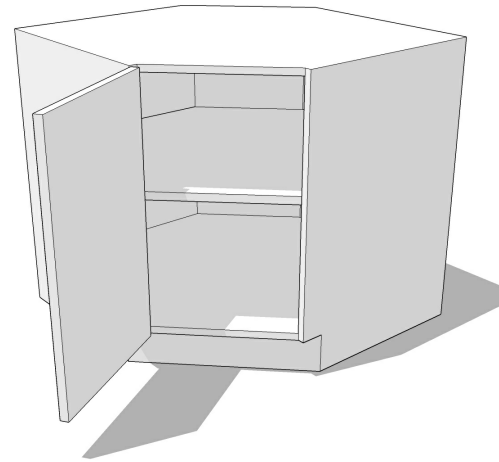
C45SR - Right Hinge**C45SL - Left Hinge**If using as a corner sink,
please specify "No Shelf"**Corner 90 Lazy Susan - C90LZR, C90LZL**33, 36, 39" width on either
side (specify if left and right
dimension are not equal)

Solid top

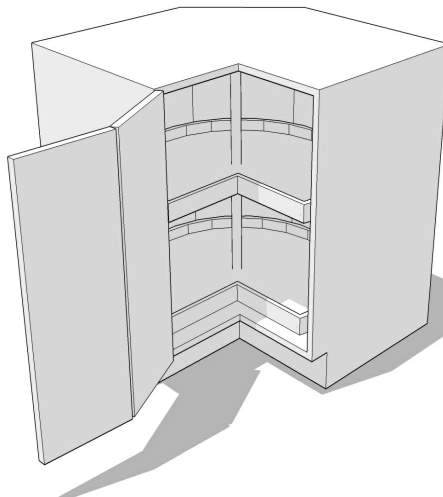
Banded maple kidney lazy
susan**C90LZR - Right Hinge****C90LZL - Left Hinge****Corner 90 Shelf - C90SR, C90SL**33, 36, 39" width on either
side (specify if left and right
dimension are not equal)

Solid top

Full Depth adjustable shelf

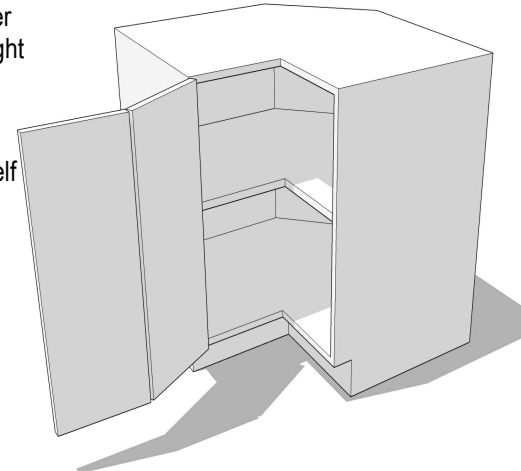
C90SR - Right Hinge**C90SL - Left Hinge**

BASE CABINETS**1 door/ 1 drawer/ 2 rollouts - 1D/1D-ROR, 1D/1D-ROL**

15 - 24" width

6"h top drawer

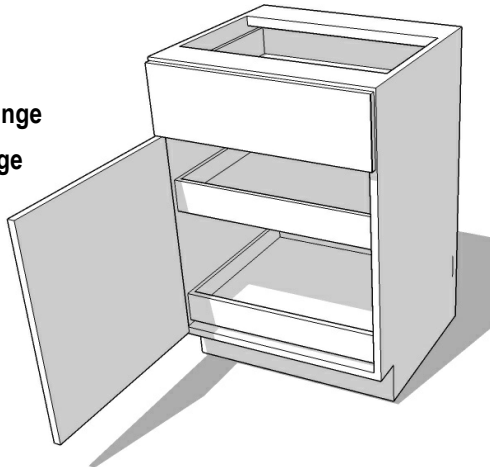
1D/1D-ROR - Right Hinge**1D/1D-ROL - Left Hinge****2 doors/ 1 drawer/ 2 rollouts - 2D/1Dr-RO**

24-39" width

6"h top drawer

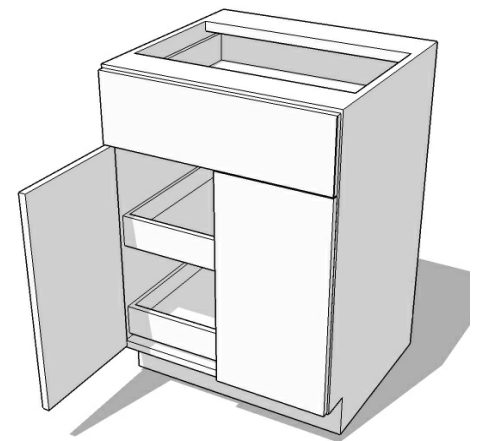
**2 door/ 2 drawer/ 2 rollouts - 2D/2Dr-RO**

24 - 39" width

6"h top drawers

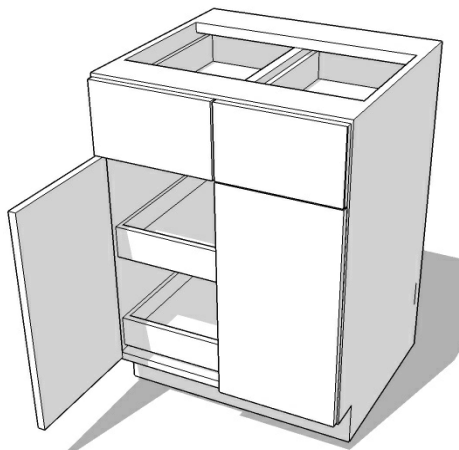
**1 door with trash roll out - 1D-TRO**

15-24" width

Rev-a-shelf 50 quart
4WCSC door mounted,
soft closing trash pullout
typical. (Single can on
15" wide)

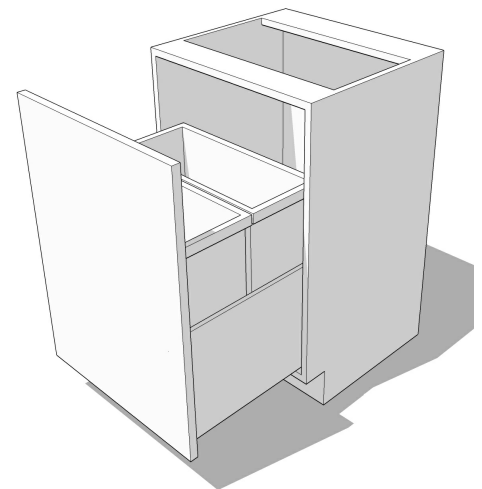
**1 door/ 1 drawer with trash roll out - 1D/1D-TRO**

15-24" width

6"h top drawer

Rev-a-shelf 4WCSC
door mounted, soft clos-
ing trash pullout typical.
(Single can on 15" wide)

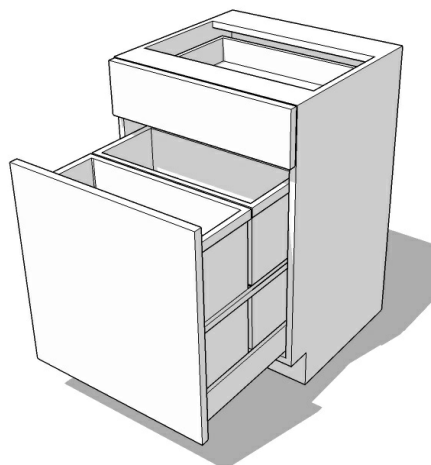
**Microwave undercounter - MC-2D**

24 - 33" width

17-7/8"h top panel/ frame

11-11/16"h bottom doors

Standard interior

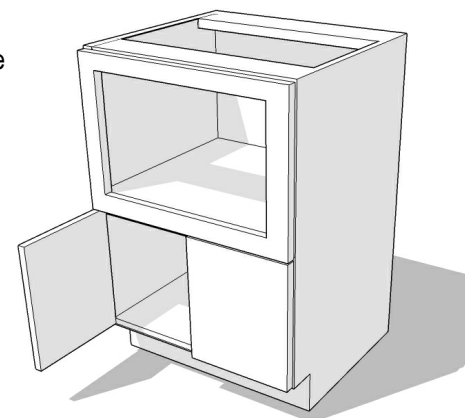

BASE CABINETS

Microwave undercounter - MC-1Dr

24 - 33" width
 17-7/8"h top panel/ frame
 11-11/16"h bottom drawer
 Standard interior

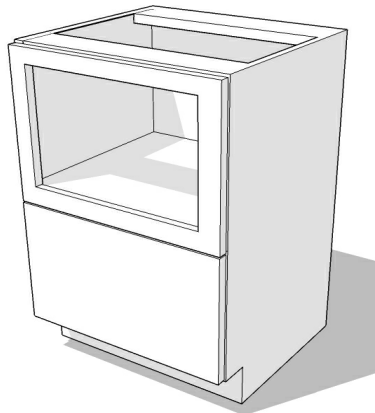
**Angled end - Aend**

24 x 24", 21 x 21"
 Finished interior
 Fixed shelf
 Solid top

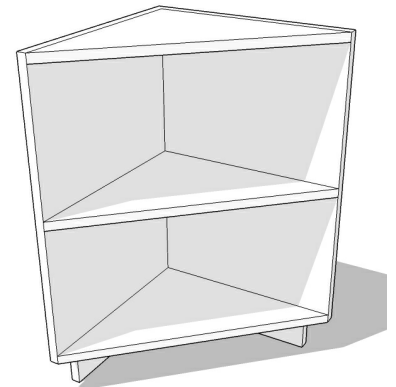
**Angled end 2 doors - AE/2D**

24 x 24", 21 x 21"
 Fixed shelf
 Solid top

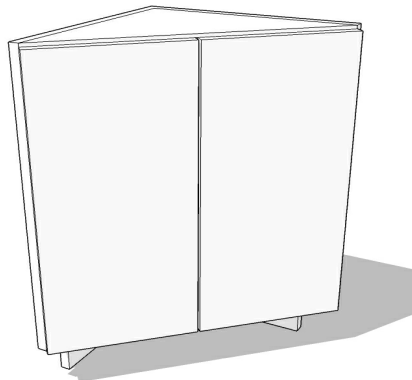
**Angled end 1 door - AE/1DR, AE/1DL**

12-1/2"w x 24"d
 Short side depth 13"
 Hinged on short side; choose left or right hinging to indicate left or right short side orientation
 Full depth adjustable shelf
 Solid top

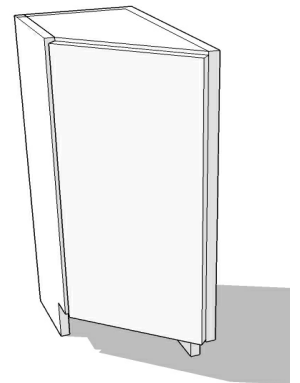
**Desk knee drawer - KneeDr**

12 - 39" width
 24" deep; select 21" deep in **VANITY** category
 5"h drawer
 6"h drawer

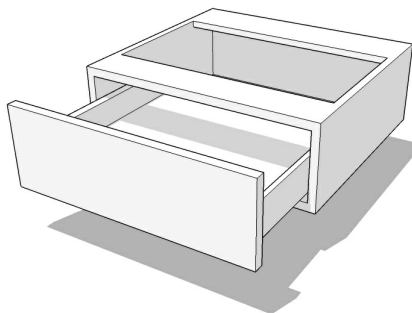
**Open no doors - OPEN**

9-48" width
 Finished interior
 Full depth adjustable shelf
 Center partition on 42" and wider

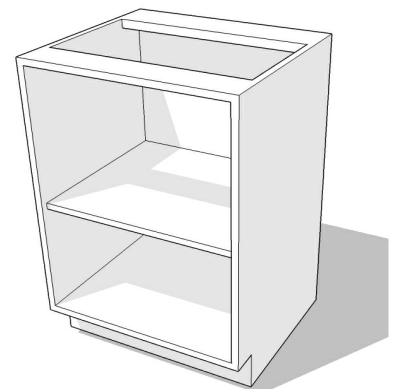

SINK BASE CABINETS

Sink 1 door - 1DR, 1DL

18-24" width

1DR - Right hinge

1DL - Left hinge

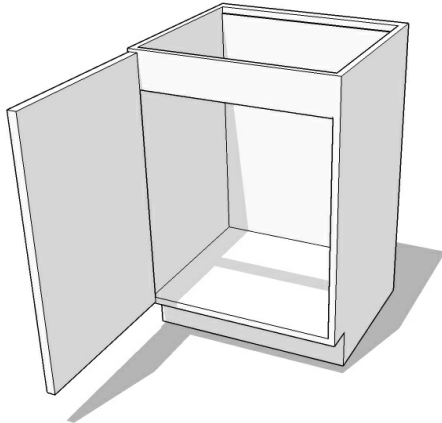

Sink 2 doors - 2D

24 - 48" width

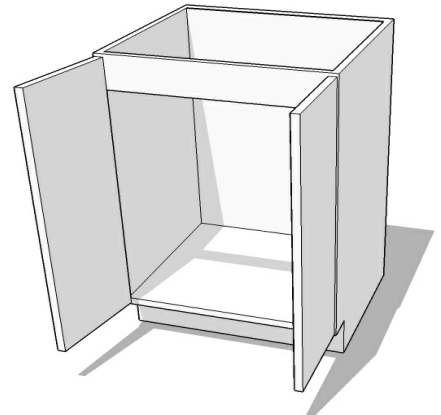

Sink 1 door/ 1 false front - 1D/1FR, 1D/1FL

18-24" width

6"h top false front

1D/1FR - Right hinge

1D/1FL - Left hinge

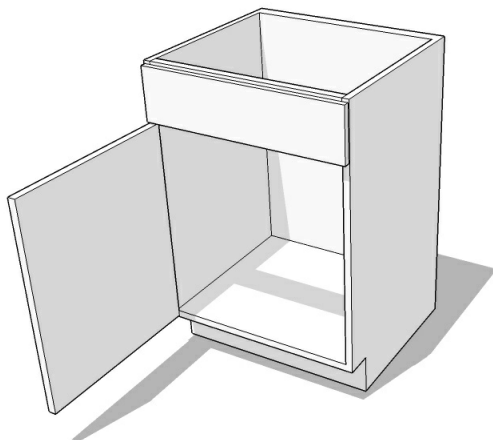

Sink 2 door/ 1 false front - 2D/1F

24-48" width

6"h top false front

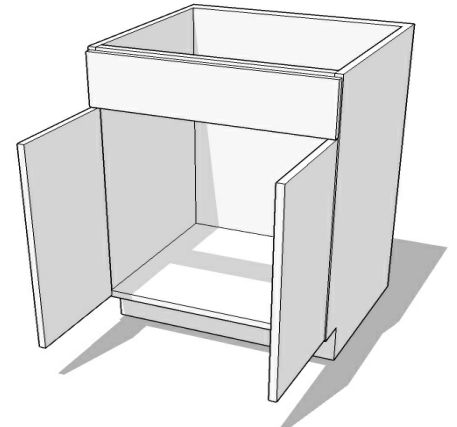

Apron Sink 2 doors - 2D/Apron

30-48" width

10"h clear above doors

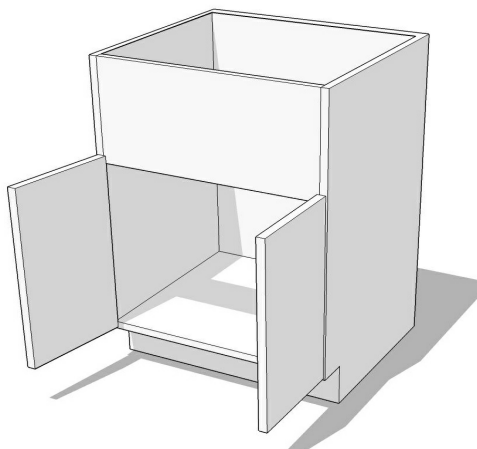

Sink 2 drawers - 2Dr

24-39" width

Equal drawers

Pipe chase drawer cut outs included; please specify cut out sizing

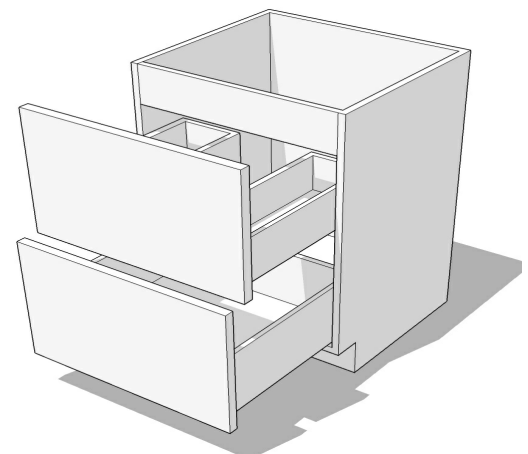

BASE CABINETS

Sink 2 drawer/ 1 false front - 2Dr/1F

24-39" width

6"h top false front

Equal drawers below

Pipe chase drawer cut
outs included; please
specify cut out sizing

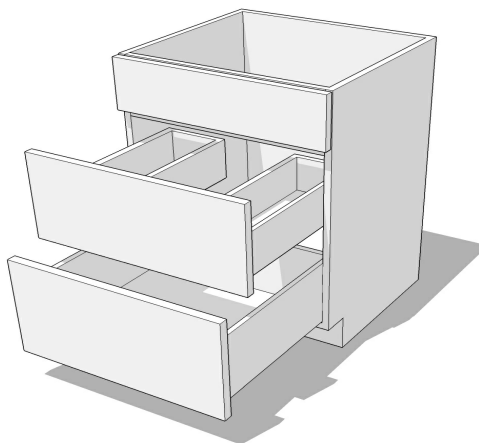

WALL CABINETS**1 door - 1D*R, 1D*L**

Standard 13"d

9 - 24" width

12 - 60" Height

21 - 27"h = 1 adjustable shelf

30 - 36"h = 2 adjustable shelves

39 - 48"h = 3 adjustable shelves

60"h = 4 adjustable shelves

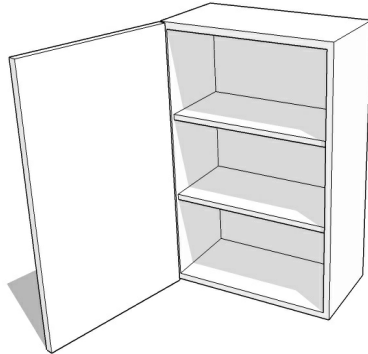
1D*R - Right hinge**1D*L - Left hinge****2 doors - 2D***

Standard 13"d

24 - 48" width

12 - 60" Height

21 - 27"h = 1 adjustable shelf

30 - 36"h = 2 adjustable shelves

39 - 48"h = 3 adjustable shelves

60"h = 4 adjustable shelves

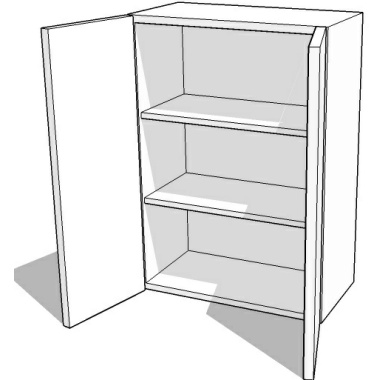
**2 doors 24" deep - 2D***

30 - 48" width

12 - 24" high

21 - 24"h = Single adjustable shelf

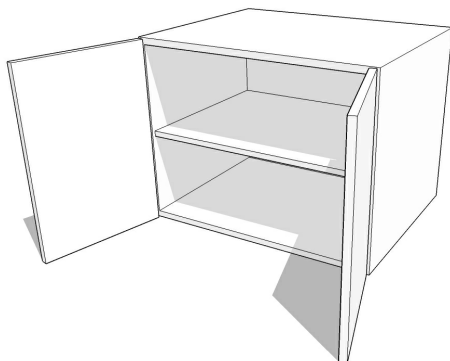
**Corner 45 degree 1 door - C45R, C45L**

Standard 13"d and 15"d

24 and 27" width across back sides

18 - 60" Height

21 - 27"h = 1 adjustable shelf

30 - 36"h = 2 adjustable shelves

39 - 48"h = 3 adjustable shelves

60"h = 4 adjustable shelves

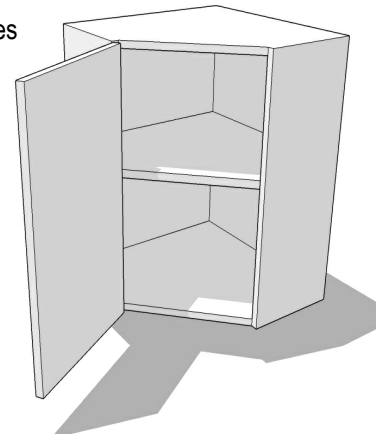
C45R - Right hinge**C45L - Left hinge****Corner 45 degree 1 door/ lazy susan - C45LSR, C45LSL**

Standard 13"d and 15"d

24 and 27" width across back side

30 - 42" Height

30 - 36"h = 2 trays

39 - 42"h = 3 trays

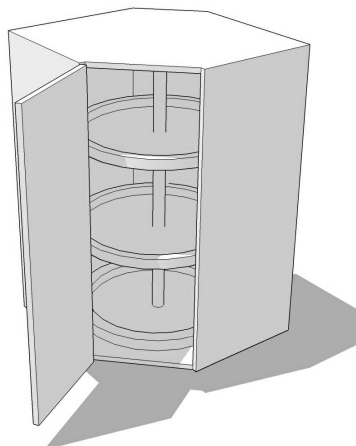
C45LSR - Right hinge**C45LSL - Left hinge****Corner 90 degree 1 door - C90R, C90L**

Standard 13"d and 15"d

24 and 27" width across back side

18 - 60" Height

21 - 27"h = 1 adjustable shelf

30 - 36"h = 2 adjustable shelves

39 - 48"h = 3 adjustable shelves

60"h = 4 adjustable shelves

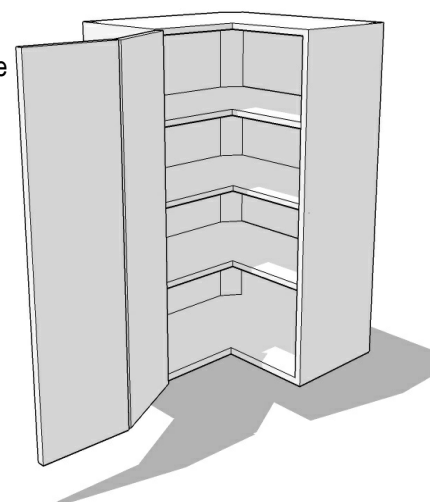
C90R - Right hinge**C90L - Left hinge**

WALL CABINETS

Blind corner 1 door - BC-1DBLR, BC-1DBLL

Standard 13"d

24 - 36" width; 24 - 60" high

15" panel width

24 - 27"h = 1 adjustable shelf

30 - 36"h = 2 adjustable shelves

39 - 48"h = 3 adjustable shelves

60"h = 4 adjustable shelves

Door hinges off of panel

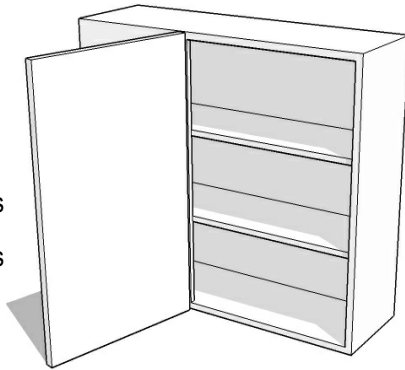
**BC-1DBLR - Panel right; right hinge****BC-1DBLL - Panel left; left hinge****Blind corner 2 door - BC-2DBLR, BC-2DBLL**

Standard 13"d

39-48" width; 24 - 60" high

15" panel width

24 - 27"h = 1 adjustable shelf

30 - 36"h = 2 adjustable shelves

39 - 48"h = 3 adjustable shelves

60"h = 4 adjustable shelves

**BC-2DBLR - Panel right****BC-2DBLL - Panel left****1 door/ 1 drawer - 1D/1DrR, 1D/1DrL**

Standard 13"d

12 - 24" width

30 - 60" height

30"h = 1 adjustable shelf

36 - 42"h = 2 adjustable shelves

48 - 60"h = 3 adjustable shelves

6"h drawer

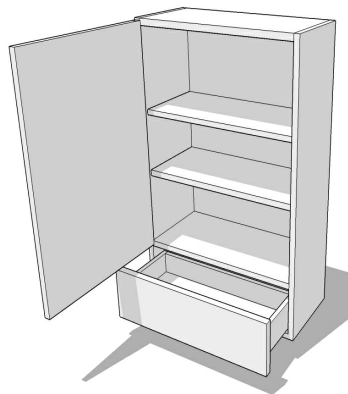
**1D/1DrR - Right hinge****1D/1DrL - Left hinge****1 door/ 1 drawer - 1D/2DrR, 1D/2DrL**

Standard 13"d

12 - 24" width

30 - 60" height

30"h = 1 adjustable shelf

36 - 42"h = 2 adjustable shelves

48 - 60"h = 3 adjustable shelves

6"h drawers

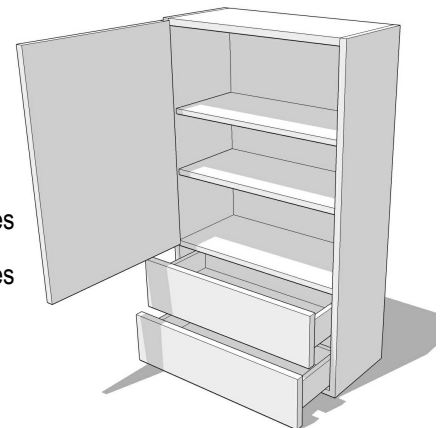
**1D/2DrR - Right hinge****1D/2DrL - Left hinge****2 door/ 1 drawer - 2D/1Dr**

Standard 13"d

24 - 39" width

30 - 60" height

30"h = 1 adjustable shelf

36 - 42"h = 2 adjustable shelves

48 - 60"h = 3 adjustable shelves

6"h drawer

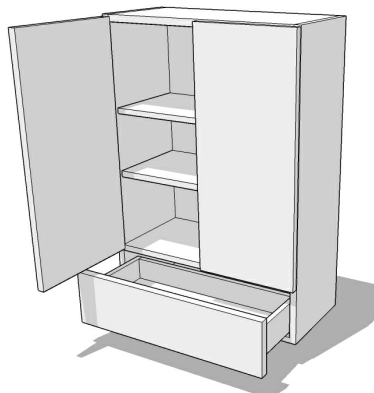
**2 door/ 1 drawer - 2D/2Dr**

Standard 13"d

24 - 39" width

30 - 60" height

30"h = 1 adjustable shelf

36 - 42"h = 2 adjustable shelves

48 - 60"h = 3 adjustable shelves

6"h drawers

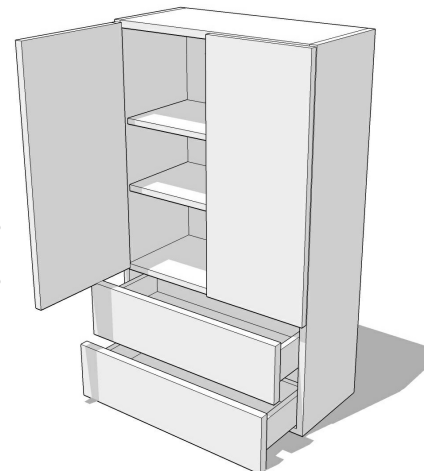

WALL CABINETS**Angled wall open end - AEnd**

Standard 13"d

6 - 13" width

30 - 60" height

30 - 39"h = 2 fixed shelves

42 - 60"h = 3 fixed shelves

Finished interior

Reversible for left or right orientation

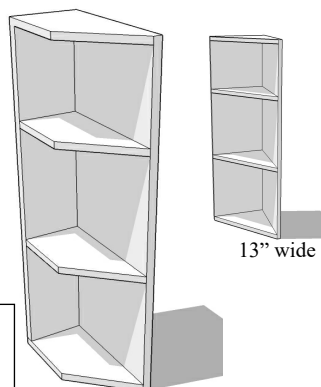
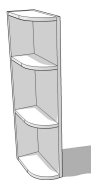
Available as 1/4
round radius**Angled wall end 1 door - AEnd/1DR, AEnd/1DL**

Standard 13"d

13" width

30 - 60" height

30 - 36"h = 2 fixed shelves

42 - 60"h = 3 fixed shelves

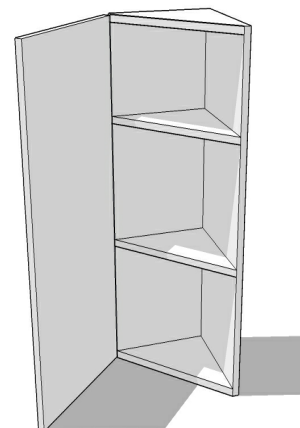
AEnd/1DR - Right hinge**AEnd/1DL - Left hinge****Microwave 2 door - MWS-2D**

27 - 30" width

30 - 42" height

42"h = 1 adjustable shelf

18"h lower open section; 18"d

Finished interior open lower section

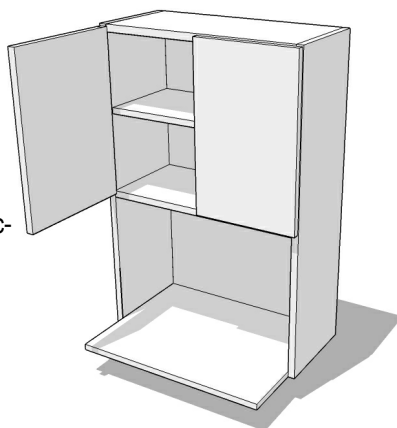
**Microwave 2 door - MWB-2D**

22" deep

27 - 30" width

30 - 42" height

42"h = 1 adjustable shelf

21"h front frame for built-in appliance on lower section; standard interior finish

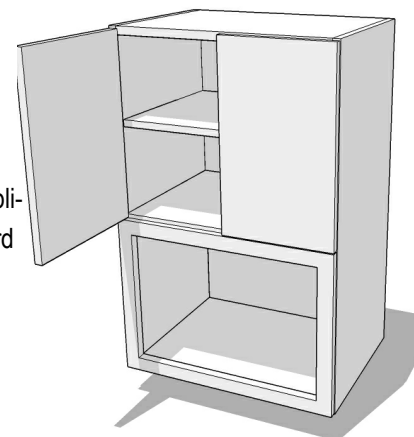
**Toilet topper 2 door - TT-2D**

24" width; 9" depth

30, 42, 48" height

30"h = 1 adjustable shelf

42"h = 2 adjustable shelves

48"h = 3 adjustable shelves

6"h lower open section with finished interior

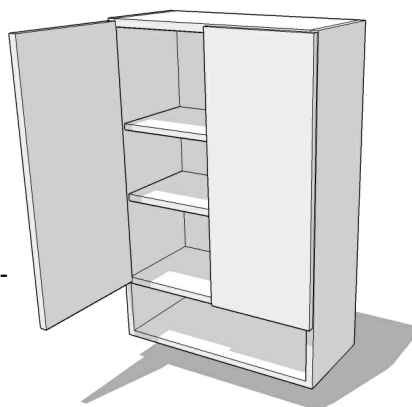
**Medicine Cabinet, 1 door - MED1D**

15" width; 4" depth (plus 3/4" front face frame)

24, 30, 36" height

24"h = 2 adjustable shelves

30 - 36"h = 3 adjustable shelves

Reversible hinge - cabinet can be flipped over for opposite hinging

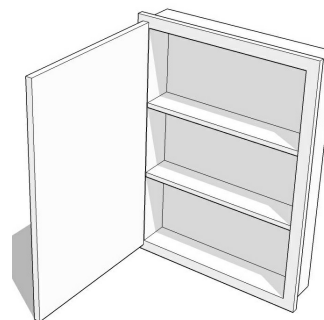

WALL CABINETS**Aventos HK lift 1 door - 1DHK, 1DHKS**

Standard 13"d

24 - 48" width

12 - 24" height

24"h = 1 adjustable shelf

Cabinets 15" high or smaller and
39" wide or smaller use 1DHKS;
all others greater than 15" high
or 39" wide select from 1DHK

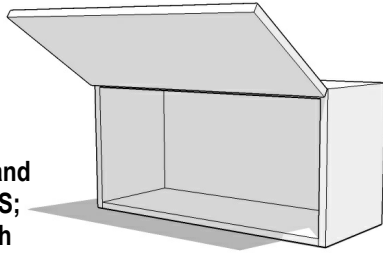
**Aventos HL lift 1 door - 1DHL**

Standard 13"d

24 - 48" width

15 - 21" height

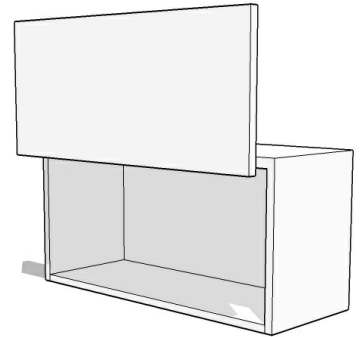
**Aventos HF lift Bi-folding door - 1DHF**

Standard 13"d

24 - 48" width

24 - 42" height

24, 27"h = 1 adjustable shelf

30 - 42"h = 2 adjustable shelves

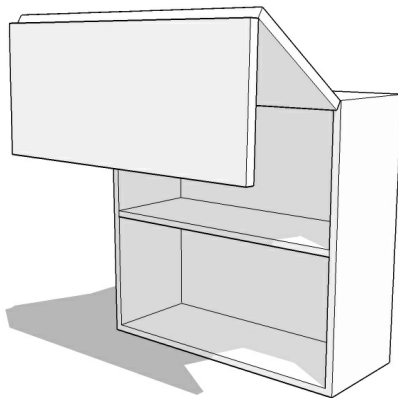
**Tower 2 doors - 2DTowerR, 2DTowerL**

19" depth (14" depth lower section)

9" width

57 - 72" height

Lower section = 28" high with 2 shelves

2DTowerR - Right hinge**2DTowerL - Left hinge**

Optional door mounted
spice rack pullout

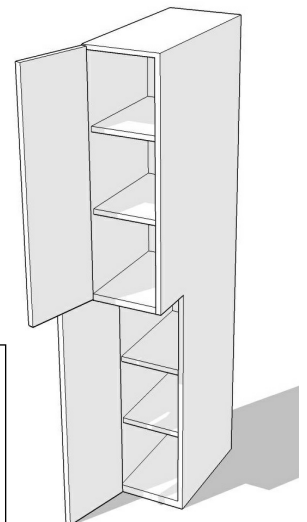
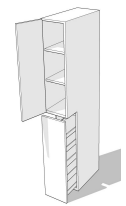
2DPOTowerR - Right hinge**2DPOTowerL - Left hinge****Open walls no doors - OPEN**

Standard 13" depth

9 - 48" width

12 - 60" height

21 - 27"h = 1 adjustable shelf

30 - 39"h = 2 adjustable shelves

42 - 60"h = 3 adjustable shelves

Finished interior

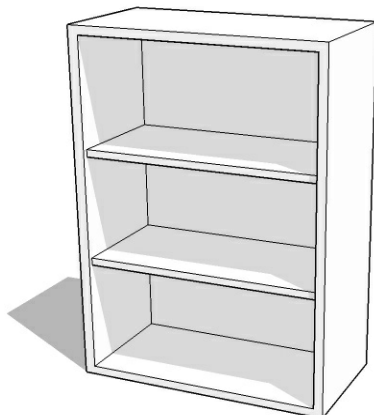

WALL - 1 LIGHT CABINETS (PREPPED FOR GLASS PANELS)

1 door - 1DR, 1DL

Standard 13"d
 9 - 24" width
 12 - 60" Height
 21 - 27"h = 1 adjustable shelf
 30 - 36"h = 2 adjustable shelves
 39 - 48"h = 3 adjustable shelves
 60"h = 4 adjustable shelves
 Finished interior

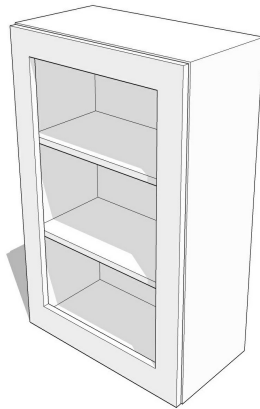
1D*R - Right hinge**1D*L - Left hinge****2 doors - 2D**

Standard 13"d
 24 - 48" width
 12 - 60" Height
 21 - 27"h = 1 adjustable shelf
 30 - 36"h = 2 adjustable shelves
 39 - 48"h = 3 adjustable shelves
 60"h = 4 adjustable shelves
 Finished interior

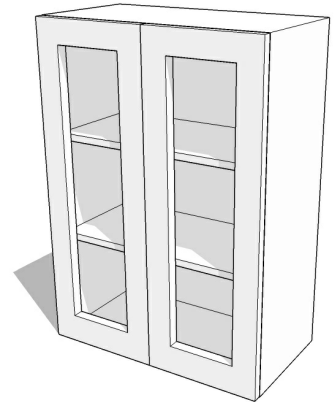
**Corner 45 degree 1 door - C45R, C45L**

Standard 13"d and 15"d
 24 and 27" width across back sides
 18 - 60" Height
 21 - 27"h = 1 adjustable shelf
 30 - 36"h = 2 adjustable shelves
 39 - 48"h = 3 adjustable shelves
 60"h = 4 adjustable shelves
 Finished interior

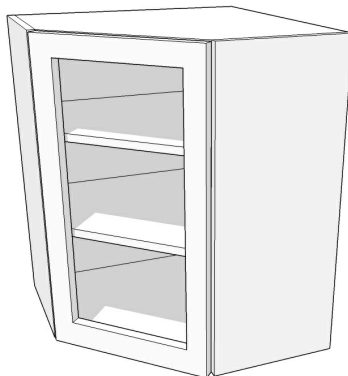
C45R - Right hinge**C45L - Left hinge****Corner 90 degree 1 door - C90R, C90L**

Standard 13"d and 15"d
 24 and 27" width across back sides
 18 - 60" Height
 21 - 27"h = 1 adjustable shelf
 30 - 36"h = 2 adjustable shelves
 39 - 48"h = 3 adjustable shelves
 60"h = 4 adjustable shelves
 Finished interior

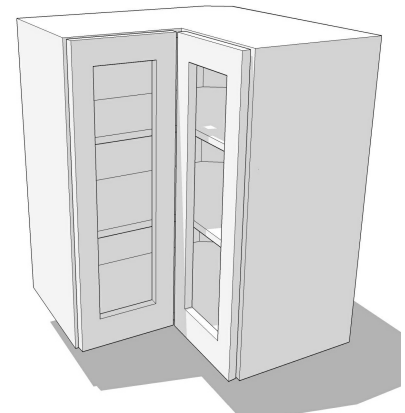
C90R - Right hinge**C90L - Left hinge****Blind corner 1 door - BC-1DBLR, BC-1DBLL**

Standard 13"d
 24 - 36" width; 24 - 60" high
 15" panel width
 24 - 27"h = 1 adjustable shelf
 30 - 36"h = 2 adjustable shelves
 39 - 48"h = 3 adjustable shelves
 60"h = 4 adjustable shelves
 Door hinges off of panel
 Finished interior

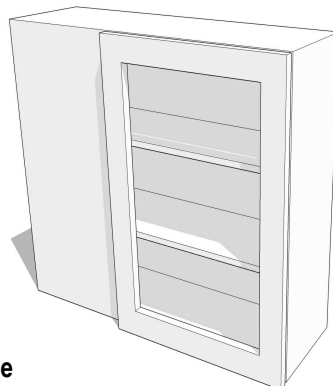
BC-1DBLR - Panel right; right hinge**BC-1DBLL - Panel left; left hinge****Blind corner 2 door - BC-2DBLR, BC-2DBLL**

Standard 13"d
 39-48" width; 24 - 60" high
 15" panel width
 24 - 27"h = 1 adjustable shelf
 30 - 36"h = 2 adjustable shelves
 39 - 48"h = 3 adjustable shelves
 60"h = 4 adjustable shelves
 Finished interior

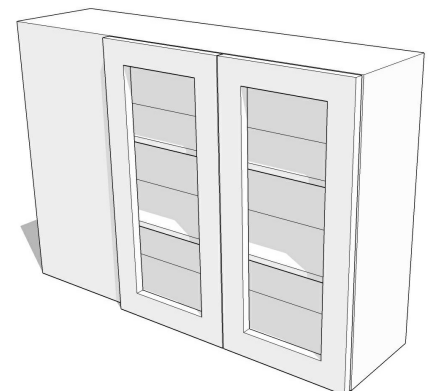
BC-2DBLR - Panel right**BC-2DBLL - Panel left**

WALL - 1 LIGHT CABINETS (PREPPED FOR GLASS PANELS)

1 door/ 1 drawer - 1D/1DrR, 1D/1DrL

Standard 13"d
 12 - 24" width
 30 - 60" height
 30"h = 1 adjustable shelf
 36 - 42"h = 2 adjustable shelves
 48 - 60"h = 3 adjustable shelves
 6"h drawer
 Finished interior
1D/1DrR - Right hinge
1D/1DrL - Left hinge

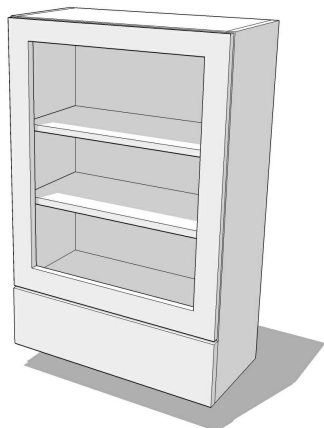
**1 door/ 1 drawer - 1D/2DrR, 1D/2DrL**

Standard 13"d
 12 - 24" width
 30 - 60" height
 30"h = 1 adjustable shelf
 36 - 42"h = 2 adjustable shelves
 48 - 60"h = 3 adjustable shelves
 6"h drawers
 Finished interior
1D/2DrR - Right hinge
1D/2DrL - Left hinge

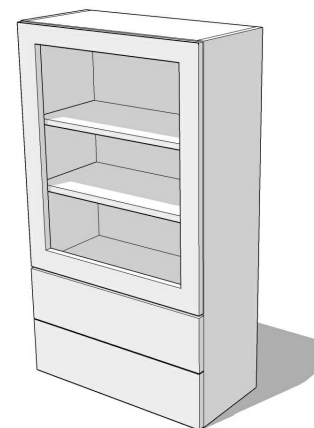
**2 door/ 1 drawer - 2D/1Dr**

Standard 13"d
 24 - 39" width
 30 - 60" height
 30"h = 1 adjustable shelf
 36 - 42"h = 2 adjustable shelves
 48 - 60"h = 3 adjustable shelves
 6"h drawer
 Finished interior

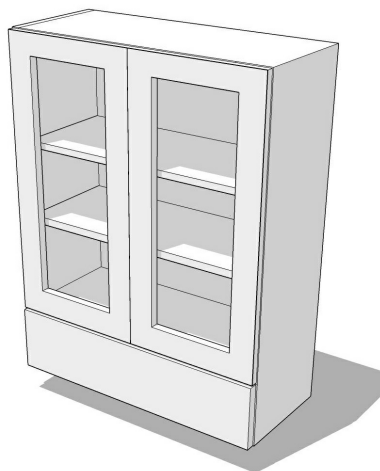
**2 door/ 1 drawer - 2D/2Dr**

Standard 13"d
 24 - 39" width
 30 - 60" height
 30"h = 1 adjustable shelf
 36 - 42"h = 2 adjustable shelves
 48 - 60"h = 3 adjustable shelves
 6"h drawers
 Finished interior

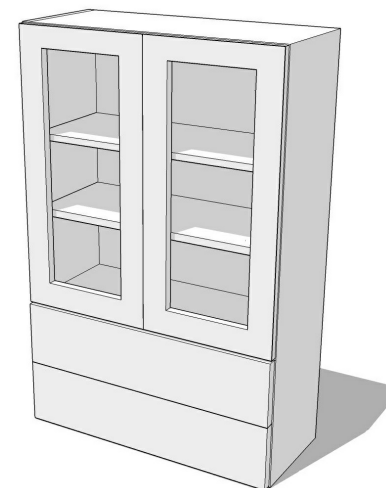
**Angled wall end 1 door - AEnd/1DR, AEnd/1DL**

Standard 13"d
 13" width
 30 - 60" height
 30 - 36"h = 2 fixed shelves
 42 - 60"h = 3 fixed shelves
 Finished interior
AEnd/1DR - Right hinge
AEnd/1DL - Left hinge

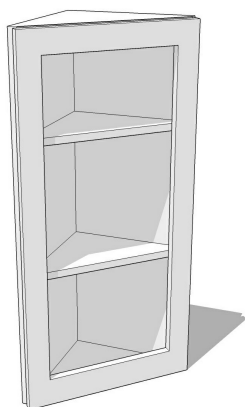
**Toilet topper 2 door - TT-2D**

24" width; 9" depth
 30, 42, 48" height
 30"h = 1 adjustable shelf
 42"h = 2 adjustable shelves
 48"h = 3 adjustable shelves
 6"h lower open section
 Finished interior

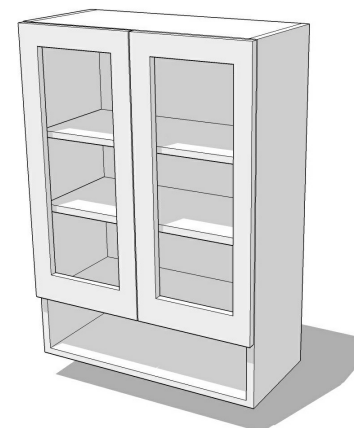

WALL - 1 LIGHT CABINETS (PREPPED FOR GLASS PANELS)

Aventos HK lift 1 door - 1DHK, 1DHKS

Standard 13"d

24 - 48" width

12 - 24" height

24"h = 1 adjustable shelf

Finished interior

**Cabinets 15" high or smaller
39" wide or smaller use 1DH
all others greater than 15" high
or 39" wide select from 1DHK**

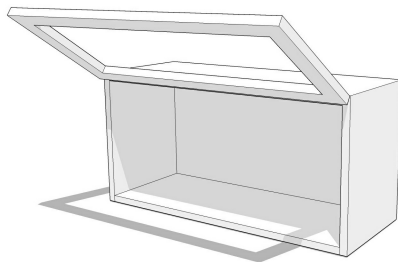
**Aventos HL lift 1 door - 1DHL**

Standard 13"d

24 - 48" width

15 - 21" height

Finished interior

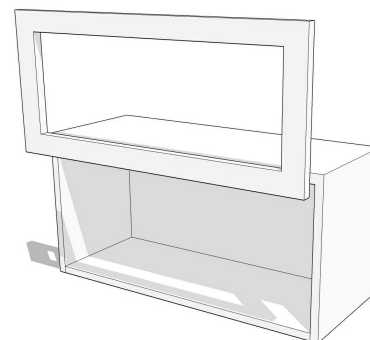
**Aventos HF lift Bi-folding door - 1DHF**

Standard 13"d

24 - 48" width

24 - 42" height

24, 27"h = 1 adjustable shelf

30 - 42"h = 2 adjustable shelves

Finished interior

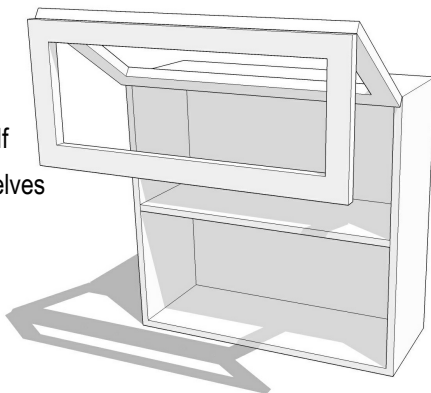

TALL CABINETS

Pantry 2 doors - 2DR, 2DL

13, 16, 21, 24" deep std.

12-24" width

84, 90, 96, 120" height

4 adjustable shelves

Lower doors 49-3/8"h standard;
non-standard configurations
available

2DR - Right hinge

2DL - Left hinge

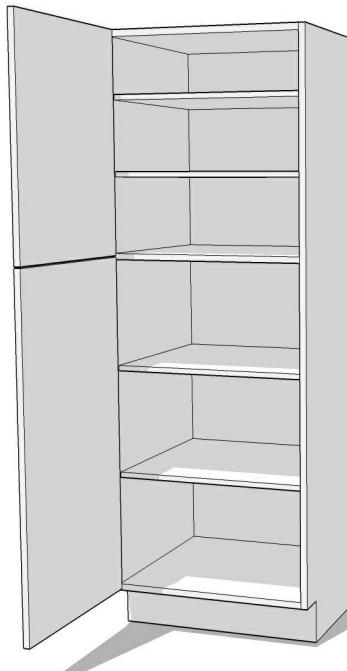
**Pantry 4 doors - 4D**

13, 16, 21, 24" deep std.

24 - 36" width

84, 90, 96, 120" height

4 adjustable shelves

Lower doors 49-3/8"h standard;
non-standard configurations
available

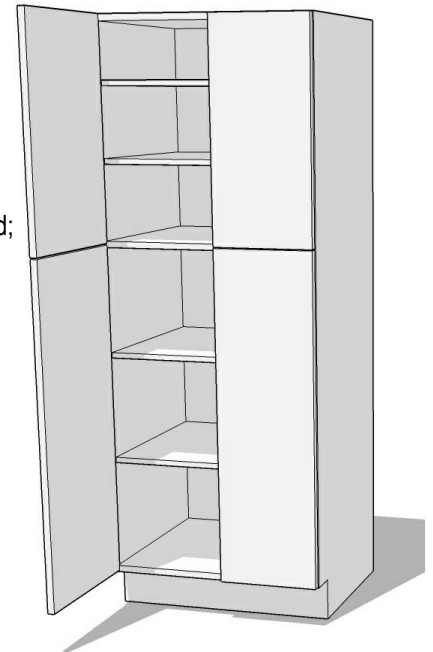
**Pantry no doors - OPEN**

13" deep std. (Increased depth
available)

12 - 48" width

84, 90, 96, 120" height

4 adjustable shelves; 1 fixed
shelf

Finished interior

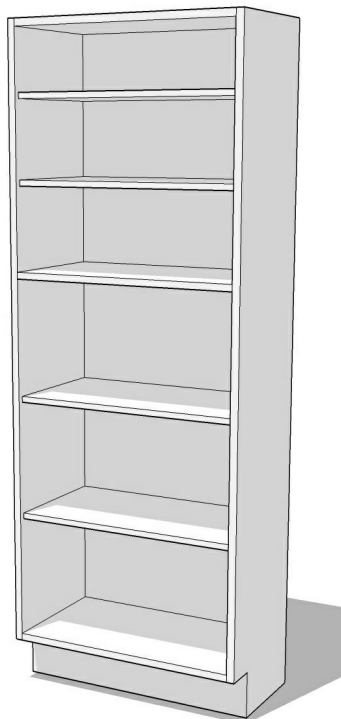
**Built-in Microwave - 4DMW**

Standard 24"d

84, 90, 96, 120" height

27 - 33" width

Frame height 22" with 2-1/4"
frame for cut-in of appliance

41-7/8"h doors below; remain-
der above frame

Open back in center section

Please provide frame opening
diagram

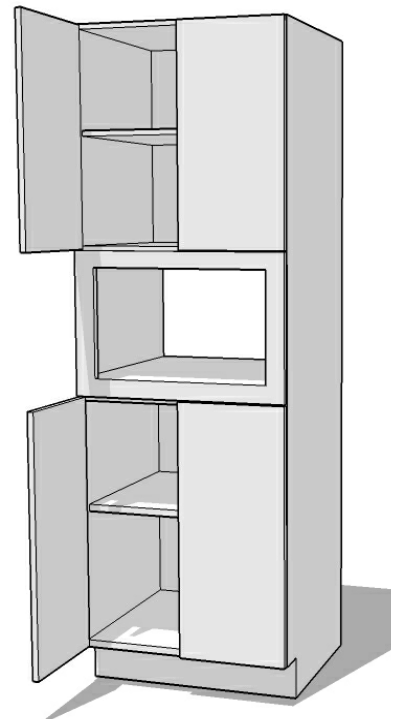

TALL CABINETS

Single oven - SOC

Standard 24"d

84, 90, 96, 120" height

27 - 33" width

Frame height 31-3/4" with 2-1/4" frame for cut-in of appliance

6"h drawer plus 23-5/8"h doors below; remainder above frame

Open back in center section

Please provide frame diagram for specific requirements

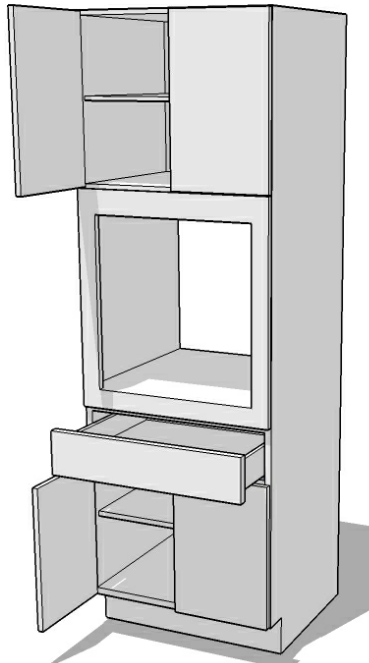
**Double oven - DOC**

Standard 24"d

27 - 33" width

84, 90, 96, 120" height

Frame height 55-3/8" with 2-1/4" frame for cut-in of appliance

6"h bottom drawer; remainder above frame

Open back in center section

Please provide frame diagram for specific requirements

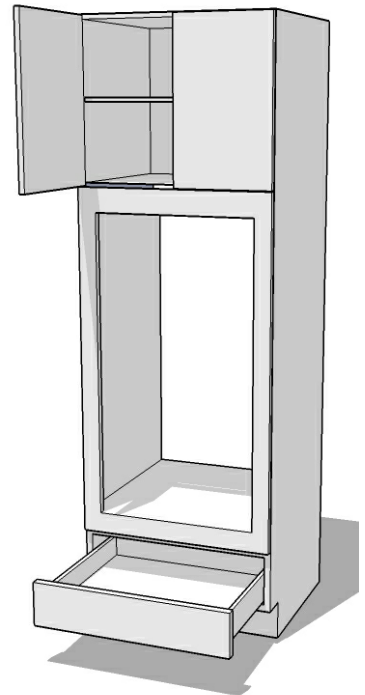
**Combination MW/oven - COC**

Standard 24"d

27 - 33" width

84, 90, 96, 120" height

Frame height 51-1/8" with 2-1/4" frame for cut-in of appliance

11-3/4"h drawer; remainder above frame

Open back in center section

Please provide frame diagram for specific requirements

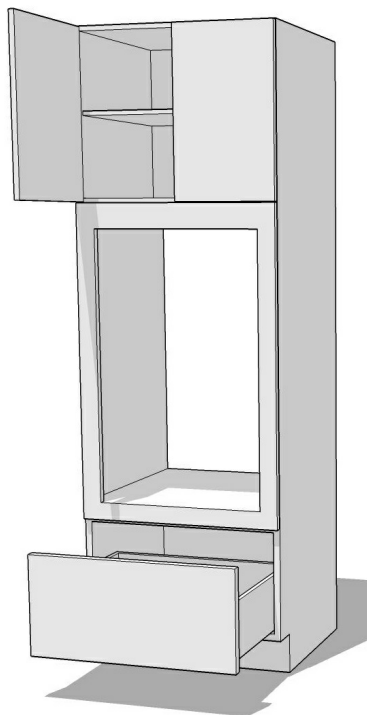

VANITY BASE CABINETS

1 full height door - 1DR, 1DL

9 - 24" width

21" depth

34-1/2, 30-3/4" height

Single adjustable shelf

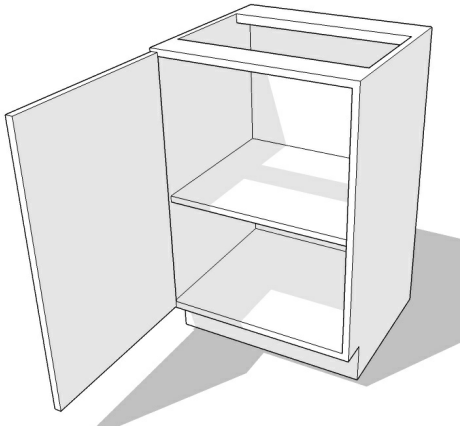
1DR - Right Hinge**1DL - Left Hinge****2 full height doors - 2D**

24 - 48" width

21" depth

34-1/2, 30-3/4" height

Single adjustable shelf

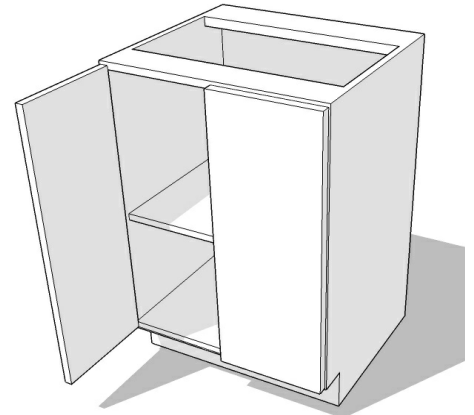
**1 door/ 1 drawer - 1D/1DrR, 1D/1DrL**

9 - 24" width

21" depth

34-1/2, 30-3/4" height

Single adjustable shelf

6"h top drawer

Single adjustable shelf

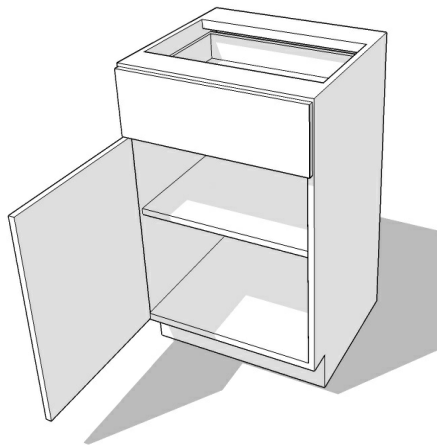
1D/1DrR - Right Hinge**1D/1DrL - Left Hinge****2 doors/ 1 drawer - 2D/1Dr**

24 - 30" width

21" depth

34-1/2, 30-3/4" height

Single adjustable shelf

6"h top drawer

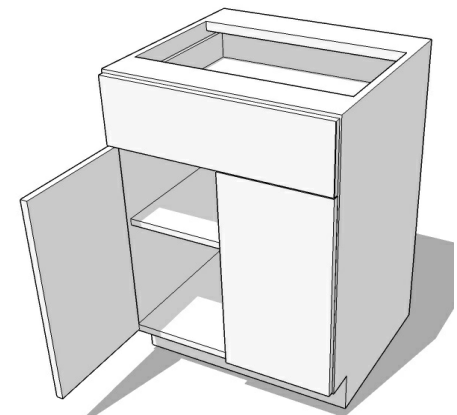
**2 doors/ 2 drawers - 2D/2Dr**

27 - 48" width

21" depth

34-1/2, 30-3/4" height

Single adjustable shelf

6"h top drawers

Full lower divider in cabinets

40" and wider

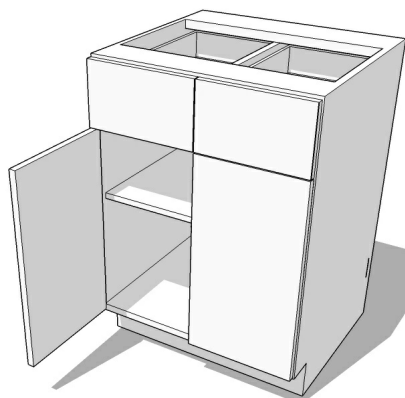
**3 drawers - 3Dr**

9 - 36" width

21" depth

34-1/2, 30-3/4" height

6" top drawer

Equal drawers below

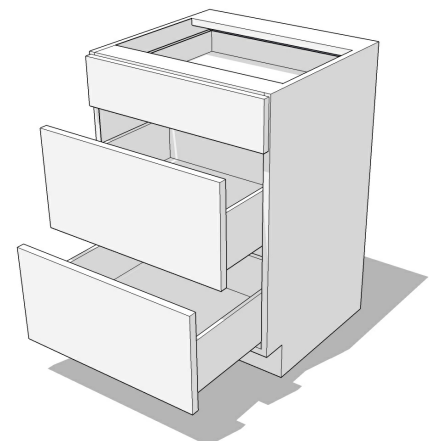

VANITY BASE CABINETS

4 drawers - 4Dr

9 - 36" width

21" depth

34-1/2, 30-3/4" height

6"h top and 2 middle drawers

11-5/16" bottom drawer

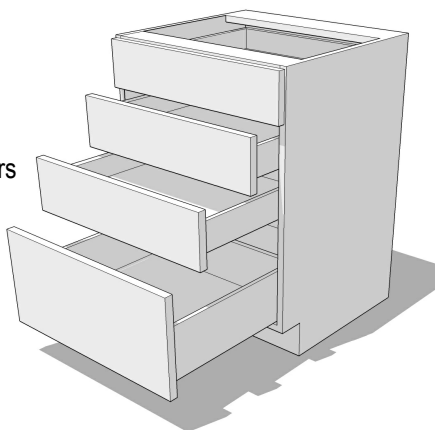
**File 2 drawers - File-2Dr**

15 - 36" width

30-3/4" height

21" deep

Equal file drawers

(15"w = letter, 18"w = legal, all others = lateral)

Cut down height may require reduced height toe kick for files to fit

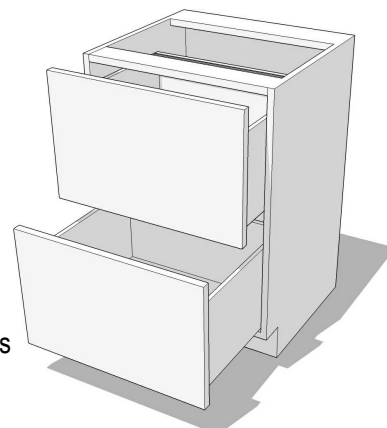
**File 3 drawers - File-3Dr**

15 - 36" width

30-3/4" height

21" deep

6"h top and middle drawer

File drawer below

(15"w = letter, 18"w = legal, all others = lateral)

Cut down height may require reduced height toe kick for files to fit

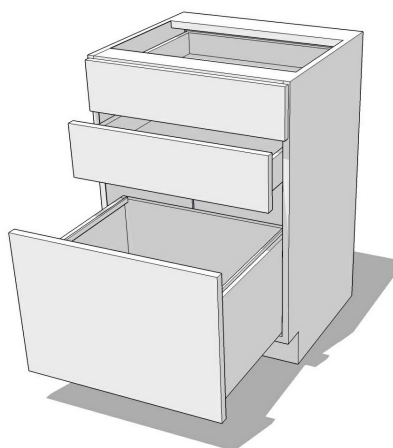
**Desk knee drawer - KneeDr**

12 - 39" width

21" deep; select 24" deep in **BASE** category

5"h drawer

6"h drawer

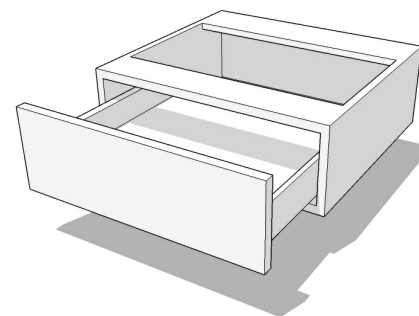
**Wall Hung 1 full height door - Wallhung1DR, Wallhung1DL**

9 - 24" width

24" height

21" depth

Solid 3/4" back

Single adjustable shelf

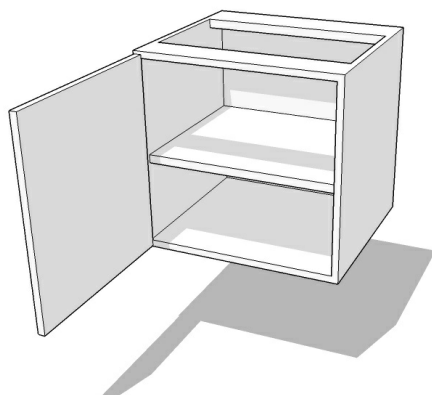
Wallhung1DR - Right Hinge**Wallhung1DL - Left Hinge****Wall Hung 2 full height doors - Wallhung2DR**

24 - 48" width

24" height

21" depth

Solid 3/4" back

Single adjustable shelf

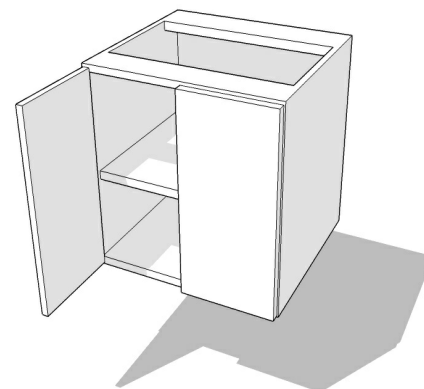

VANITY BASE CABINETS

Wall Hung 1 door/1 drawer- Wallhung1D/1DrR, Wallhung1D/1DrL

9 - 24" width

24" height

21" depth

Solid 3/4" back

6"h top drawer

Single adjustable shelf

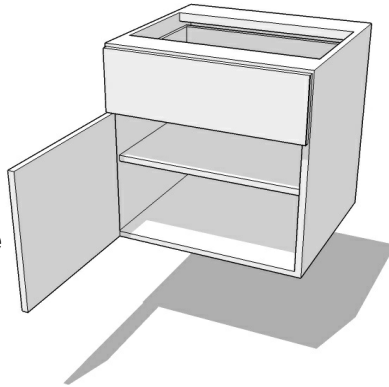
Wallhung1D/1DrR - Right Hinge**Wallhung1D/1DrL - Left Hinge****Wall Hung 2 doors/1 drawer- Wallhung2D/1Dr**

24 - 30" width

24" height

21" depth

Solid 3/4" back

6"h top drawer

Single adjustable shelf

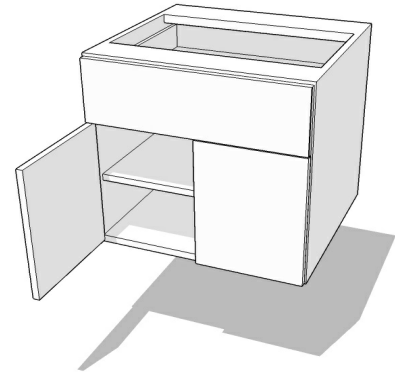
**Wall Hung 2 doors/2 drawers- Wallhung2D/2Dr**

27 - 48" width

24" height

21" depth

Solid 3/4" back

6"h top drawers

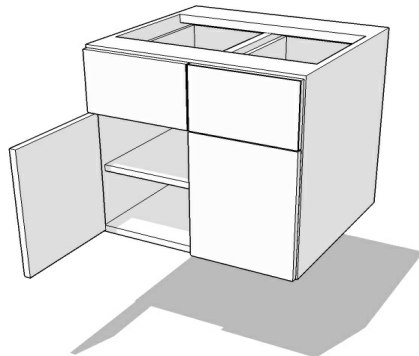
Full depth partition at 40"
and wider**Wall Hung 2 drawers - Wallhung2Dr**

9 - 36" width

21" depth

24" height

Solid 3/4" back

Equal drawers

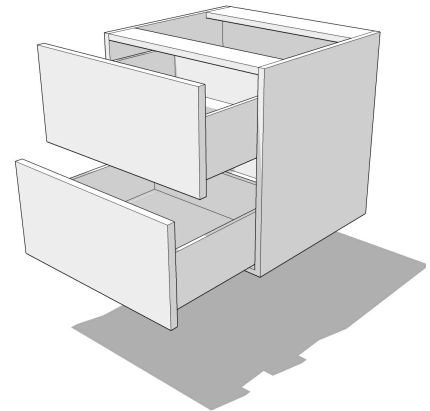
**Wall Hung 3 drawers - Wallhung3Dr**

9 - 36" width

21" depth

24" height

Solid 3/4" back

6"h top drawer

Equal drawers below

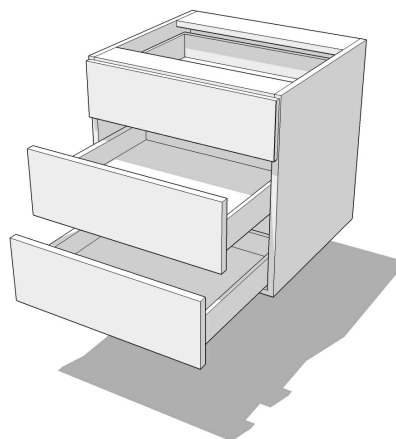

VANITY SINK BASE CABINETS

Vanity Sink 1 door - 1DR, 1DL

18 - 24" width
21" depth
34-1/2, 30-3/4" height
1DR - Right hinge
1DL - Left hinge

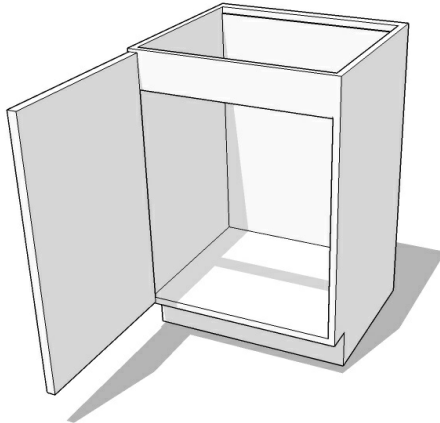

Vanity Sink 2 doors - 2D

24 - 48" width
21" depth
34-1/2, 30-3/4" height

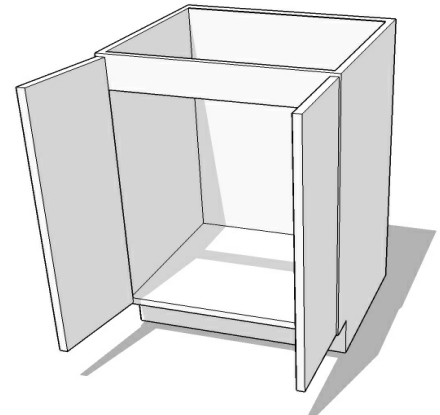

Combo Sink 2 doors/ 1 drawer reverse - 2D/1DRREV

24 - 36" width
21" depth
34-1/2, 30-3/4" height
6"h bottom drawer

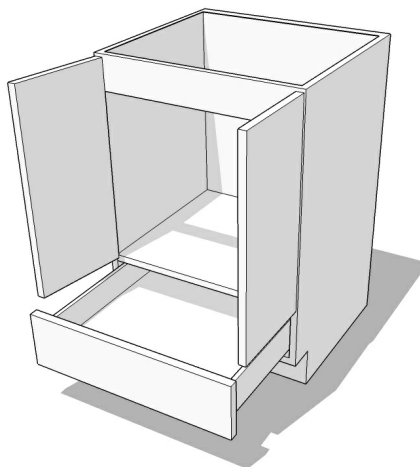

Vanity Sink 1 door/ 1 false front - 1D/1FR, 1D/1FL

18 - 24" width
21" depth
34-1/2, 30-3/4" height
6"h top false front
1D/1FR - Right hinge
1D/1FL - Left hinge

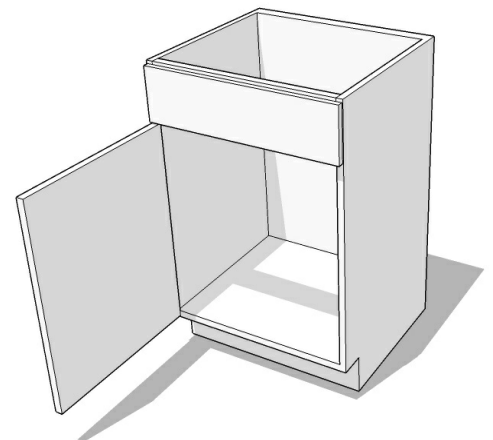

Combo Sink 1 door/2 drawers/1 false front - 1D/2Dr/1FR, 1D/2Dr/1FL

27 - 36" width
21" depth
34-1/2, 30-3/4" height
6"h top false front
Equal drawers below
27 = 9" wide drawers; 18" wide door
30 = 12" wide drawers; 18" wide door
33 = 12" wide drawers; 21" wide door
36 = 15" wide drawers; 21" wide door
1D/2Dr/1FR - Doors right, right hinge
1D/2Dr/1FL - Doors left, left hinge

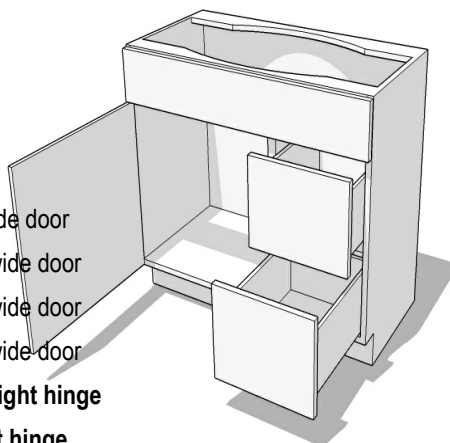

Vanity Sink 2 doors/ 1 false front - 2D/1F

24-48" width
21" depth
34-1/2, 30-3/4" height
6"h top false front

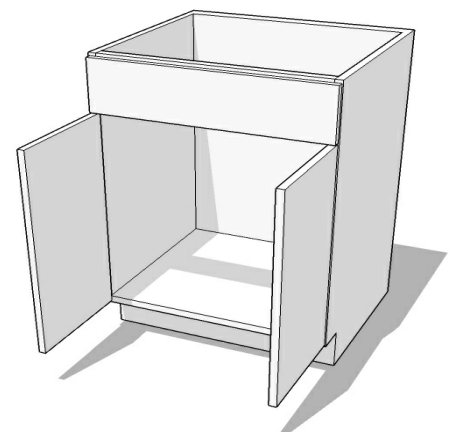

VANITY SINK BASE CABINETS

Combo Sink 2 doors/ 2 drawers/ 1 false front - 2D/2Dr/1F

36 - 48" width

21" depth

34-1/2, 30-3/4" height

6"h top drawer/ false front

36 = 9" drawers; 18" false front

39 = 9" drawers; 21" false front

42 = 9" drawers; 24" false front

45 = 12" drawers; 21" false front

48 = 12" drawers; 24" false front

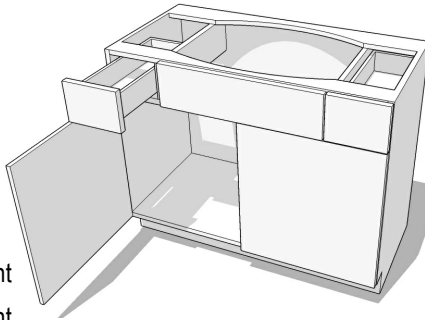
**Combo Sink 2 doors/ 2 drawers/ 2 false front - 2D/2Dr/2F-DR, 2D/2Dr/2F-DL**

39 - 48" width

21" depth

34-1/2, 30-3/4" height

6"h top false fronts

Equal drawers below

39 = 12" drawers; 27" doors

42 = 12" drawers; 30" doors

45 = 15" drawers; 30" doors

48 = 18" drawers; 30" doors

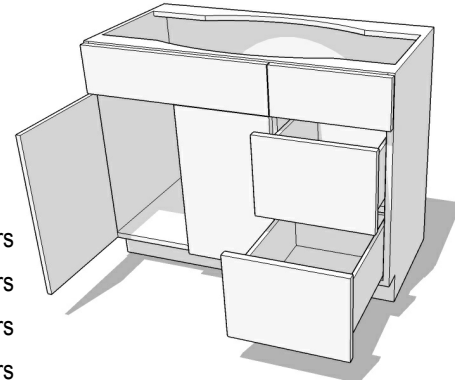
2D/2Dr/2F-DR - doors right; 2D/2Dr/2F-DL - doors left**Vanity Sink 2 drawers - 2Dr**

24 - 39" width

34-1/2, 30-3/4" height

Equal drawers

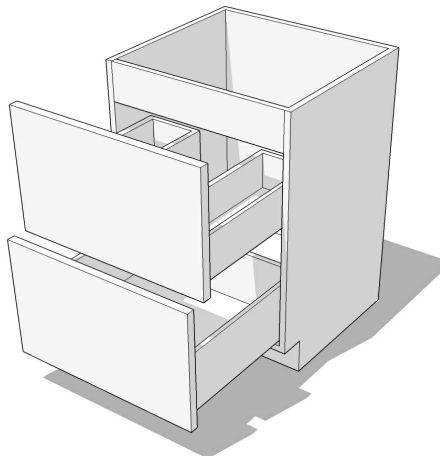
Pipe chase drawer cut
outs included; please
specify cut out sizing**Vanity Sink 2 drawers/ 1 false front - 2Dr/1F**

24 - 39" width

34-1/2, 30-3/4" height

6"h top false front

Equal drawers below

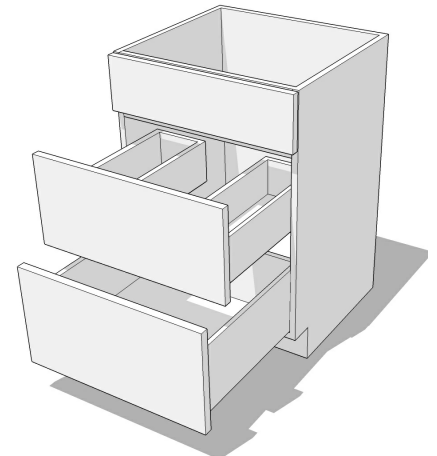
Pipe chase drawer cut
outs included; please
specify cut out sizing**Wall Hung Sink 1 door - Wallhung1DR, Wallhung1DL**

9 - 24" width

21" depth

24" height

3/4" solid back

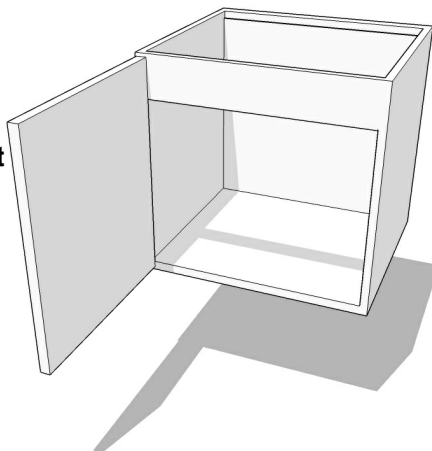
Wallhung1DR - hinge right**Wallhung1DL - hinge left****Wall Hung Sink 2 doors - Wallhung2D**

24 - 48" width

21" depth

24" height

3/4" solid back

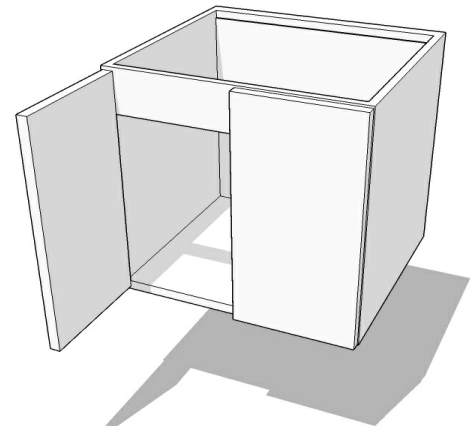

VANITY SINK BASE CABINETS

Wall Hung Sink 1 door - Wallhung1D/1FR, Wallhung1D/1FL

18 - 24" width

21" depth

24" height

6"h false front

3/4" solid back

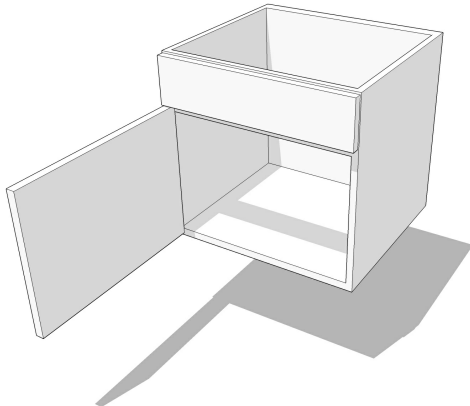
1DR - Right hinge**1DL - Left hinge****Wall Hung Sink 2 doors/ 1 false front - Wallhung2D/1F**

24 - 48" width

21" depth

24" height

6"h false front

3/4" solid back

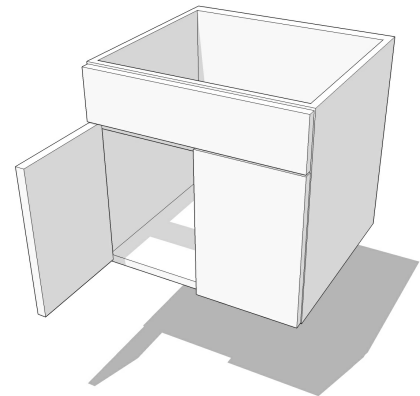
**Wall Hung Sink 2 drawers - Wallhung2Dr**

24 - 39" width

24" height

Equal drawers

3/4" solid back

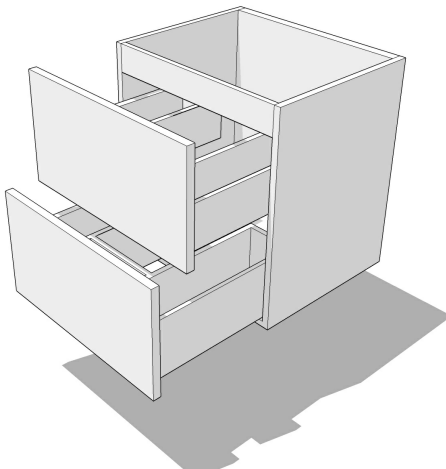
Pipe chase drawer cut
outs included; please
specify cut out sizing**Wall Hung Sink 2 drawers/ 1 false front - Wallhung2Dr/1F**

24 - 39" width

24" height

6"h top false front

Equal drawers below

3/4" solid back

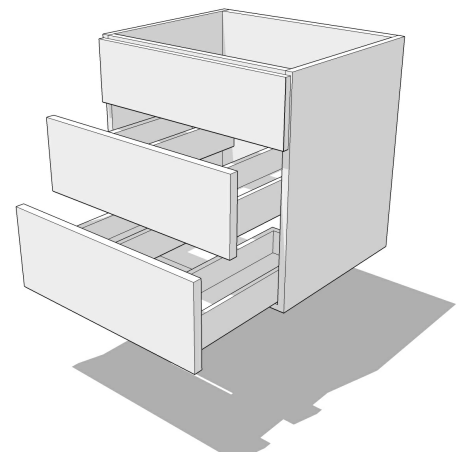
Pipe chase drawer cut
outs included; please
specify cut out sizing**Wall Hung Combo Sink 1 door/2 drawers/1 false front - Wallhung1D/2Dr/1FR, Wallhung1D/2Dr/1FL**

27 - 36" width

21" depth

24" height

6"h top false front

Equal drawers below

27 = 9" drawers; 18" door

30 = 12" drawers; 18" door

33 = 12" drawers; 21" door

36 = 15" drawers; 21" door

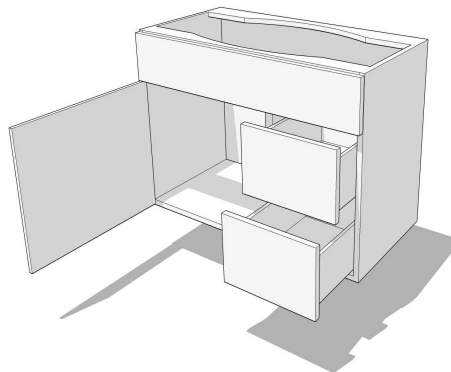
Wallhung1D/2Dr/1FR - Doors right, right hinge**Wallhung1D/2Dr/1FL - Doors left, left hinge****Wall Hung Combo Sink 2 doors/ 2 drawers/ 1 false front - Wallhung2D/2Dr/1F**

36 - 48" width

21" depth

24" height

6"h top drawer/ false front

36 = 9" drawers; 18" false front

39 = 9" drawers; 21" false front

42 = 9" drawers; 24" false front

45 = 12" drawers; 21" false front

48 = 12" drawers; 24" false front

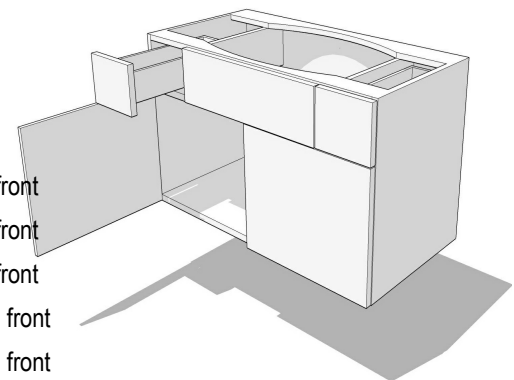

VANITY SINK BASE CABINETS

Furniture Vanity Sink Base 1 Drawer - FURN1Dr

24 - 42" width

21" depth

34-1/2" height

8"h top drawer

Std 12 x 12 plumbing chase cut out in drawer - can be modified.

24" cabinet width may require vessel sink to accommodate drawer

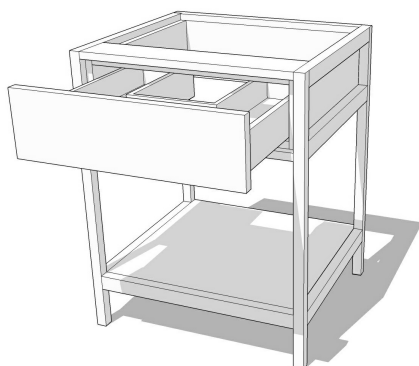

Furniture Vanity Sink Base 2 Drawers - FURN2Dr

48 - 72" width

21" depth

34-1/2" height

8"h top drawers

Std 12 x 12 plumbing chase cut out in drawers - can be modified.

48" cabinet width may require vessel sink to accommodate drawers

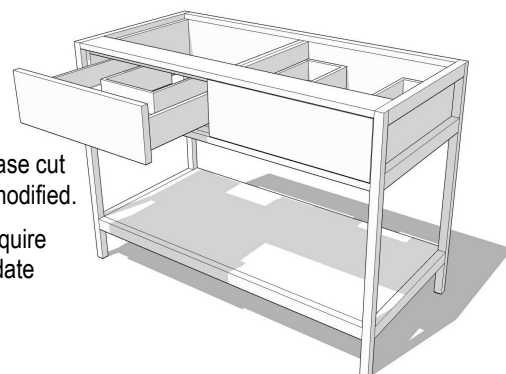

FILLERS

Flat Filler - F3, F6, F8

3/4" Finished 1 face plywood
Matching edgeband all edges (except 3" edges)
3", 6" and 8" widths
12 - 96" heights (inquire about availability above 96" tall)
Cut full width and full height
Minimum may apply to custom width

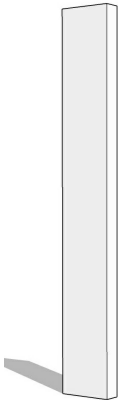

Overlay Profile Filler - OF3, OF6, OF8

3/4" Finished hardwood or door matching material
Matching edge profile to door style selected
3", 6" and 8" widths
12 - 96" heights (120" available in solid wood species)
Cut full width and full height - if door matching height is required, please order as a custom height specified in column I
Minimum may apply to custom width

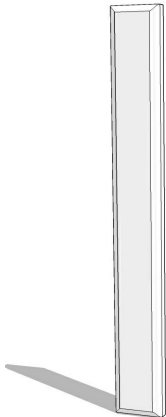

PANELS

Base End Panel 3/4" - BEP3/4

3/4" Finished plywood
24" depth; 34.5" height
Select 1 side or 2 side finished
Finished front banded edge
Reversible Right or Left side finish orientation
Available unfinished

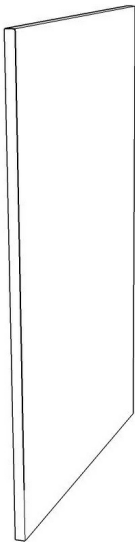

Base End Panel - BEP

3" width (can be reduced to 1.5"-3" width)
24" depth; 34.5" height
Finished side and 6" return included with finished front face
Reversible Right or Left side finish orientation
Available unfinished side (BEP) combine with finished overlay filler front

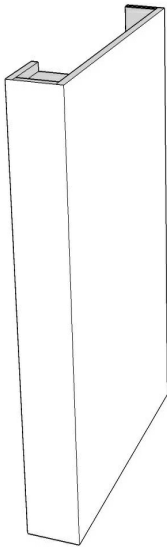

Wall End Panel 3/4" - WEP3/4

3/4" Finished plywood
13" depth
30 - 60" height
Select 1 side or 2 side finished
Finished banded edges
reversible Right or Left

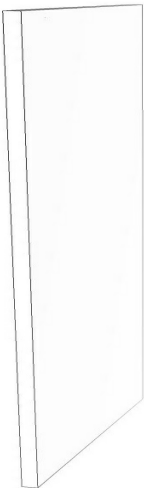

Wall End Panel - WEP

3" width (can be reduced to 1.5"-3" width)
13" depth
30 - 60" height
Finished side included with finished front face, top, bottom and 3" return
reversible Right or Left

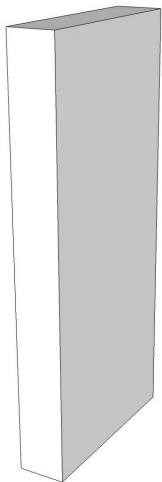

PANELS

Tall Refrigerator End Panel 3/4" - REP3/4

3/4" Finished plywood
24" depth; 96 - 120" height
Select 1 side or 2 side finished
Finished front banded edge
Reversible Right or Left side finish orientation



Tall Refrigerator End Panel - REP

3" width (can be reduced to 1.5"-3" width)
24" depth; 96 - 120" height
Finished side and 6" return included with finished front face
Reversible Right or Left side finish orientation

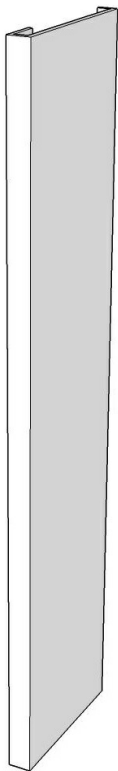

Base panel and Tall panel construction detail

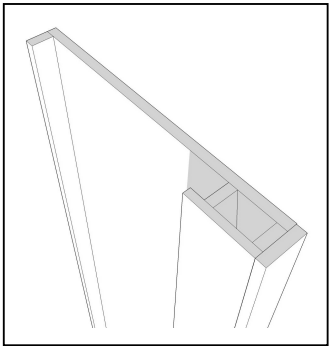

Wall panel construction detail

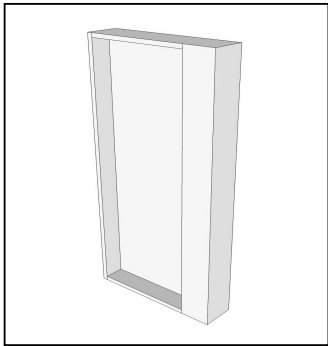

Some Some Tall Panels may be limited in height to 96" - 108" due to available material length required

PLYWOOD

Finished Plywood

Toe Kick cover - 1/4" x 4-1/2" x 96" and 3/4" x 4-1/2" x 96"

3/4" cut-to-size finished plywood (Select from finished 1 side and finished 2 side):

12 x 36	18 x 36	24 x 36	30 x 36	36 x 36	48 x 36
12 x 48	18 x 48	24 x 48	30 x 48	36 x 48	48 x 48
12 x 72	18 x 72	24 x 72	30 x 72	36 x 72	48 x 72
12 x 96	18 x 96	24 x 96	30 x 96	36 x 96	48 x 96

1/4" cut-to-size finished plywood:

24 x 96
48 x 36
48 x 48
48 x 96
96 x 48 cross grain

1/4" cut-to-size Bead Board finished plywood:

24 x 96
48 x 36
48 x 48
48 x 96

Finished veneer:

24 x 96
48 x 96

Cut-to-size finished plywood components are not edgebanded. If finished edges are required, please note in "special Instructions" when ordering and specify which edges are to be finished. Finished edges are not available on 1/4" plywood parts.

3/4" toe kick covers are finished on the ends.

DECORATIVE OVERLAY END PANELS

Deco Base Panel - DBP

24-7/8" x 34-1/2"

Wide bottom rail to match adjoining doors
 Square top and bottom edge
 L034 vertical edges
 DBP not available in Mitered door styles

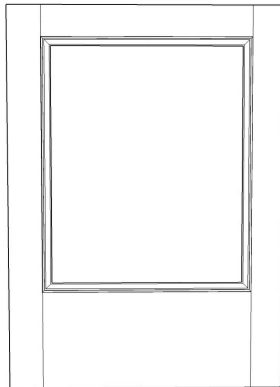
**Deco Base Panel No Toe Kick - DBPNT**

24-7/8" x 30"

Uniform bottom rail to match adjoining doors
 If matching reveals are required please modify sizing in the "custom dimensions" columns provided
 L149 edge detail top and bottom
 L034 edge detail vertical edges

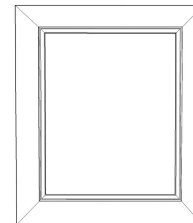
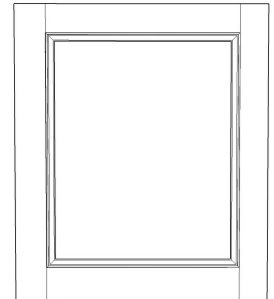
**Deco Base Panel Mitre - DBPNT****Deco Wall Panel - DWP**

13-7/8, 18, 24-7/8" widths

30, 36, 42, 48, 60" heights

If matching reveals are required please modify sizing in the "custom dimensions" columns provided
 L149 edge detail top and bottom
 L034 edge detail vertical edges

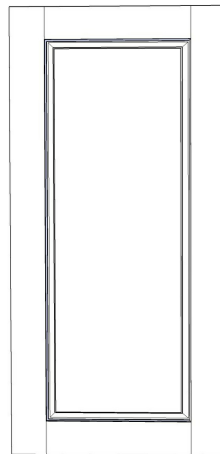
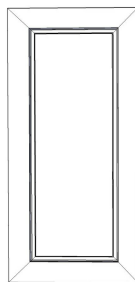
**Deco Wall Panel Mitre - DWP****Deco Wainscot Panel - DWCP**

Select from 36 and 42" height - modifiable to custom height
 (30" height would not have wide bottom rail)

Wide bottom rail to match adjoining doors
 DWCP not available in Mitered door styles
 Square top and bottom edge; L034 vertical edges

30, 36, 48 width - 2 panel

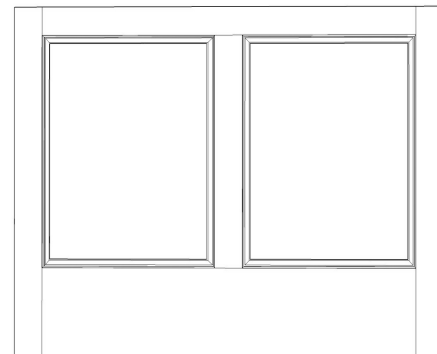

60, 72" width - 3 panel

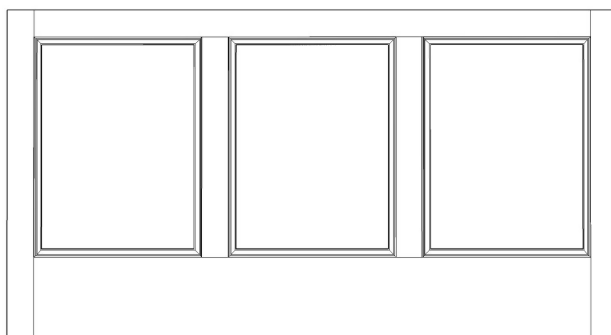

84, 96" width - 4 panel

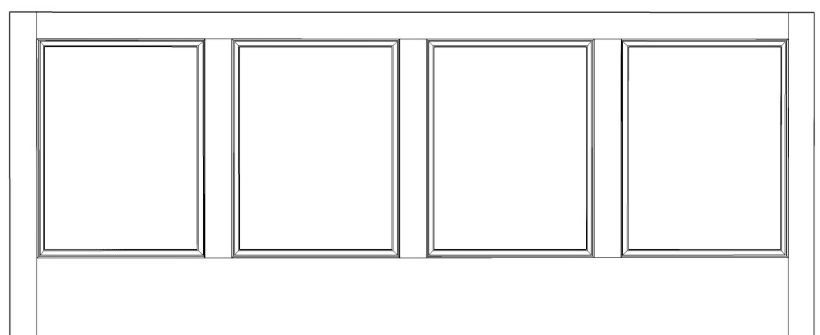

DECORATIVE OVERLAY END PANELS

Deco Tall Panel - DTP
24-7/8" width
79-1/2, 85-1/2, 91-1/2, 114-1/2" height - standard bottom rail
84, 90, 96, 120" - wide bottom rail
114-1/2" and 120" height will be made in 2 parts
L149 top and bottom edge; L034 vertical edges
Mid rail centers to match where front doors meet

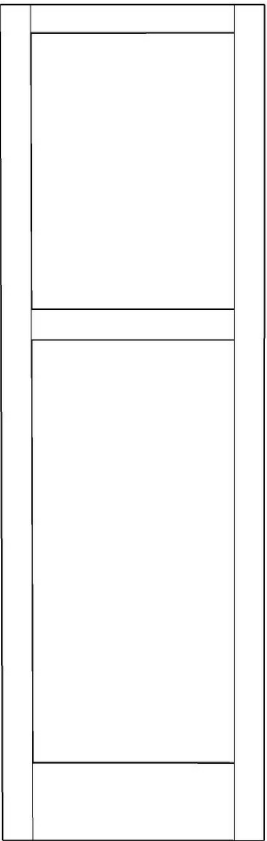
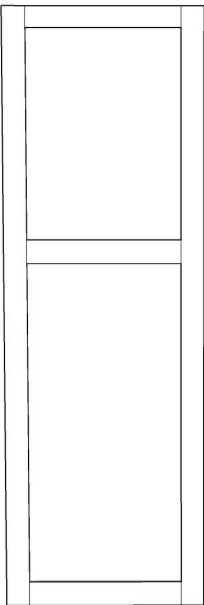

Deco Tall Panel - without Toe Kick
Also available in most mitered
frame door styles. Some styles
may require split door.

Deco Appliance Panels - Appliance
Custom sized appliance deco panels may be ordered to match
door selection. Catalog sizes represent approximations of com-
mon sizes. Please select the closest size from the list that would
approximate the required panel size and type the actual size di-
mensions in the custom dimension columns.

- Catalog sizes:
- | | |
|-----------|-----------|
| 24h x 36w | 48h x 18w |
| 24h x 42w | 70h x 20w |
| 24h x 48w | 70h x 25w |
| 10h x 36w | 30h x 24w |
| 10h x 42w | |
| 10h x 48w | |

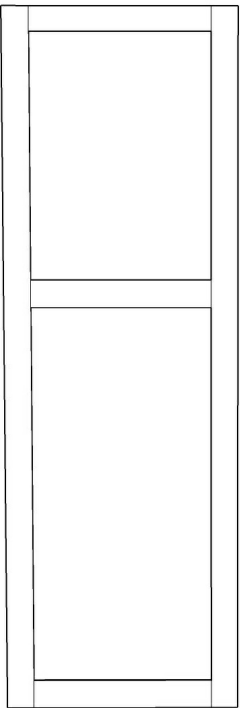
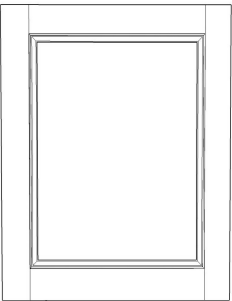

VALANCES

Arched Raised Valance

Limited matching framing and profile shapes to doors
Catalog sizes (custom sizes available in 3" widths increments only)
Rise is always 4-1/2"

- 36w x 13h
- 42w x 13h
- 48w x 18h
- 54w x 18h
- 60w x 18h

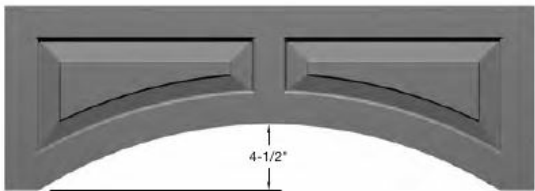

1-Piece Valances

6" height
36 - 60" width
Custom sizes available
Rise is always 3"h
Square edge detail all edges

For Toe Kick Valance please specify height to be 4-1/2"

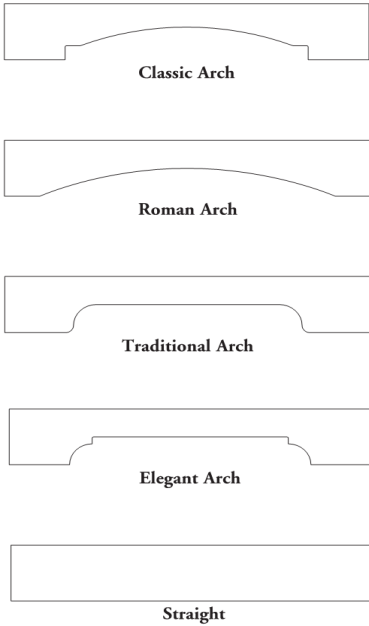

CROWN MOULDING

Contemporary Crown

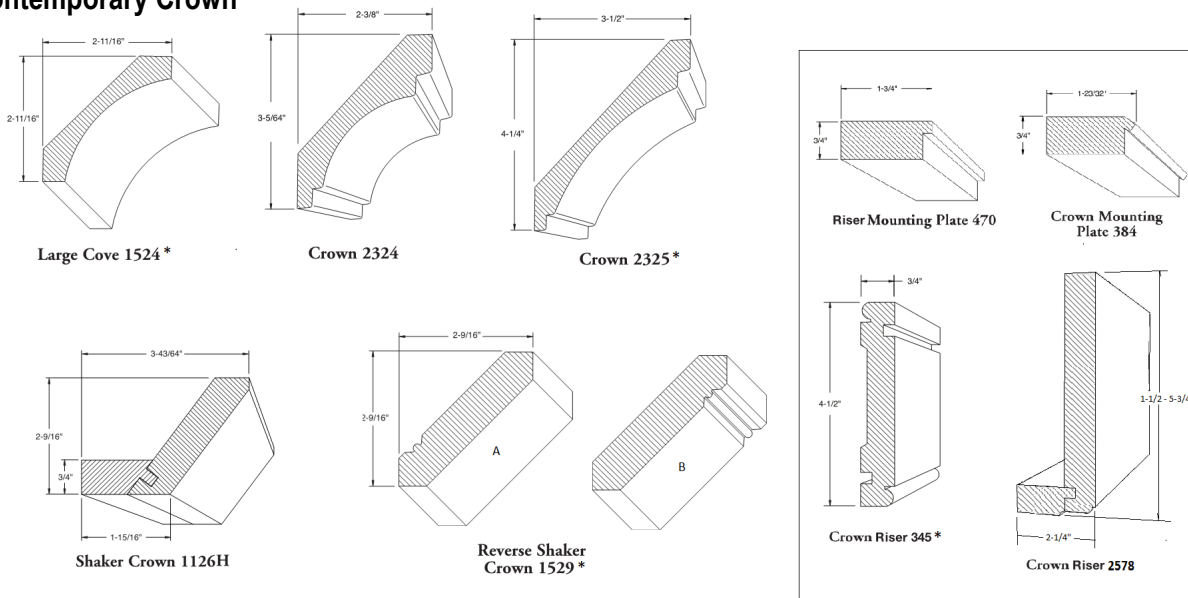

Traditional Crown

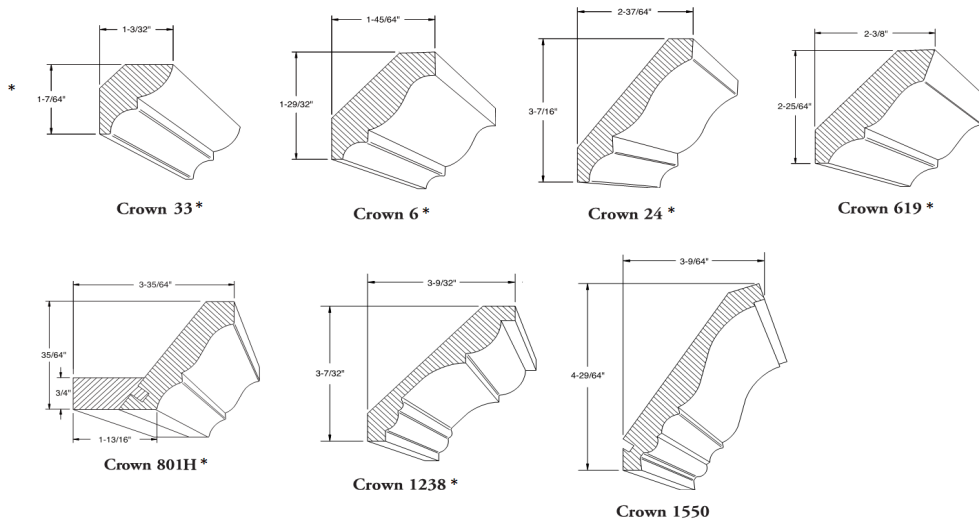

Insert Crown (and inserts)

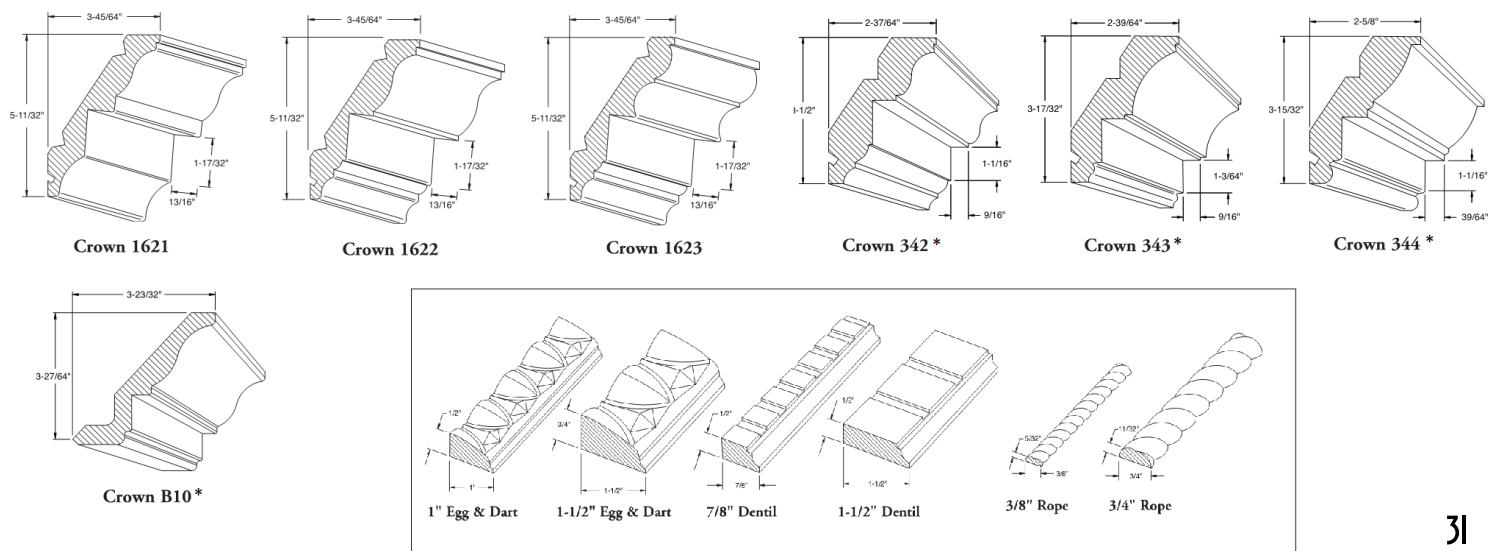

TRIM

Base

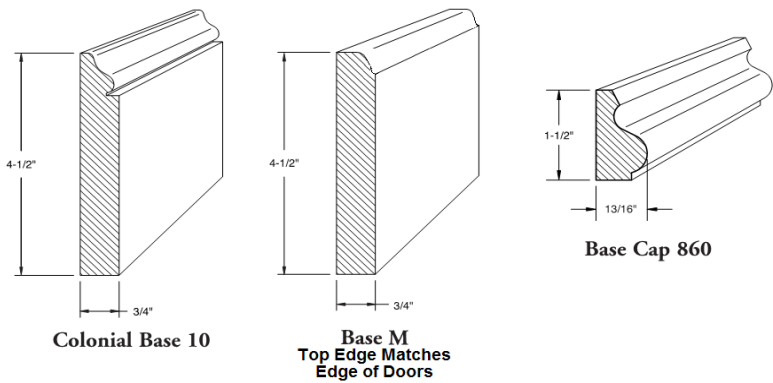

Light Rail

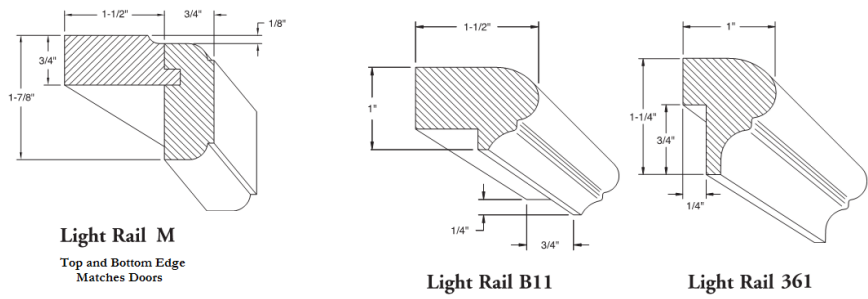

Small Trim

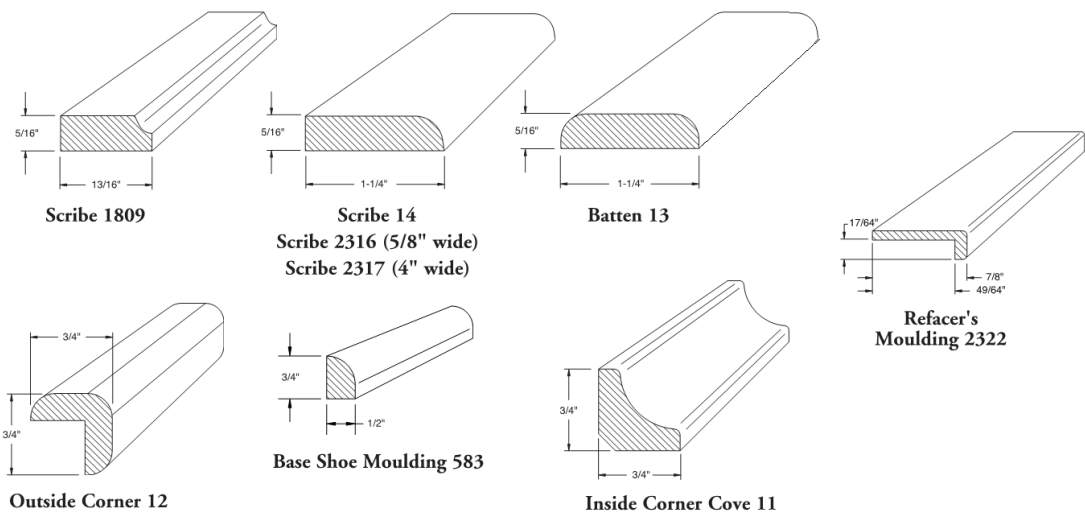

MOULDING

DLV Trim

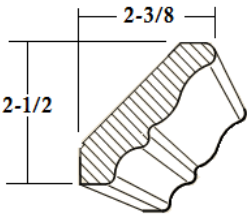

Traditional Crown

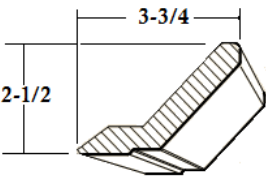

Shaker Crown w/Heel

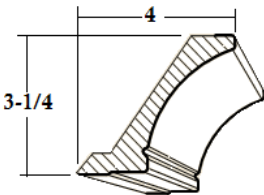

Cove Crown w/ Heel

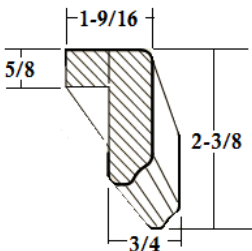

Light Rail w/ Heel

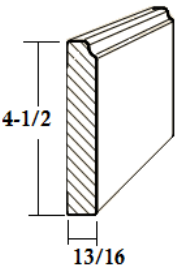

Base

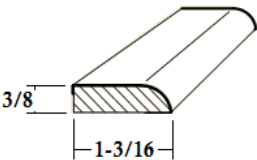

Scribe

Capri/ Nova/ Enzo Trim

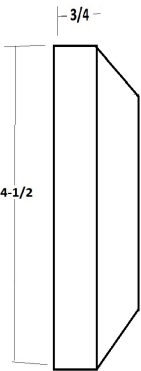

Base

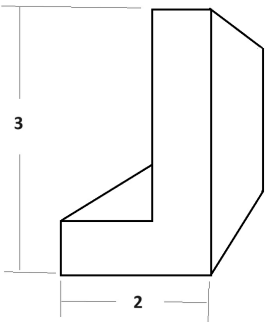

Top Trim

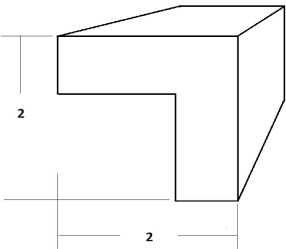

Light Rail

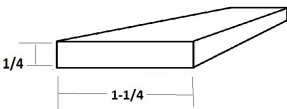

Scribe

HOOD ENCLOSURES

Artisan

- Complete turnkey solution with patented hanging cleat for quick and easy installation.
- Manufactured from solid wood and wood veneers.
- Includes chimney, allows 12" to be trimmed.
- Includes silver metallic powder-coated liner.
- Liner accommodates the following Broan ventilators:
250 CFM - RHVBF10SM
390 CFM - RHVBB20SM
500 CFM - RHVBB30SS
1100 CFM - RHVBHLB11
- 36, 42, 48" widths
- **Custom sizes not available.**

Available in Cherry, Maple, Paint Grade

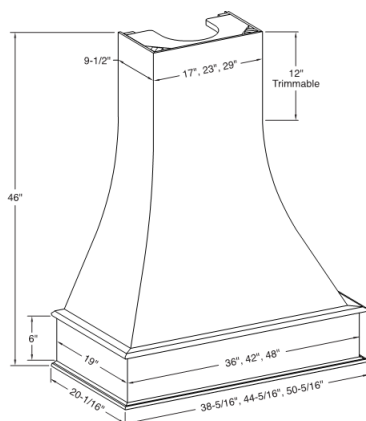

Euro

- Contemporary wall-mounted hood with patented hanging cleat for quick and easy installation.
- Manufactured from solid wood and plywood.
- Includes 23-1/2" trimmable chimney.
- Includes silver metallic powder-coated liner.
- Liner accommodates the following Broan ventilators:
250 CFM - RHVBF10SM
390 CFM - RHVBB20SM
500 CFM - RHVBB30SS
1100 CFM - RHVBHLB11
- 30, 36, 42" widths
- **Custom sizes not available.**

Available in Cherry Maple, Paint Grade

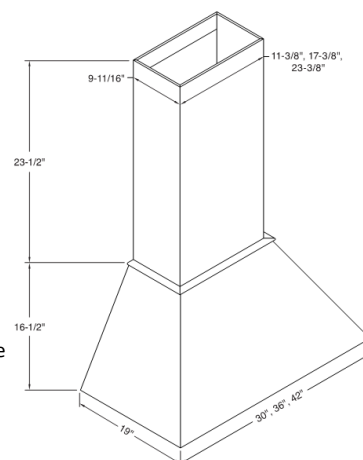

Contemporary Standard - CHW

- CHW-Series is a contemporary hood.
- Adapts well to various ceiling heights.
- Horizontal grain panel and valance only.
- 6" hardwood valance in matching specie only.
- Fixed panel standard. Removal panel optional.
- Standard sizes: 30", 36", 42", 48", 54" and 60" widths; 24", 30", 36", 48" and 54" heights.
- **Custom sizes available through Special Designs.**

Available in Alder, Cherry, Maple, Paint Grade and White Oak

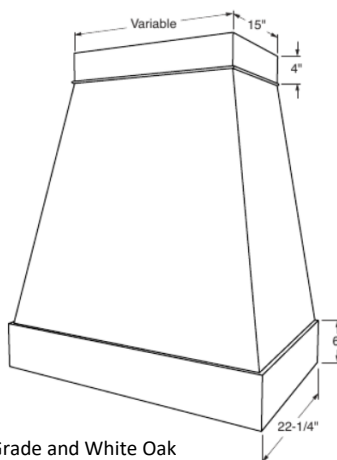

Contemporary Shiplap - CHWB

- CHWB-Series is a shiplap style hood.
- Adapts well to various ceiling heights.
- Horizontal grain only with shiplap style beading.
- 6" hardwood valance in matching specie only.
- Standard sizes: 30", 36", 42", 48", 54" and 60" widths; 24", 30", 36", 48" and 54" heights.
- **Custom sizes available through Special Designs.**

Available in Alder, Cherry, Maple, Paint Grade and White Oak

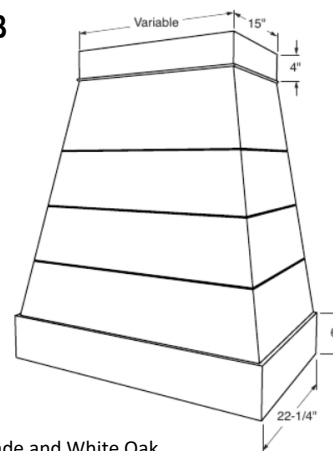

BX - Box Hood

BXB - Beaded Shiplap Box Hood

- **BXB** is a shiplap hood.
- Adapts well to various ceiling heights.
- Horizontal grain only with shiplap style beading.
- Fixed panel only.
- Standard sizes: 30", 36", 42", 48", 54" and 60" widths; 24", 30", 36" and 42" heights.
- **Custom sizes available through Special Designs.**

Available in Alder, Cherry, Maple, Paint Grade and White Oak

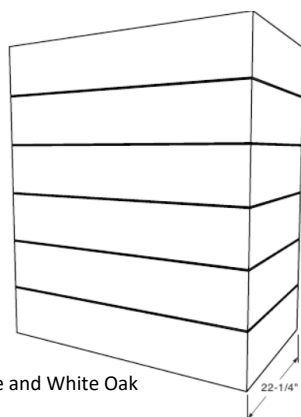

Mantle Standard - S

- Display shelf depth is 6-1/8" to tip of moulding.
- Lead-time 10 days unfinished, add 7 days for finish.
- Removable panel only.
- Available in Alder, Cherry, Hard Maple, PGHM Hy Red Oak, Walnut and Quarter Sawn White Oak.
- Custom sizes available through Special Designs.
- **Custom sizes available through Special Designs.**

Available in Alder, Cherry, Maple, Paint Grade and White Oak

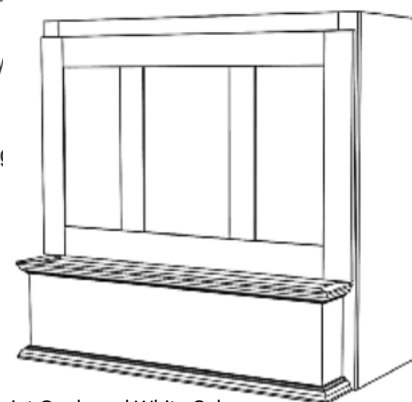

CORBELS

Chandler

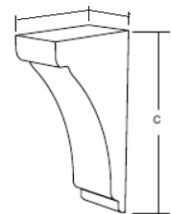

Dimension		
A	B	C
1-3/4"	4"	7-3/16"
1-3/4"	5"	9"
1-3/4"	5-1/2"	10-5/8"
1-3/4"	8"	14-5/32"
3"	4"	7-3/16"
3"	5"	9"
3"	5-1/2"	10-5/8"
3"	8"	14-5/32"

Cimarron

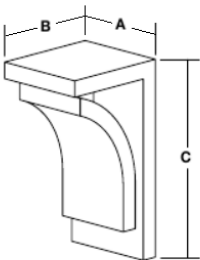

Dimension		
A	B	C
2-7/8"	3"	6"
4-1/4"	5"	9"
2-7/8"	9"	12"

Concord

Dimension		
A	B	C
1-3/4"	1-1/2"	3"
1-3/4"	4"	6-1/2"
1-3/4"	5"	8-1/16"
1-3/4"	6"	9-5/8"
1-3/4"	8"	12-7/8"
3"	1-1/2"	3"
3"	4"	6-1/2"
3"	5"	8-1/16"
3"	6"	9-5/8"
3"	8"	12-7/8"
3"	16"	18"
1-3/4"	10"	10"
3"	10"	10"
4-3/4"	11"	36"
4-3/4"	16"	36"

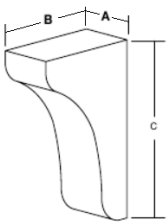

POSTS AND LEGS

2-Sided Taper

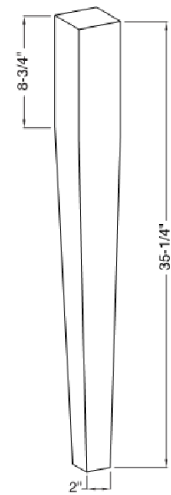

Bexley

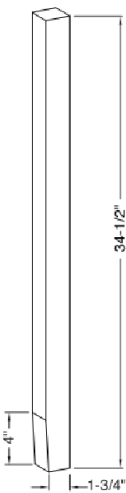

Dunkirk



Mission



FEET

Hobart

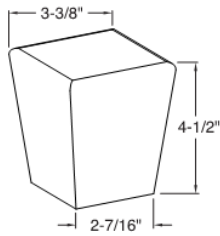

Corbett

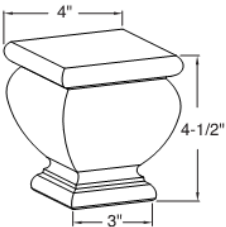

COLUMNS

Base End Column - Base

3" width (can be reduced to 1.5"-3" width)
24" depth; 34.5" height
Reversible

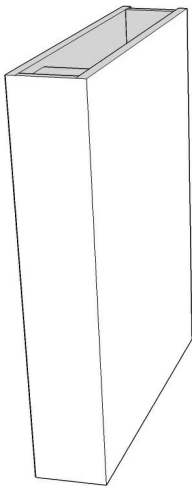

Wall End Column - Wall

3" width (can be reduced to 1.5"-3" width)
13" depth
24 - 60" height
Finished side and full finished return with
finished front face
Reversible

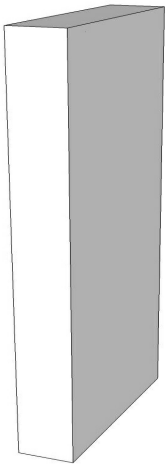

Tall End Column - Tall

3" width (can be reduced to 1.5"-3" width)
24" depth
96 - 120" height
Finished side and full finished return with
finished front face
Reversible

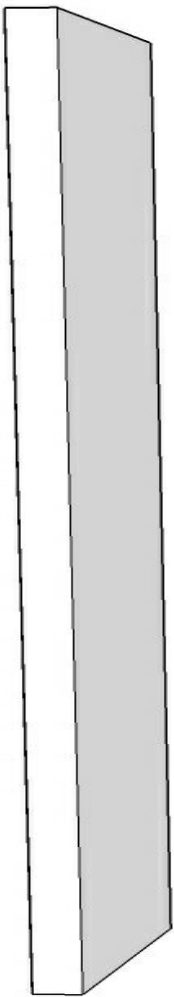

Island Base End Column - Island Base

3" width (can be reduced to 1.5"-3" width)
48" depth
34-1/2" height
Finished side and full finished returns with finished front
faces
Reversible
Deco Wainscot Panel may be added as a separate item

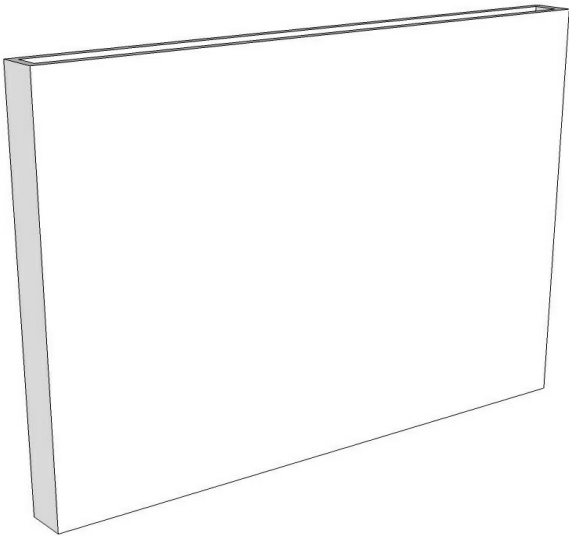

FUNCTIONAL AND MISCELLANEOUS

Rollouts

12 - 39" width (width = cabinet size)

21" drawer depth

4" height

Scoop front detail

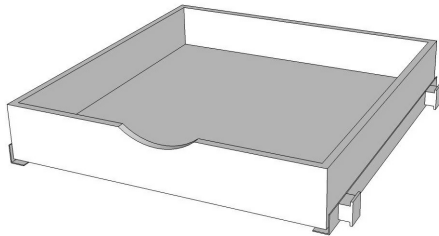

Cabinets fitted with rollouts feature
Adjustable Standards for maximum
storage efficiency and flexibility



Wine Rack Cabinet

Finished interior

1" width front framing applied

24w x 18h

30w x 18h

36w x 18h

24w x 24h

30w x 24h

36w x 24h

18w x 30h

24w x 30h

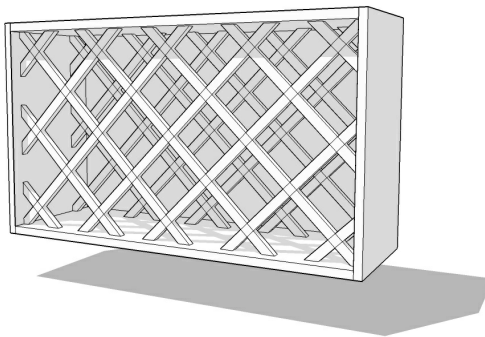

Appliance Garage -

App Gar C45

All door styles

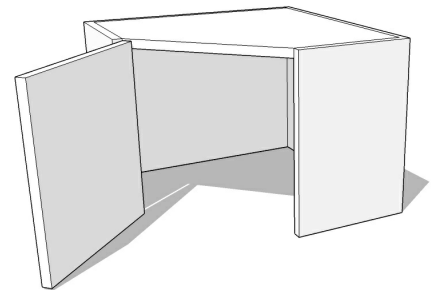

Partitions - Fixed

Horizontal

Vertical

Tray Divider

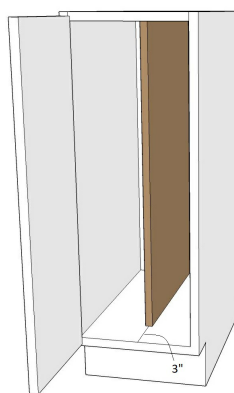
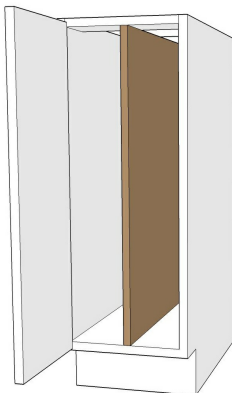
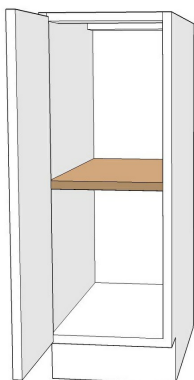

Hood Vent Pipe Chase - Hood Chase IN, Hood Chase FIN

Exterior - Hood Chase FIN

15, 24" width

12" depth

12, 18, 24, 48" height

Interior - Hood Chase IN

15" width

12" depth

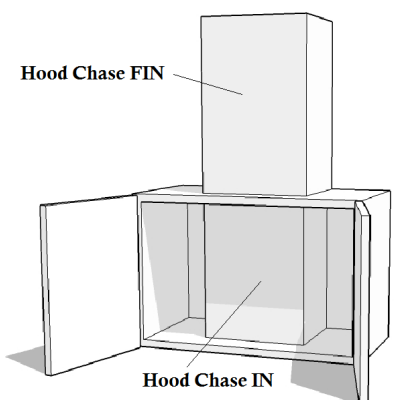
15, 18, 24, 27" height
(cabinet height)

FUNCTIONAL AND MISCELLANEOUS

Stemware Holder

- 30" (7 slots) or 36" (8 slots) width.
- Spacing between slats
30" stemware holder – 1-1/8"
36" stemware holder – 1-3/8"
- Depth 11-1/4".
- Thickness 1-1/2".

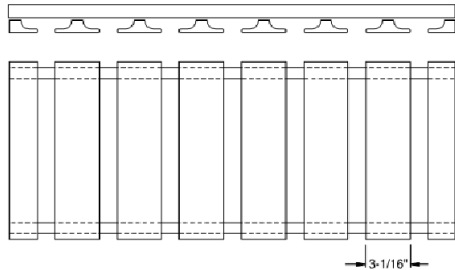

Docking Drawer Outlet



Floating Shelf

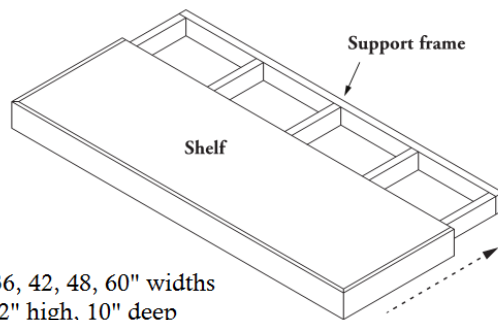

30, 36, 42, 48, 60" widths
2-1/2" high, 10" deep

Add Aventos Lift

HK-S Pivoting

Up to 39w x 15h door

HK - Pivoting

Up to 42w x 20h door



HL - Vertical Lift

Up to 42w x 20h door



Mirror Frames

2-3/4" wide framing to match door profile

24 - 72" width

30 - 72" height

Please select Type D (rabbeted frame with clear stop) or Type F (square inside frame; no rabbet)

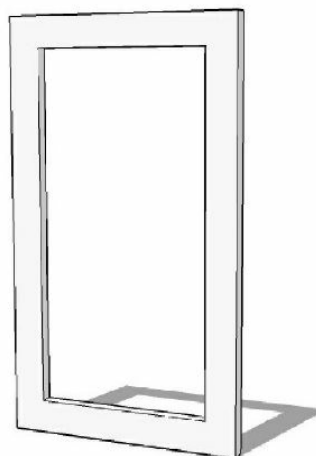

HF - Bi-folding

Up to 42w x 42h (total height combined)



OPTIONS

Drawer Front Options

Matching 5-piece



Slab (matching edge)



Glass Lites

Standard Lite

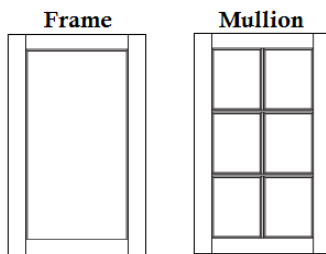

Special Lite - by quote only

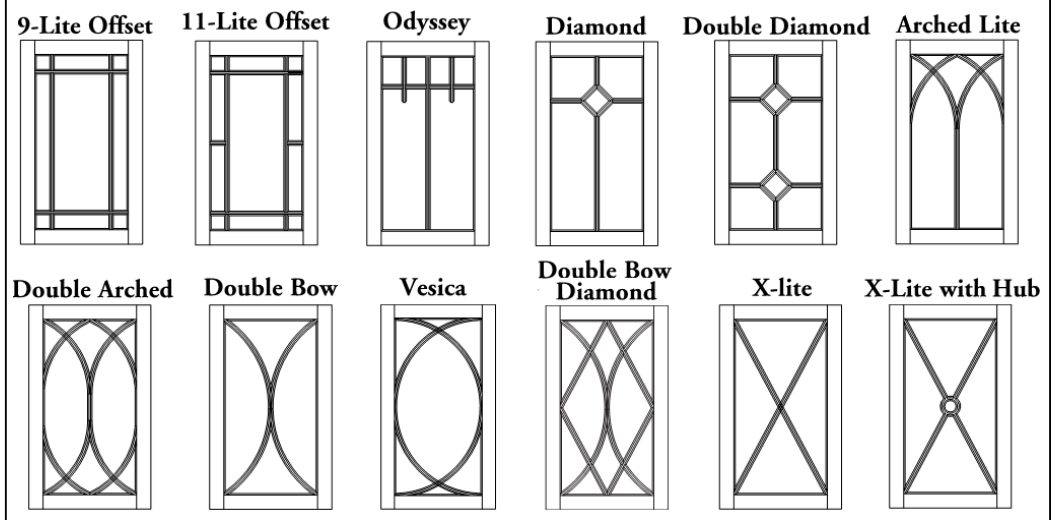

Optional Profiles

Outside Edge Profiles

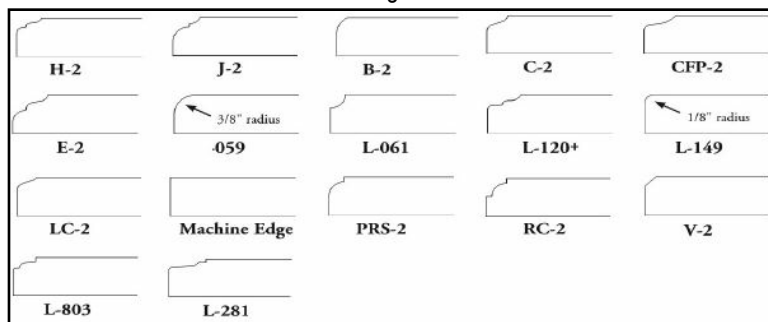

Panel Profiles

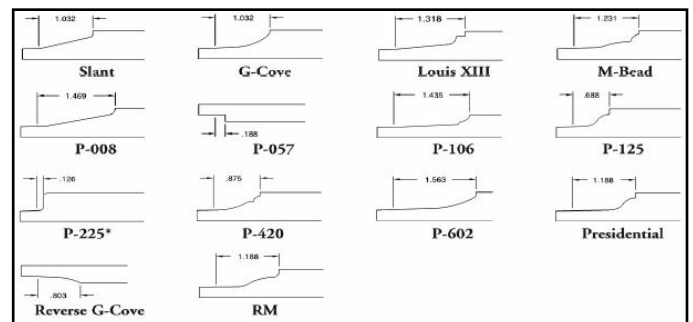

Inside Framing Profiles

